

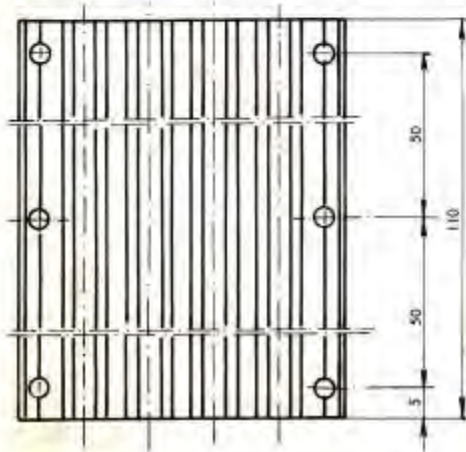

# ELECTROLUX MACEDONIA

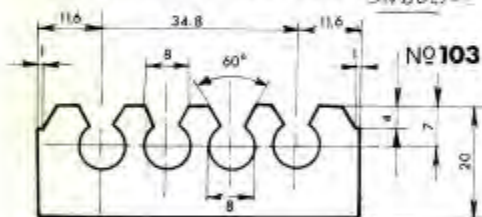
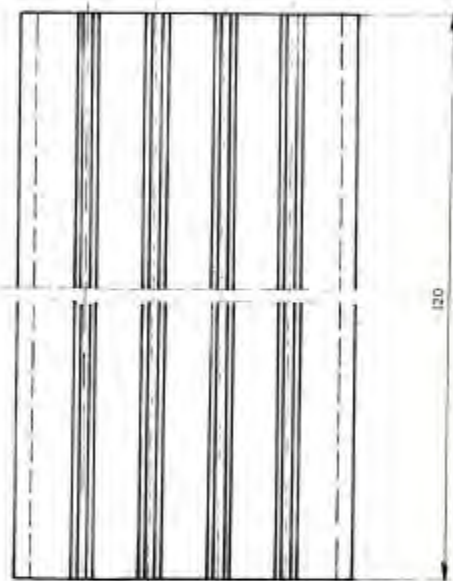
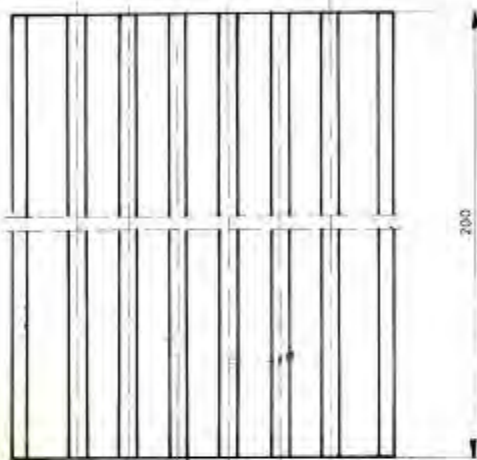
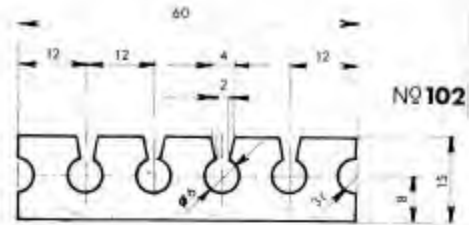
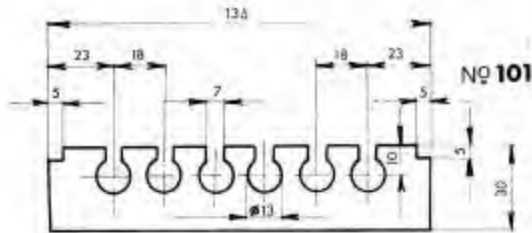

NOSAČI GREJAČA GRUPA PNG, IZRA-  
DENI SU OD MATERIJALA CERTERM 2.

HEIZKÖRPERHALTER GRUPPE PNG  
AUSGEFERTIGT AUS MATERIAL  
CERTERM 2.

SUPPORTERS FOR HEATING ELEMENTS  
GROUP PNG MADE FROM CERTERM 2  
MATERIAL.



# ELECTROLUX MACEDONIA

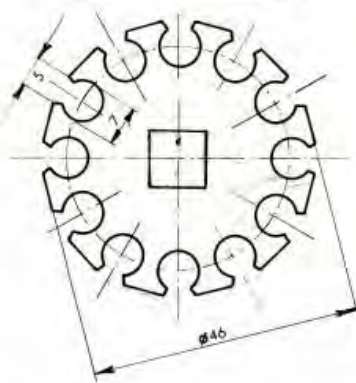
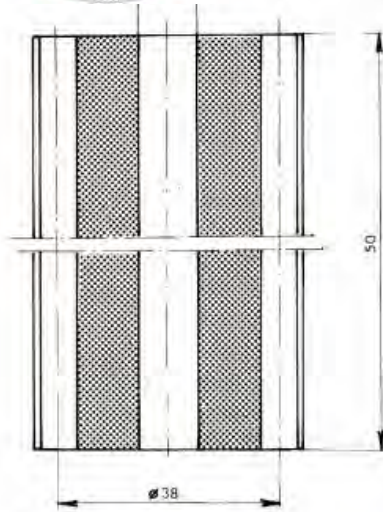

**№104**

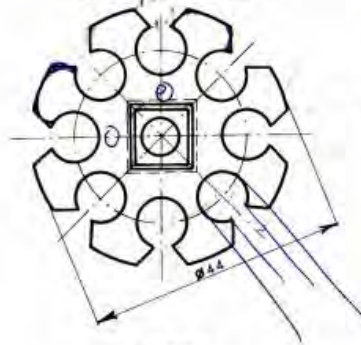
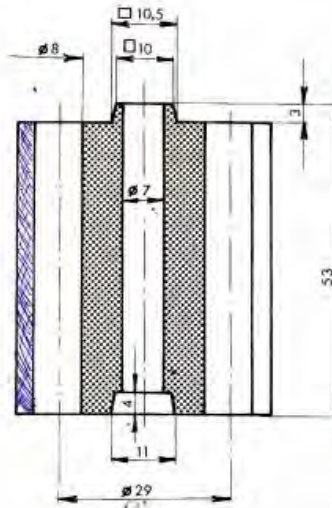

**№105**

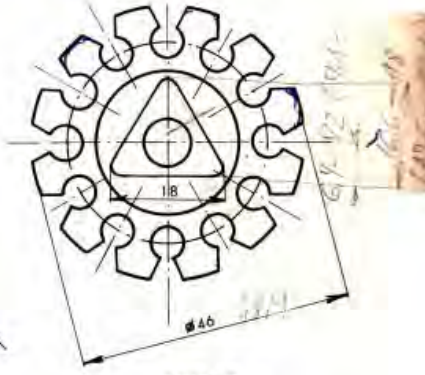
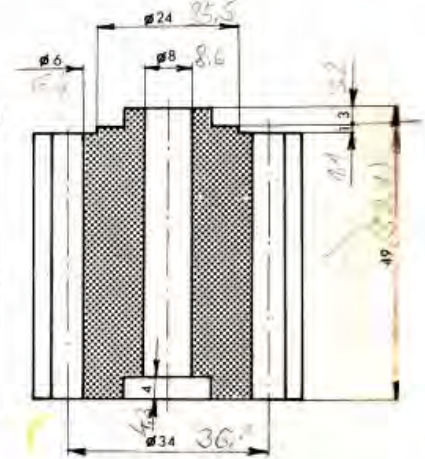

**№106**

NOSAČI GREJAČA GRUPA VNG IZRAĐENI SU OD MATERIJALA CERTERM 2.

HEIZKÖRPERHALTER GRUPPE VNG AUSGEFERTIGT AUS MATERIAL CERTERM 2.

SUPPORTERS FOR HEATING ELEMENTS, GROUP VNG ARE MADE FROM CERTERM 2 MATERIAL.



# ELECTROLUX MACEDONIA

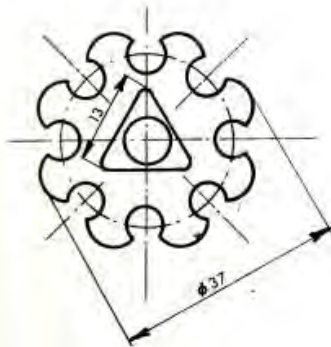
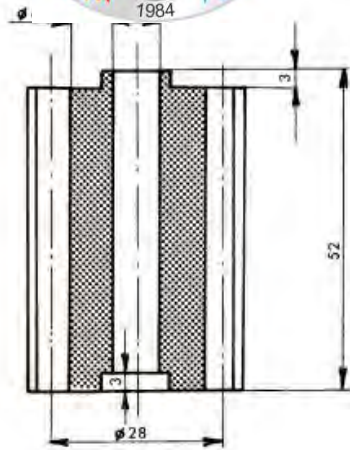

**№107**

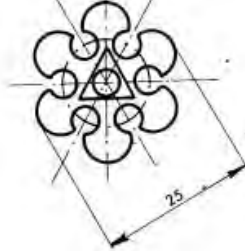
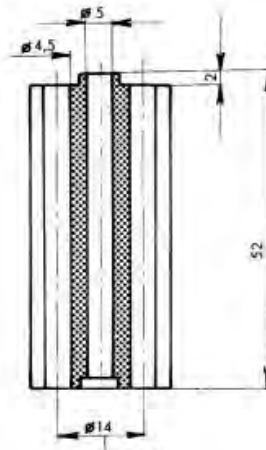

**№108**

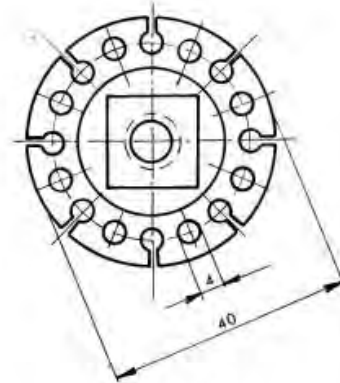
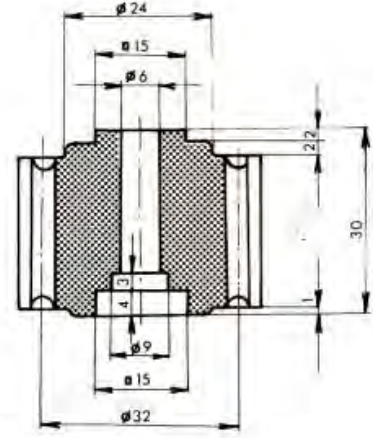

**№109**

*TPA-10*

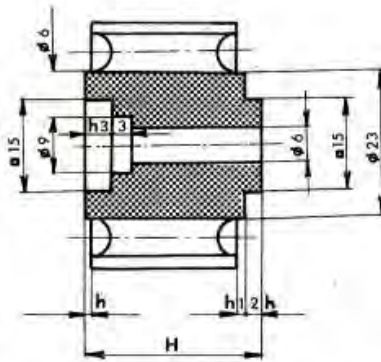
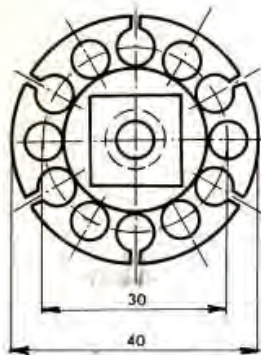

**№111**

*TPA-10*

NOSAČI GREJAČA GRUPA VNG IZRAĐENI SU OD MATERIJALA CERTERM 2.

HEIZKÖRPERHALTER GRUPPE VNG AUSGEFERTIGT AUS MATERIAL CERTERM 2.

SUPPORTERS FOR HEATING ELEMENTS, GROUP VNG ARE MADE FROM CERTERM 2 MATERIAL.





# ELECTROLUX MACEDONIA

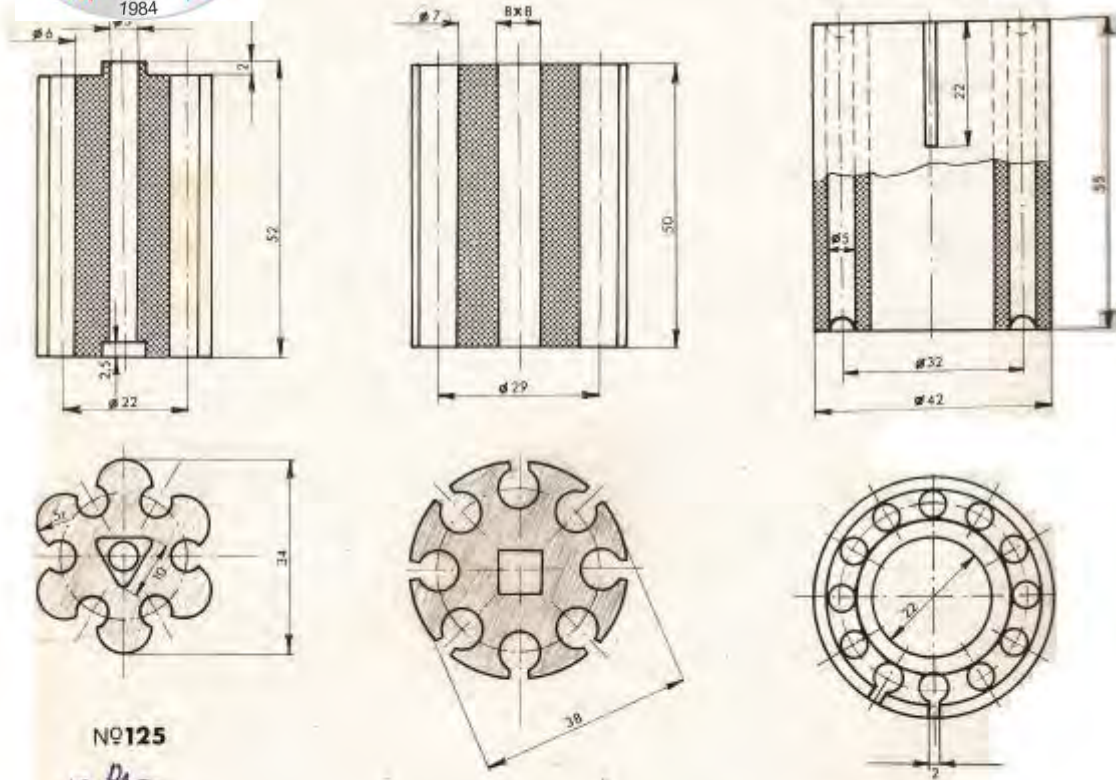

№125

№127

№128



№1200

*ГРЕЈАЧЕ ЗА ПОПРЕК УВ*      ИСТУКЕРУМАЊЕ

		D <sub>1</sub>	D <sub>2</sub>	D <sub>3</sub>	H	h	α
UV	№1201	20			10		
UV	№1202	20			8		
UV	№1203	18			10		
UV	№1204	19			10		
UV	№1205	11			10		
UV	№1206						
UV	№1207						

NOSAČI GREJAČA GRUPA VNG IZRAĐENI SU OD MATERIJALA CERTERM 2.

*MRN-10*

HEIZKÖRPERHALTER GRUPPE VNG AUSGEFERTIGT AUS MATERIAL CERTERM 2.

*MR-6*

SUPPORTERS FOR HEATING ELEMENTS, GROUP VNG ARE MADE FROM CERTERM 2 MATERIAL.



# ELECTROLUX MACEDONIA

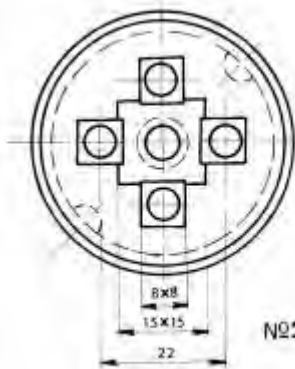

**№203**



*TPA-10*

POČETNE I ZAVRŠNE GLAVE GRUPE PZG IZRAĐENE SU OD MATERIJALA CERTERM I.

ANFANGS - UND ENDKÖPFE GRUPPE PZG, AUSGEFERTIGT AUS MATERIAL CERTHERM I.

COMMENCING AND FINISHING HEADS GROUP PZG ARE MADE FROM CERTERM I MATERIAL.

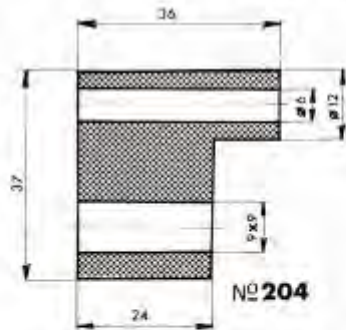
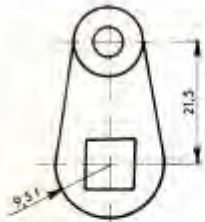

**№204**

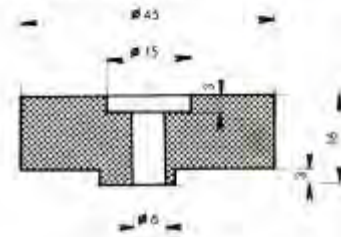

**№205**

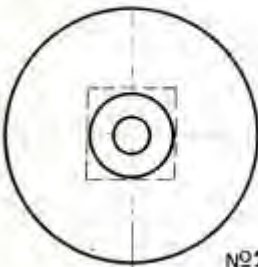
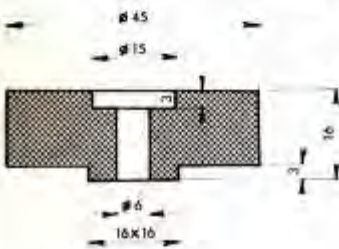

**№206**

*TPA-10*

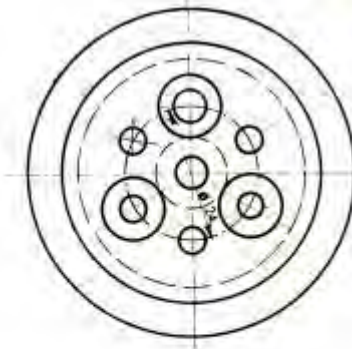

**№207**

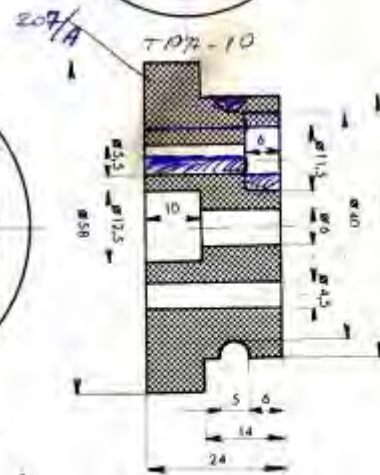

*207/A TPA-10*







# ELECTROLUX MACEDONIA

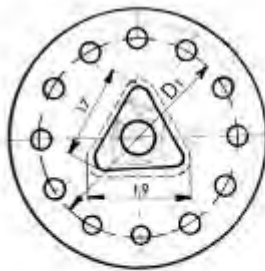

7PR-10

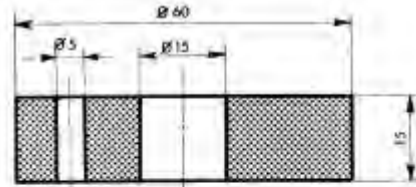

№ 306

PZG	D	D <sub>1</sub>	H	h	h <sub>1</sub>
306	45	34	12	35	3
307	46	35	14	5	4

*39 or 47*  
*40.5 or 8*

POČETNE I ZAVRŠNE GLAVE GRUPE PZG IZRAĐENE SU OD MATERIJALA CERTERM 1.

ANFANGS – UND ENDKÖPFE GRUPPE PZG, AUSGEFERTIGT AUS MATERIAL CERTERM 1.

COMMENCING AND FINISHING HEADS GROUP PZG ARE MADE FROM CERTERM 1 MATERIAL.

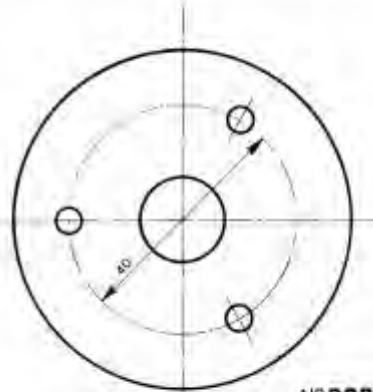

№ 308

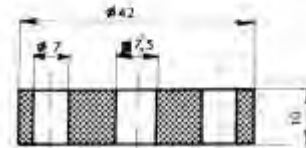
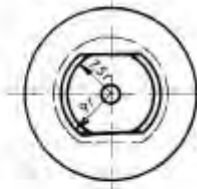

№ 615

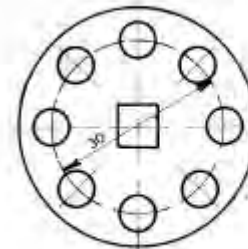

№ 309



# ELECTROLUX MACEDONIA

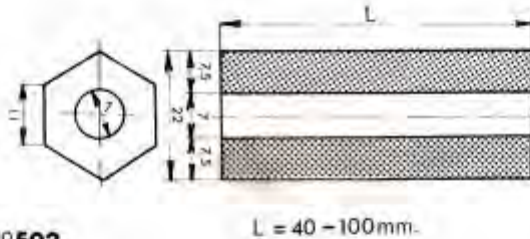
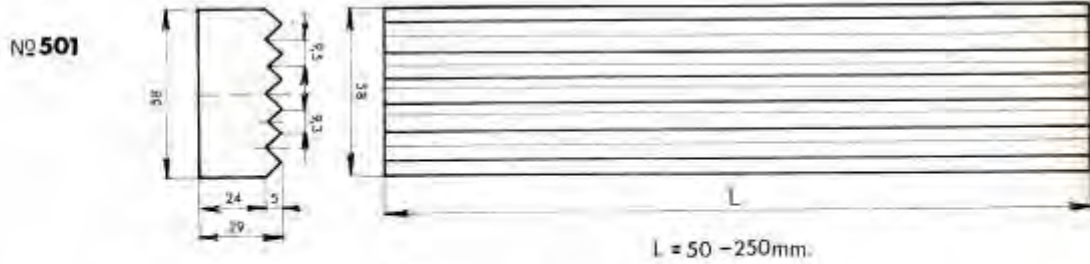

ISTISKUJUĆI DELOVI GRUPA ID, IZRADENI SU OD MATERIJALA CERTERM 1, I CERTERM 2.

AUSDRÜCKENDE TEILE GRUPE ID, AUSGEFERTIGT AUS MATERIAL CERTERM 1 UND CERTERM 2.

SPECIAL SHAPED PARTS FOR PROTRUDING, GROUP ID ARE MADE FROM CERTERM 1 AND CERTERM 2 MATERIALS.

ID	d	d <sub>1</sub>	d <sub>2</sub>	L
503	5.8	2.6	2	max 100
504	10	4.5	3	max 150

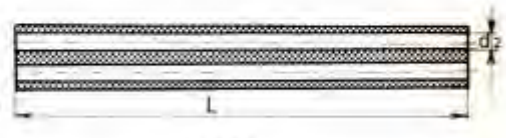
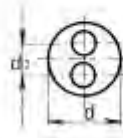

**№503**

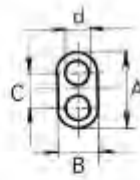
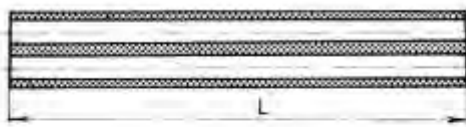

ID	A	B	C	d	L
505	7	3.5	3.5	2	max 100
506	9	4	4	1.5	max 150

**№505**

ID	d	d <sub>1</sub>	d <sub>2</sub>	L
507	8.5	3.5	2.5	max 150
508	12	4.5	3.5	max 200

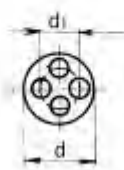

**№507**





# ELECTROLUX MACEDONIA

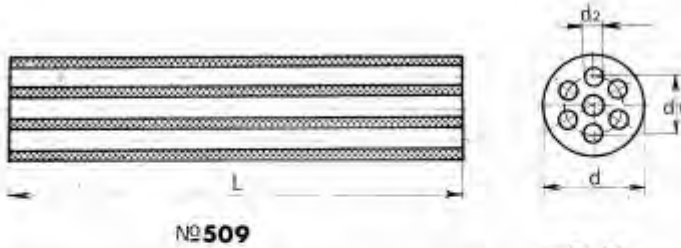

ID	d	d <sub>1</sub>	d <sub>2</sub>	L
509	11,5	6,7	2 <sup>+0,3</sup>	max 100
510	14	8	3	max 200
511	17,5	10	4	max 300



ID	d	d <sub>1</sub>	d <sub>2</sub>	d <sub>3</sub>	L
513	20,7	13,8	4,5	6,5	max 200
514	23	16,5	4,5	8,5	max 300

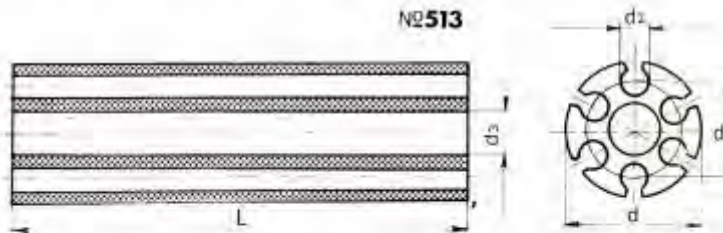

ISTISKUJUĆI DELOVI GRUPA ID, IZRADENI SU OD MATERIJALA CERTERM 1, I CERTERM 2.

AUSDRÜCKENDE TEILE GRUPE ID, AUSGEFERTIGT AUS MATERIAL CERTHERM 1 UND CERTHERM 2.

SPECIAL SHAPED PARTS FOR PROTRUDING, GROUP ID ARE MADE FROM CERTERM 1 AND CERTERM 2 MATERIALS.

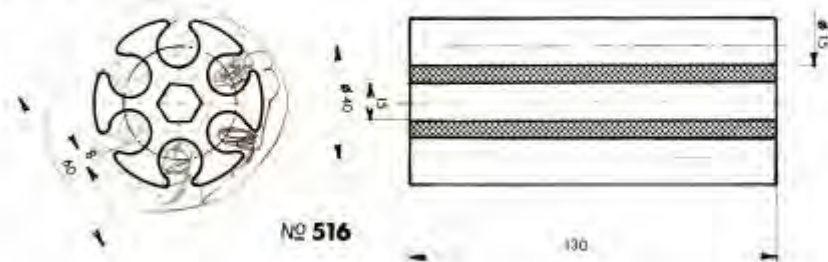
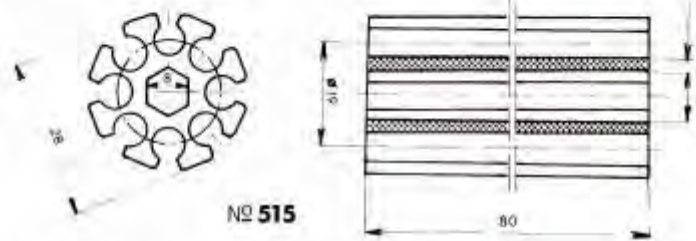



# ELECTROLUX MACEDONIA

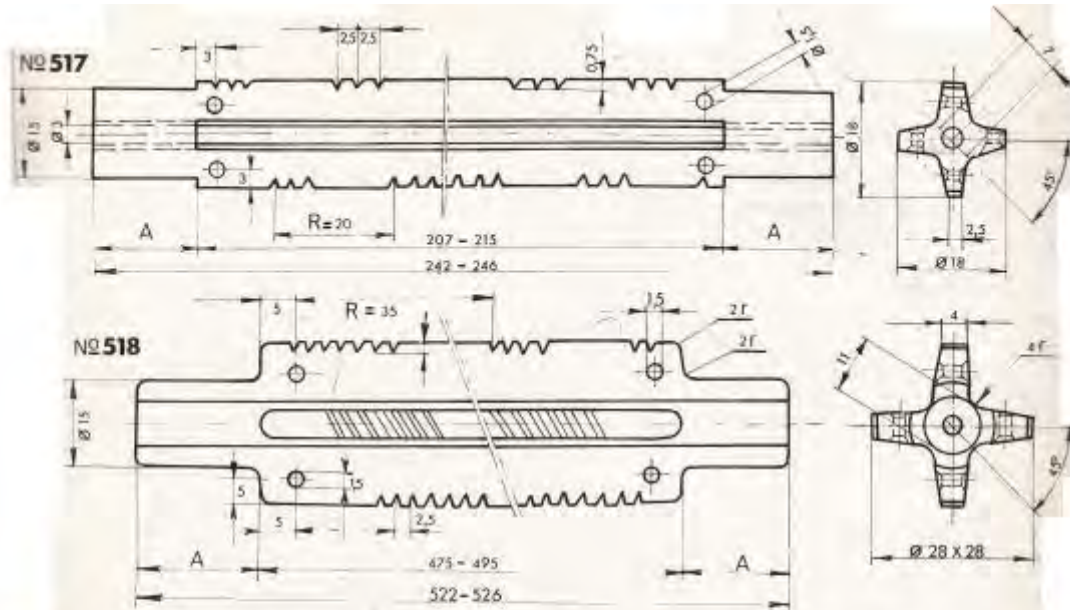

NOSAČI SREBRNE ŽICE GRUPA NAG HALTER DER SILBERNEN DRAHT HOLDERS OF SILVER WIRE GROUP  
 IZRADENI SU OD MATERIJALA GRUPPE NAG, AUSGEFERTIGT AUS NAG ARE MADE FROM CERTERM 1,  
 CERTERM 1. MATERIAL CERTERM 1.

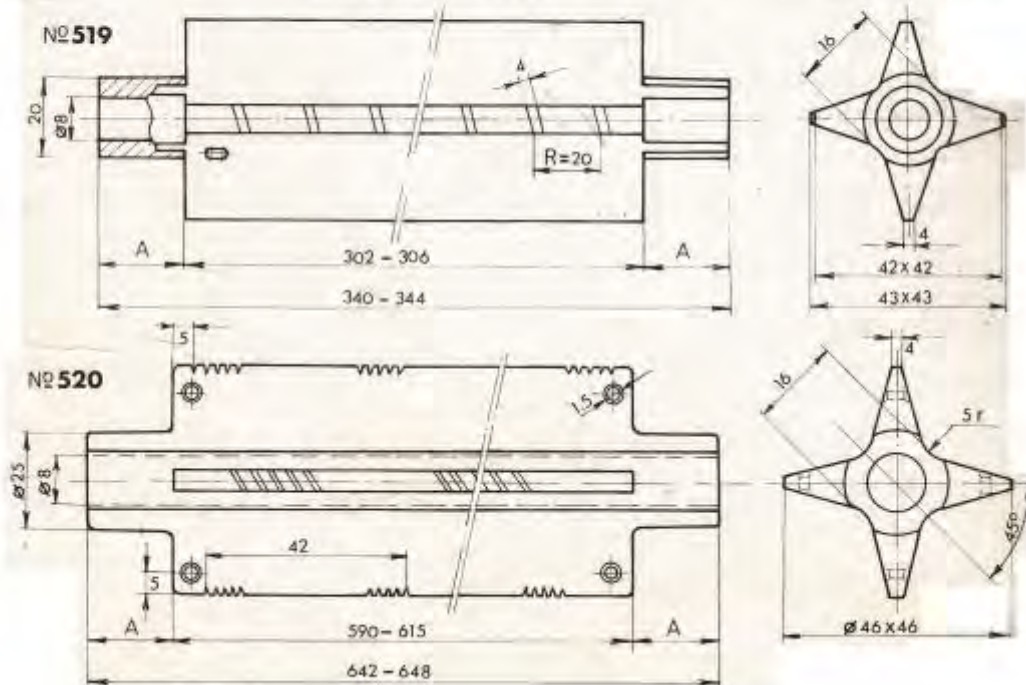



# ELECTROLUX MACEDONIA

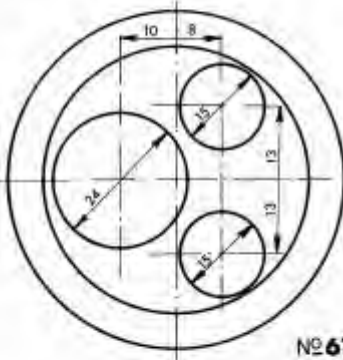
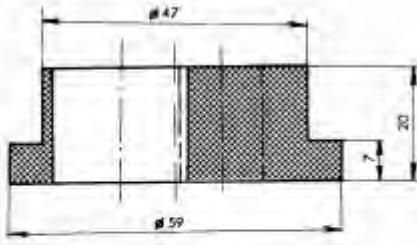

№613

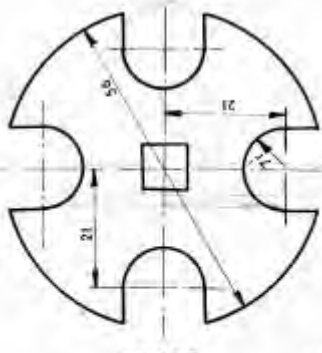
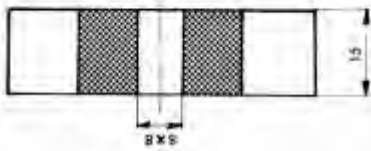

№902

№904

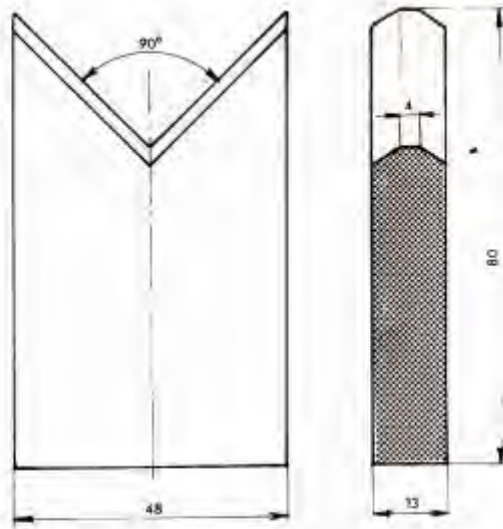

№901

SPECIJALNI NOSAČI GREJAČA GRUPA  
NGS

SPEZIELLE HEIZKÖRPERHALTER  
GRUPPE NGS.

SPECIAL SUPPORTERS OF HEATING  
ELEMENTS GROUP NGS.

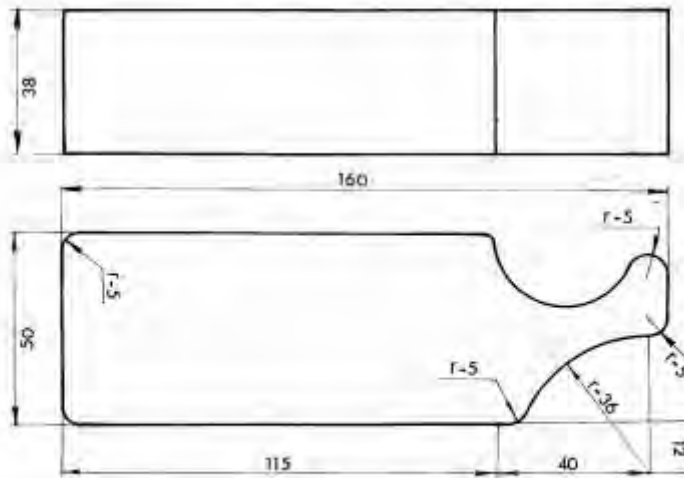





# ELECTROLUX MACEDONIA

№905

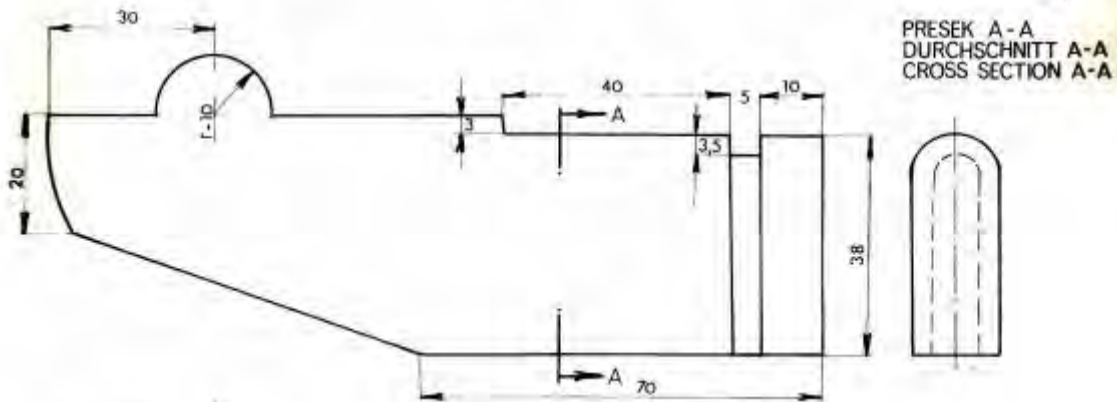
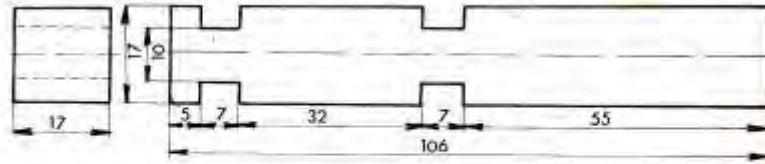

№906

ПОУЧНА ЕР ЗАКОДА

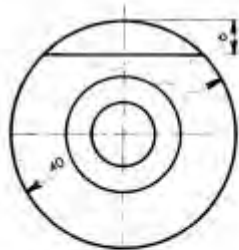

№920



SPECIJALNI NOSAČI GREJAČA  
GRUPA NGS

SPEZIELLE HEIZKÖRPERHALTER  
GRUPPE NGS

SPECIAL SUPPORTERS OF HEATING  
ELEMENTS GROUP NGS



# ELECTROLUX MACEDONIA

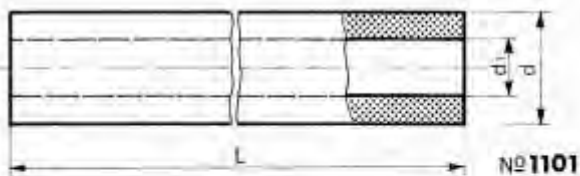

d					d <sub>1</sub>				
5,5	21,5	31	45	95	3,5	13,5	25	38	75
12	22	32	47	100	5	14	26	40	80
14	23	33	50		5,5	15	28	48	
15	24	34	60		7	15,5	29	50	
16	25	35	65		8	16	30	53	
16,5	26	37	70		8,5	18	31	55	
17	27	39	78		9	20	34	60	
18,5	28	40	85		10	21	35	65	
20	30	42	90		12	24	36	68	

RAZNI TIPOVI CEVI GRUPA RC IZRADENI SU OD MATERIJALA CERTERM 2 I CERSTE A P.

VERSCHIEDENE ROHRTYPEN GRUPPE RC – AUSGEFERTIGT AUS MATERIAL CERTHERM 2. UND CERSTE A P.

DIFFERENT TYPES OF PIPES GROUP RC ARE MADE FROM CERTERM 2 AND CERSTE A P MATERIALS.

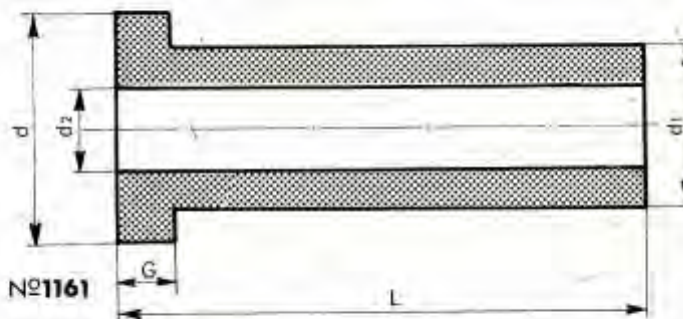
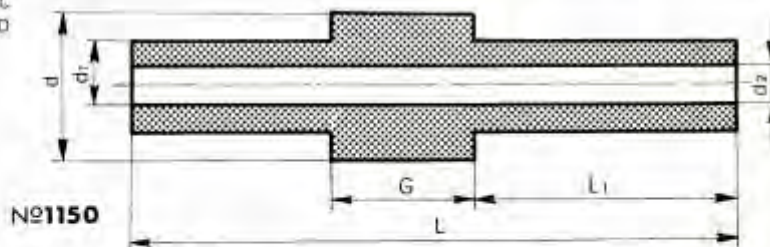

RC	d	d <sub>1</sub>	d <sub>2</sub>	L	L <sub>1</sub>	G
1150	62	50	34	44	17	10
1151	45	36	21	42	17	10
1152	33	24	14	35	12	9
1161	35	25	16	320		20
1162	35	25	16	420		20
1163	20	14	10	100		10
1171	35	18		170		10

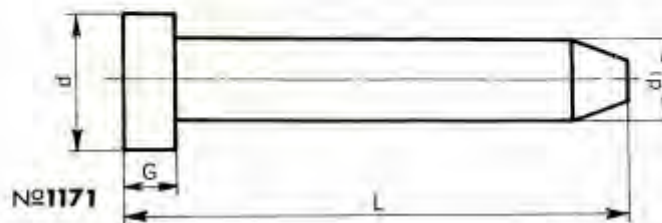



# ELECTROLUX MACEDONIA

IZOLACIONE PERLE GRUPA IP

ISOLIERPERLEN GRUPPE IP

INSULATING PEARLES GROUP JP

KOLENASTE-SAVITLJIVE

KNIEFÖRMIG - FLEXIBIL

ELBOW - FLEXIBLE



№7200

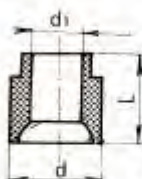

CILINDRIČNE - NESAVITLJIVE

ZYLINDRISCH - UNFLEXIBIL

CYLINDRICAL - UNFLEXIBLE

№7210

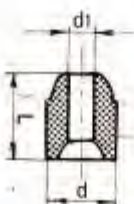

RADIJALNE - SAVITLJIVE

RADIAL - FLEXIBIL

RADIAL - FLEXIBLE

№7220

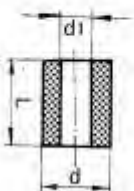

CILINDRIČNE PERLE

ZYLINDRISCHE PERLEN

CYLINDRICAL PEARLES

№7230

proizv. broj Herstellungs-Nr Product No	Spoljna mera d Aussen mass Overall dimensions	unut. mera d1 Innen mass Inside dimension	dužina L Länge Length	kom./kg Stück/kg Pcs./kgs	1 kgr. duž. met. 1 kgr. 1. met. 1 kg-meter	kom po metru Stück je Meter Pieces/meter
7200	6	2,6	6,2	2720	13,1	172
7201	6,5	3,5	7	2700	16,5	165
7202	8	4	8	1500	11,5	158
7203	9,5	4	9	950	10,5	144
7208	8	3,8	7,7	2380	13,5	170
7209/M	6,5	3,2	6,0	3640	18,2	208
7210	8	4	8	1200	11	132
7211	10,5	6	8	1010	11	132
7220	5	2,5	5	6660	28	210
7221	6,5	4	7,5	2000	21	133
7222	6,6	3	7	3100	17,6	160
7223	8	5	7	2760	15,7	160
7224	12,5	7	10	530	5	105
7230	6	2	5	6200	28,5	200
7231	6,2	3,6	6,3	2500	24,5	100
7232	7,5	3,8	5	2500	21,5	200
7233	6,2	4,3	6	4175	25	166
7234	6,8	5	10	2500	24,8	100
7235	8	6	10	2000	19	100





# ELECTROLUX MACEDONIA

SPECIJALNE PERLE

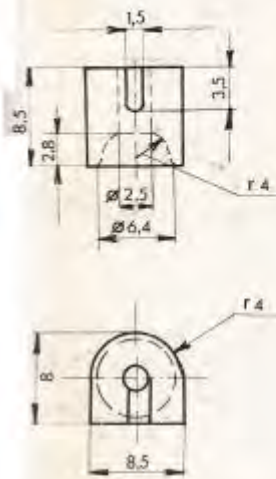

№7250

SPEZIELLEN PERLEN

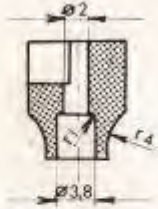

SPECIAL PEARLES

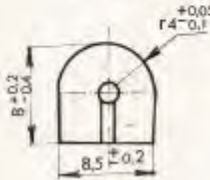
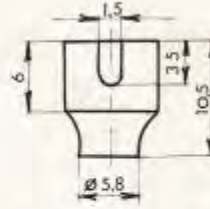

№7251

IZRADENI SU OD MATERIJALA CERSTEA P.

AUSGEFERTIGT AUS MATERIAL CERSTEA P.

MADE FROM CERSTEA P.

RAZNI UMECI GRUPA RU

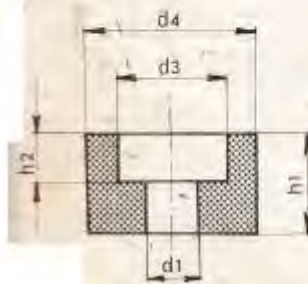

№7260

VERSCHIEDENE EINSÄTZE GRUPPE, RU

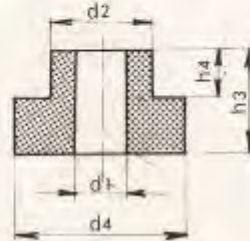

№7260/2

DIFFERENT, INSERTIONS GROUP RU

RU	d <sub>1</sub>	d <sub>2</sub>	d <sub>3</sub>	d <sub>4</sub>	h <sub>1</sub>	h <sub>2</sub>	h <sub>3</sub>	h <sub>4</sub>
7260	4,5		10	15	9	4,5		
7261	4,5	9		15			9	
7262	4,3		8	10	5	1,7		
7263	4,3	7		10			5	
7264	6,5		13,8	23	15	9		
7265	6,5	13		23			18,5	
7266	7		13	22	14	7		
7267	7	12		22				14

6038v

7268	11		21	30	10	5		
7269	11		21	30	8	4		

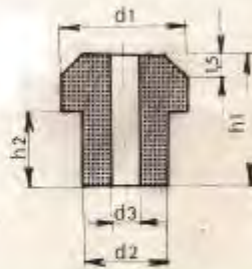

№7270

RU	d <sub>1</sub>	d <sub>2</sub>	d <sub>3</sub>	h <sub>1</sub>	h <sub>2</sub>
7270	11	7,5	2,5	10	7,5
7271	9	6	2	12	6

603A	22	30	20	11	18	10
604A	27	52	28	15	35	17



# ELECTROLUX MACEDONIA

OKRUGLI FILTRI GRUPA OF  
 RUNDFILTER GRUPPE OF.  
 ROUND FILTERS GROUP OF

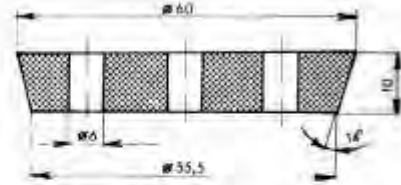
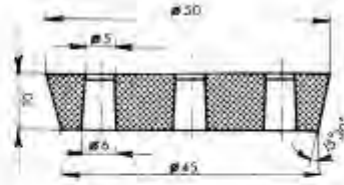

KF1-50

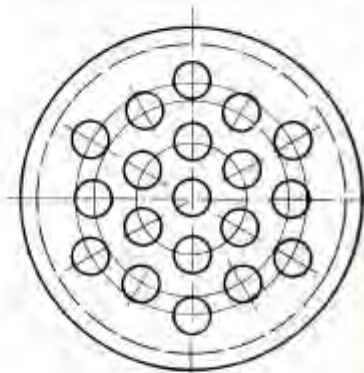
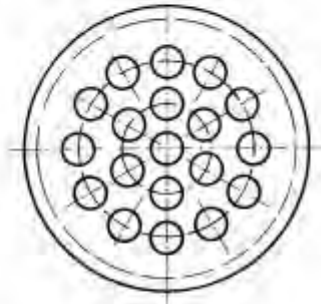

KF2-60

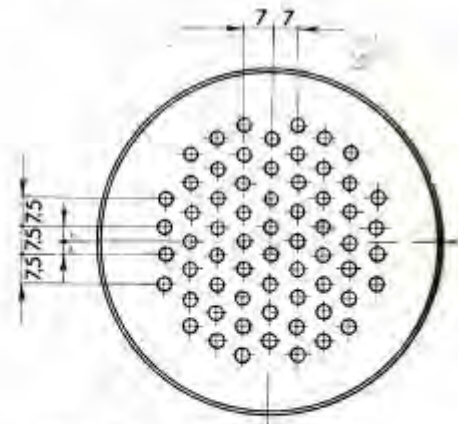
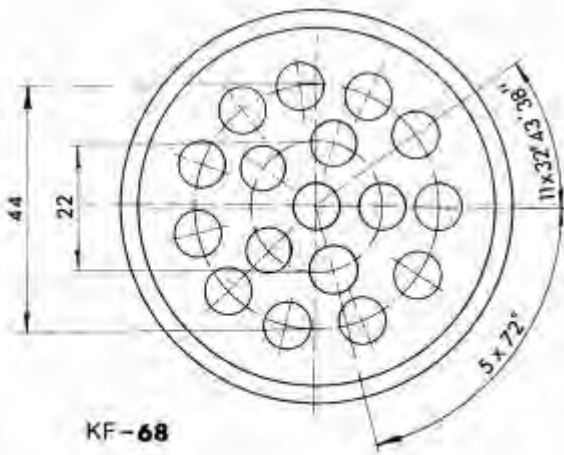
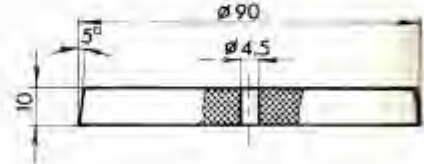
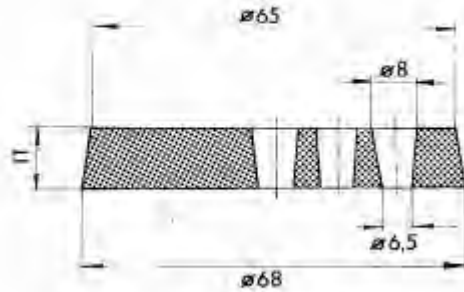

KF-68

KF1-90



# ELECTROLUX MACEDONIA

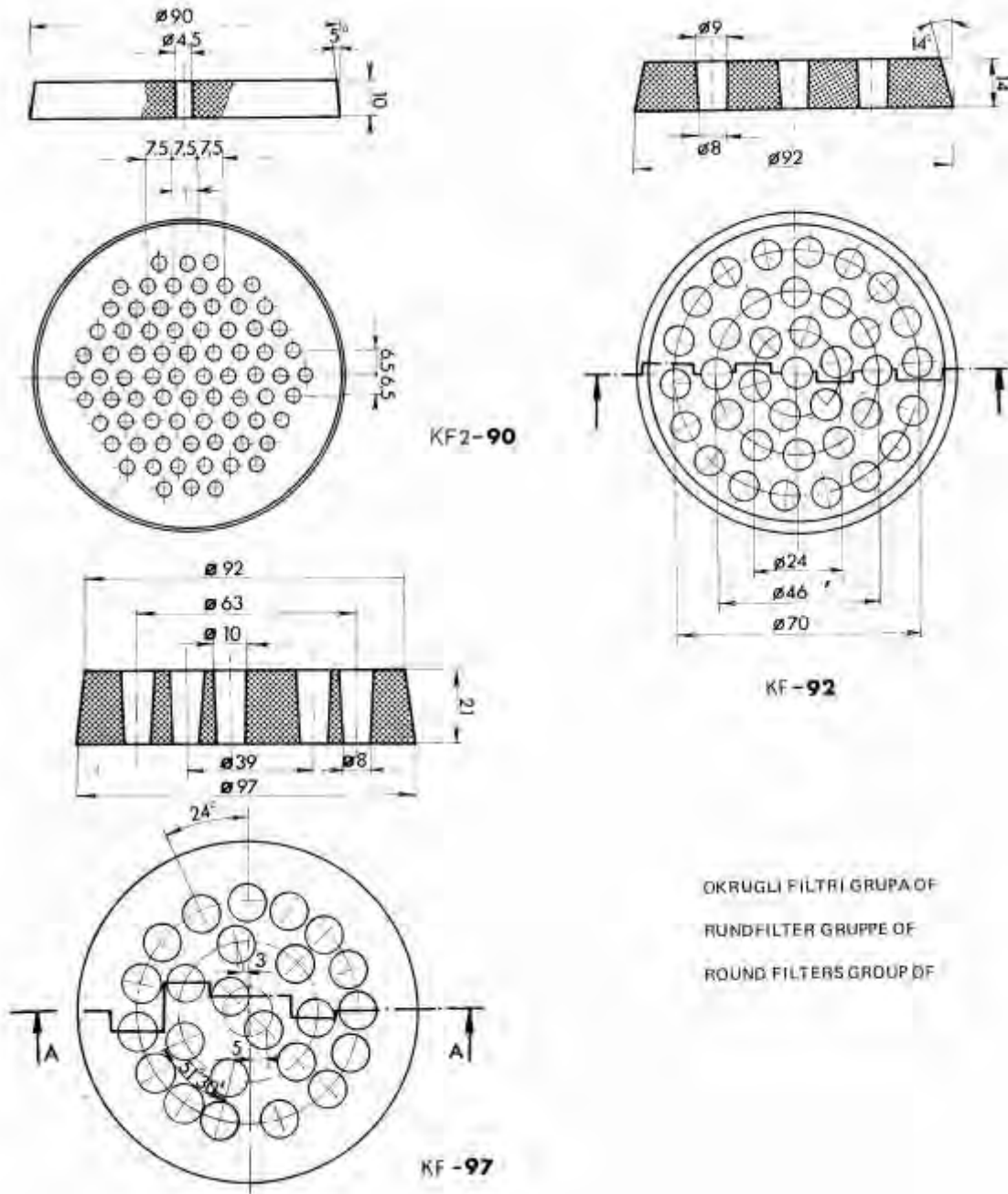

OKRUGLI FILTRI GRUPA OF  
 RUNDFILTER GRUPPE OF  
 ROUND FILTERS GROUP OF





# ELECTROLUX MACEDONIA

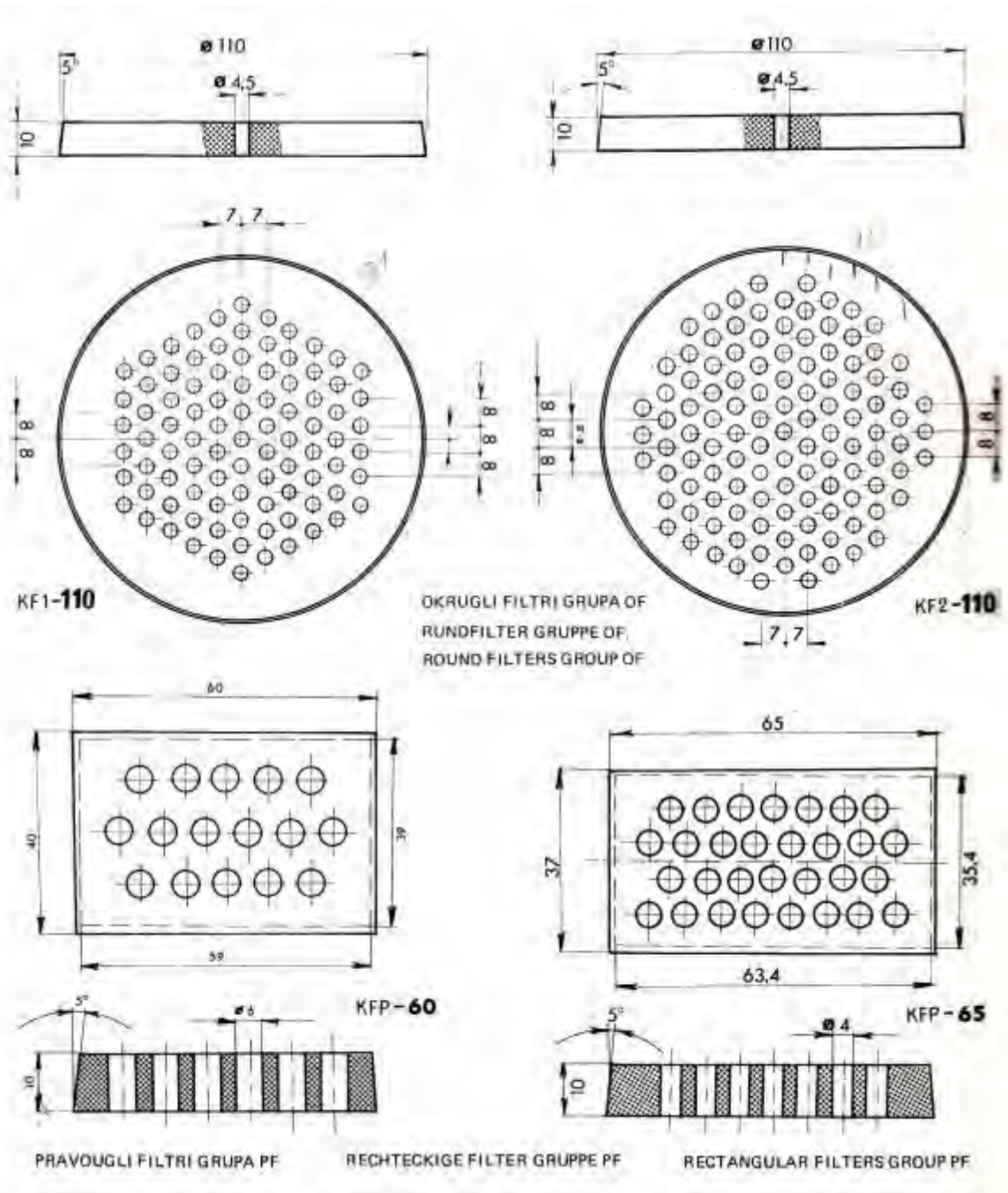



# ELECTROLUX MACEDONIA

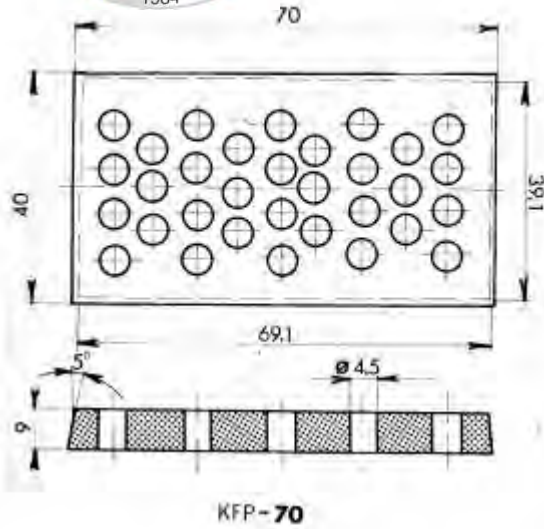

KFP-70

PRAVOUGLI FILTRI GRUPA PE  
 RECHTECKIGE FILTER GRUPPE PF  
 RECTANGULAR FILTERS GROUP PF

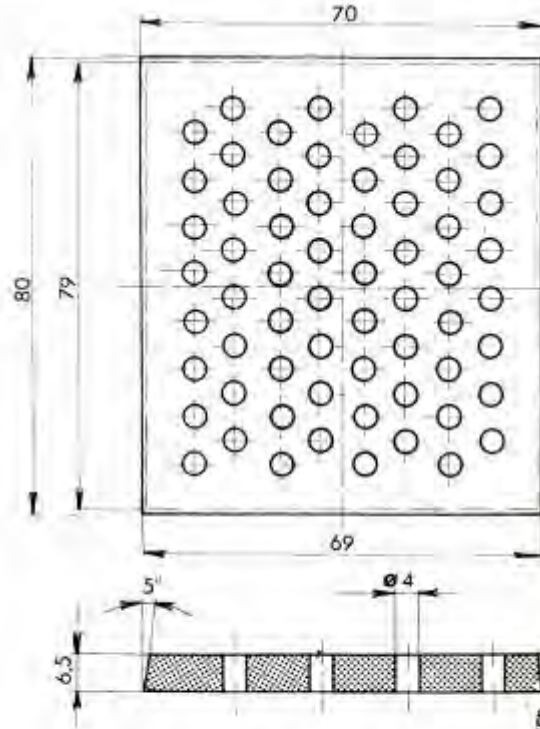

KFP-80

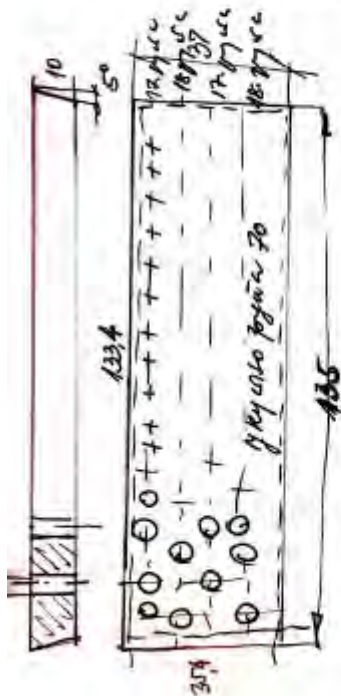

K.F.P. - 135 ogolap - STETNERU N. 02 CAS-87

OSIM OVIH VELIČINA I OBLIKA,  
 IZRAĐUJEMO I SVE OSTALE  
 VELIČINE I OBLIKE PO  
 ŽELJI KUPCA

AUSSER DIESEN MENGEN  
 UND FORMEN FERTIGEN  
 WIR AUCH DIE ANDEREN  
 NACH DEM WUNSCH DES  
 KUNDEN.

BESIDES THESE SIZES  
 AND SHAPES WE MAKE  
 OTHER SIZES AND SHAPES  
 ON ORDER OF BUYER.

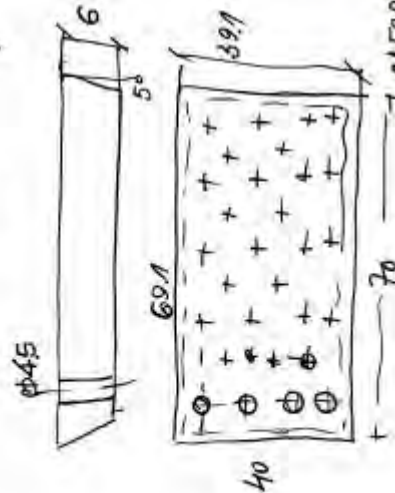

K.F.P. - 135 ogolap - STETNERU N. 02 CAS-87



# ELECTROLUX MACEDONIA

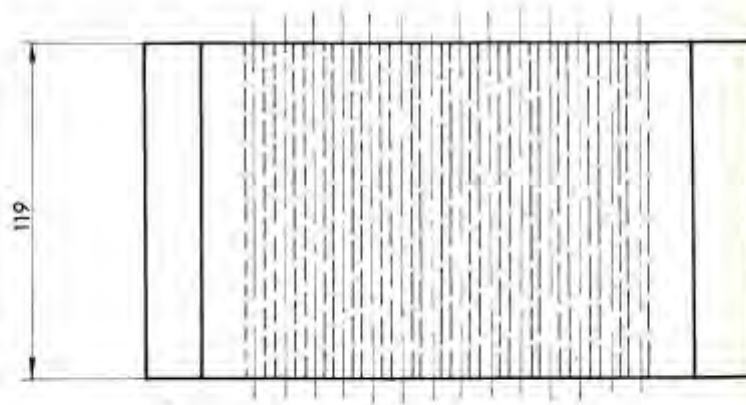
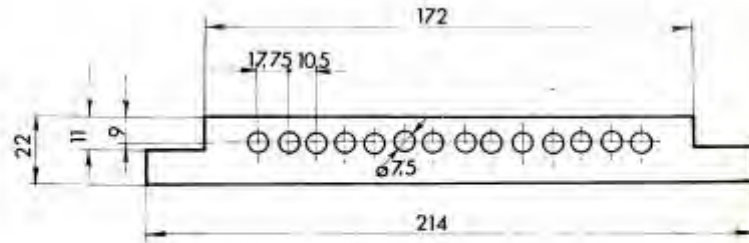

SO 2010

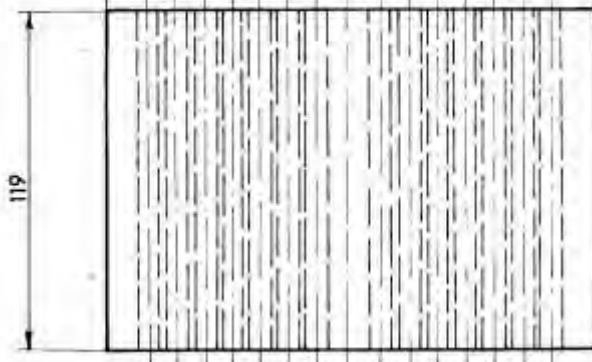
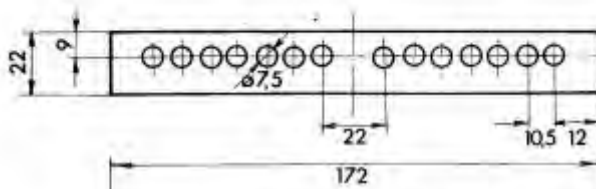

SO 2011

SPECIJALNI NOSAČ GREJAČA  
 SPEZIELLE HEIZKÖRPERHALTER  
 SPECIAL SUPPORTERS OF HEATING  
 ELEMENTS





# ELECTROLUX MACEDONIA

SPECIJALNI NOSAČ GREJAČA  
SPEZIELLE HEIZKÖRPERHALTER  
SPECIAL SUPPORTERS OF HEATING  
ELEMENTS

SO2018

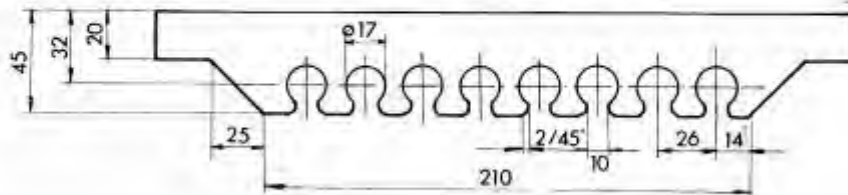
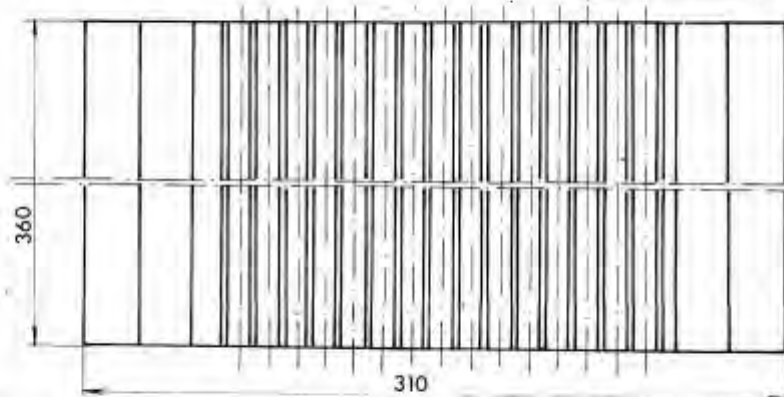
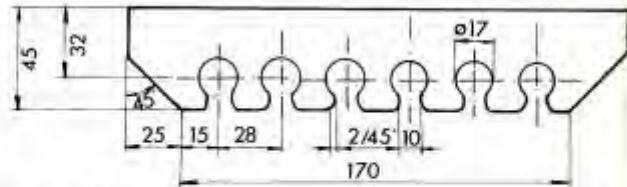
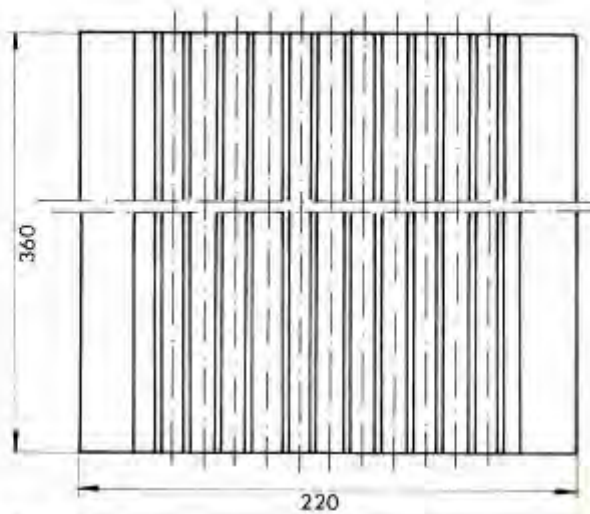

SO2019



# ELECTROLUX MACEDONIA

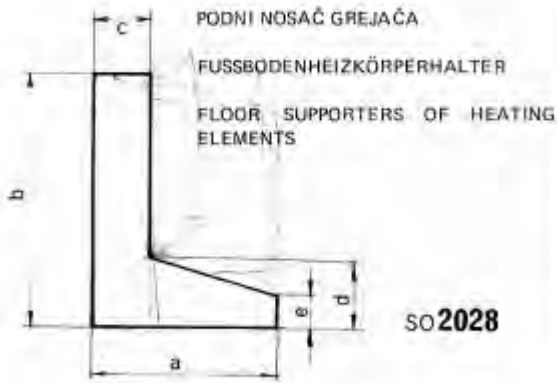

	a	b	c	d	e	L
SO 2028/I	40	65	15	20	12	120
SO 2028/II	55	85	18	22	12	150
SO 2028/III	65	90	20	24	12	200
SO 2028/IV	70	100	30	26	15	200
SO 2028/V	75	120	30	28	15	200

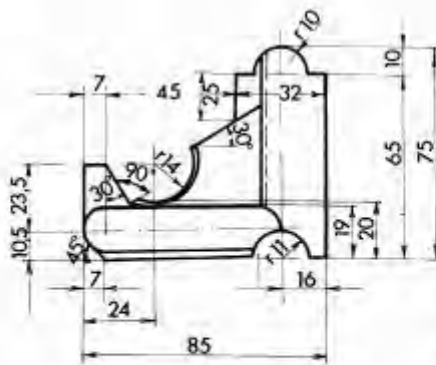
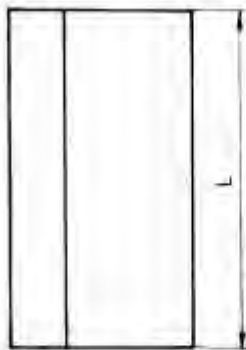

**SO 2029**

SPECIJALNI NOSAČ GREJAČA  
SPEZIELLE HEIZKÖRPERHALTER  
SPECIAL SUPPORTERS OF HEATING ELEMENTS

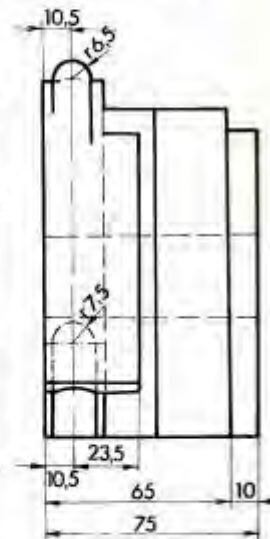
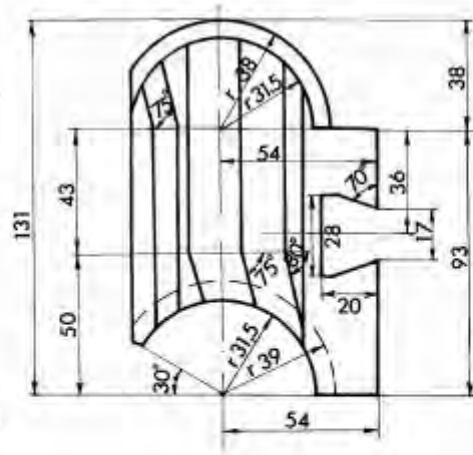



# ELECTROLUX MACEDONIA

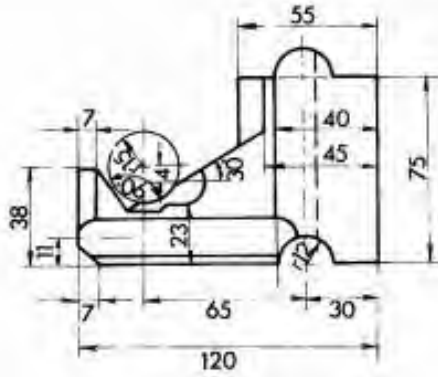

SPECIJALNI NOSAČ GREJA ČA

SPEZIELLE HEIZKÖRPERHALTER

SPECIAL SUPPORTERS OF HEATING ELEMENTS

SO2030

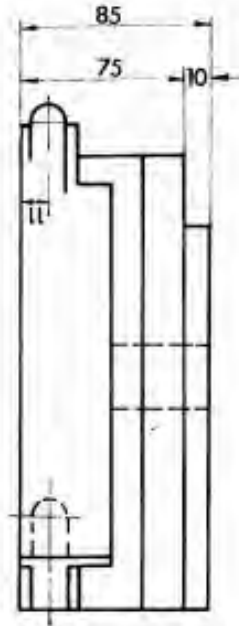
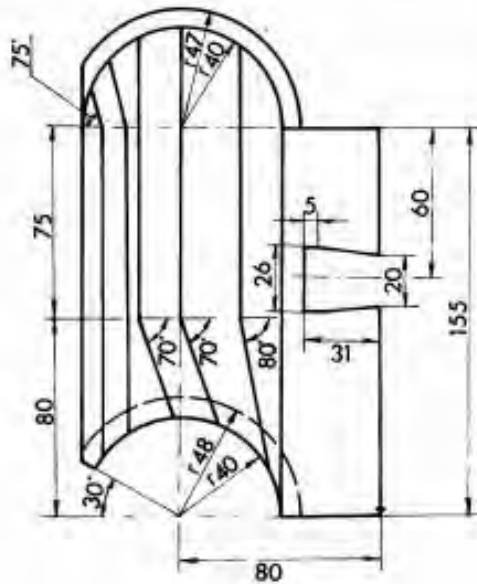





# ELECTROLUX MACEDONIA

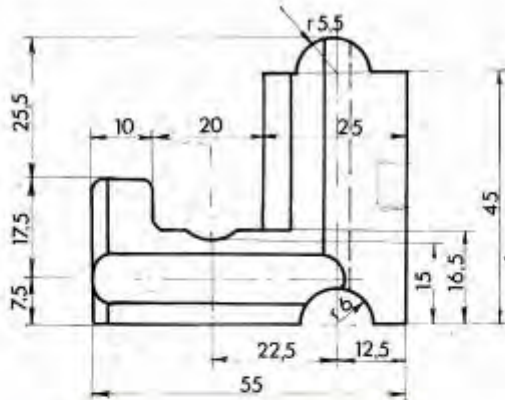

SPECIJALNI NOSAČ GREJAČA

SPEZIELLE HEIZKÖRPERHALTER

SPECIAL SUPPORTERS OF HEATING ELEMENTS

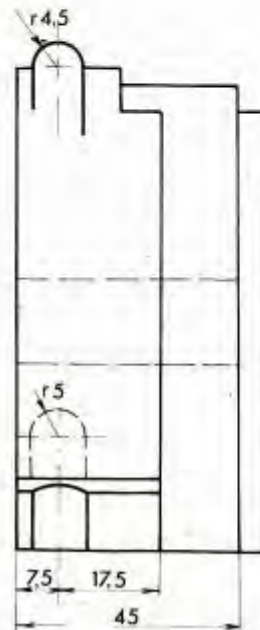
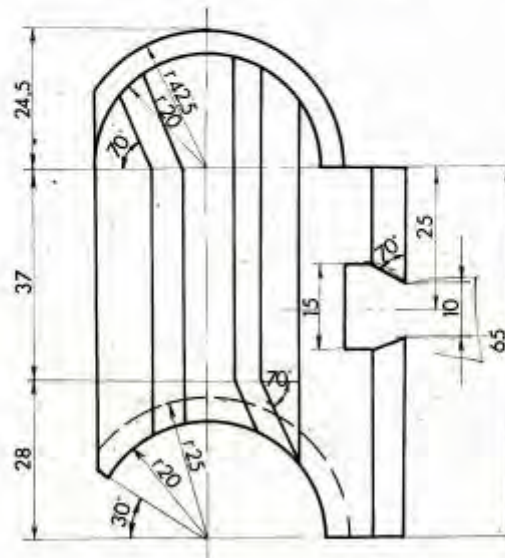

SO2030/I



# ELECTROLUX MACEDONIA

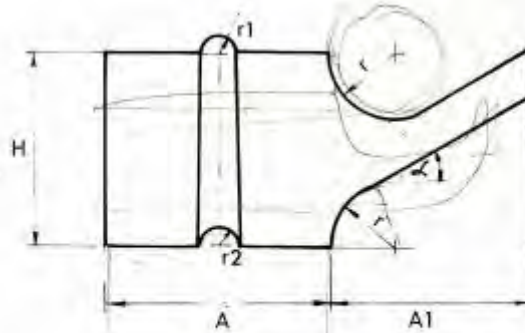

BOČNI NOSAČI GREJAČA  
 SEITENHEIZKÖRPERHALTER  
 LATERAL HEATER GIRDERS

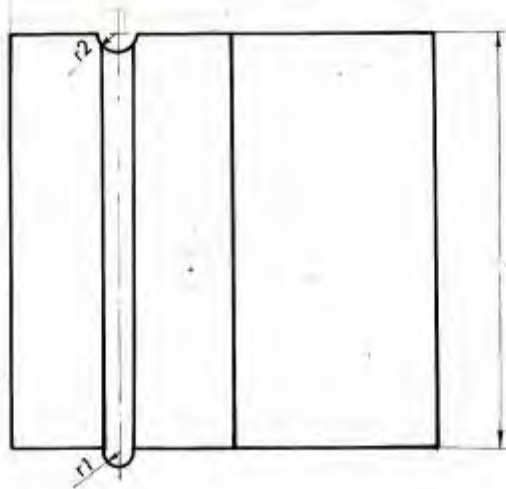

	H	A	A1	r	r1	r2	L	$\alpha$
SO 2033	34	40	35	11	3	3.5	74	30
SO 2034	42	50	36	12	5	6	104	30
SO 2035	54	45	45	16	7	8	150	30
SO 2036	60	50	54	18	8	9	150	30
SO 2037	70	50	58	20	8	9	200	30
SO 2041	44	40						



# ELECTROLUX MACEDONIA

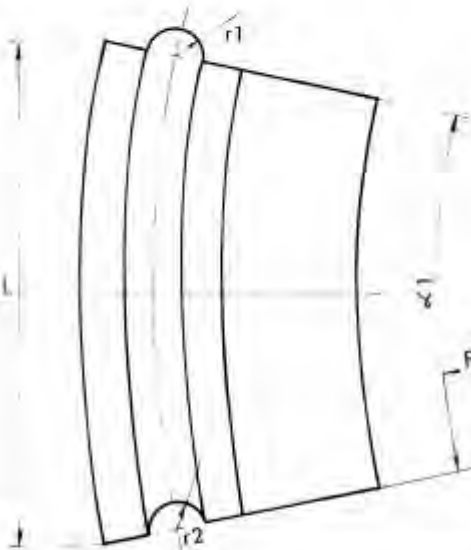
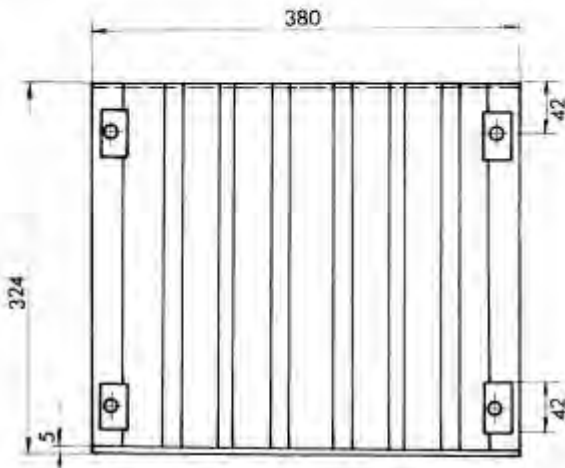
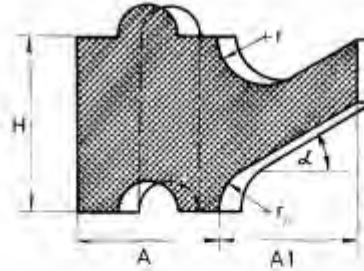
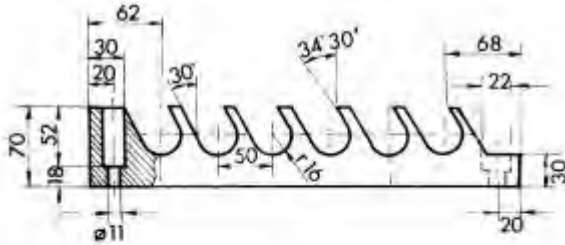

SO 2040

BOČNI NOSAČI GREJAČA  
SEITENHEIZKÖRPERHALTER  
LATERAL HEATER GIRDERS

RADIJALNI BOČNI NOSAČI  
RADIJAL — SEITENHEIZKÖRPERHALTER  
LATERAL RADIAL GIRDERS

	H	A	A <sub>1</sub>	r	r <sub>1</sub>	r <sub>2</sub>	L	R	$\alpha$	$\alpha 1$
SO 2041	44	40	32	11	7	8,5	130	175	30	30
SO 2042	50	40	40	14	7,5	8	130	280	33	18
SO 2043	62	50	50	17	9	10	175	340	30	22° 24'

6.500W





# ELECTROLUX MACEDONIA

NOSAČI GREJAČA U PLAFONU

DECKENHEIZKÖRPERHALTER

CEILING HEATER (SUPPORTS)  
GIRDERS

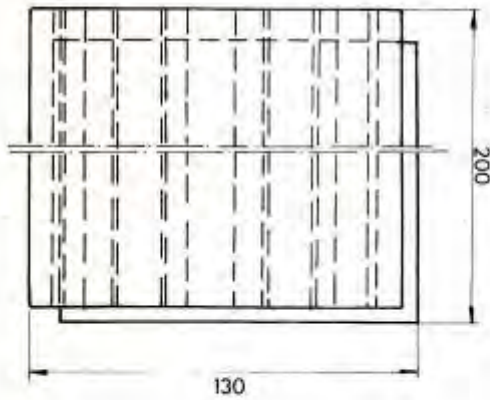
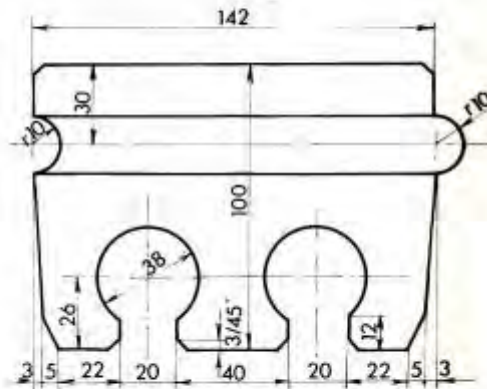
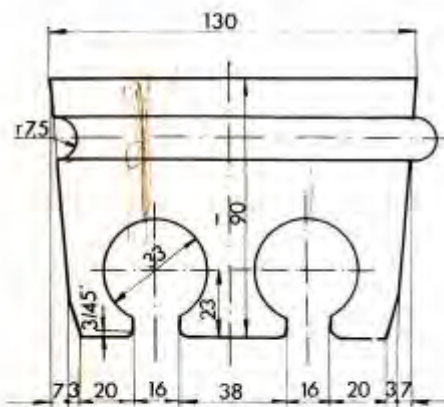

SO2047

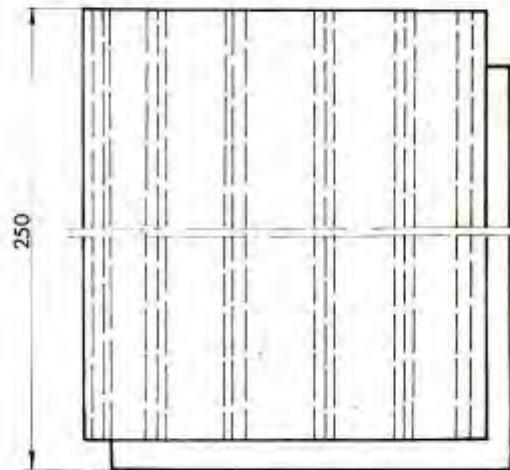

SO2048



# ELECTROLUX MACEDONIA

QIEG 730.01.018

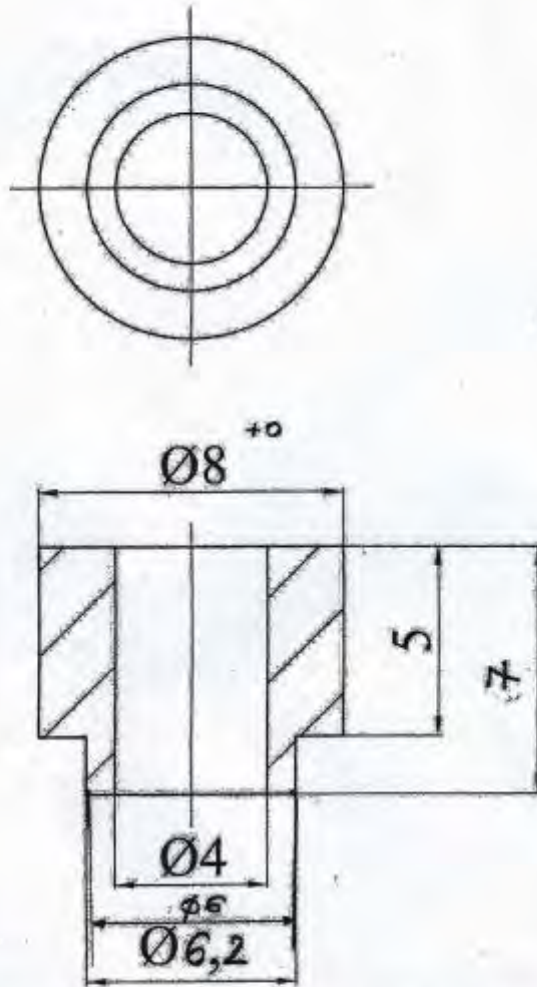

Poz.	Naziv dela	korn.	Oznaka dela	materijal i primedbe	
Ime crtača	Tolerancije slobod. kota	Kvalitet obrade	RAZMERA		masa
Poviklo	datum	ime i prez.	Potpis	materijal	
	Konstrui.	Begovic S.		Naziv dela	
	Crtao	Begovic S.		Perla za M4	
	Odobrio	Drifjaca M.			
I.E.G.		šifra			list br.
Ime	datum	ime	INDUSTRIJA ELEKTRIČNIH OPREMA		listova



# ELECTROLUX MACEDONIA

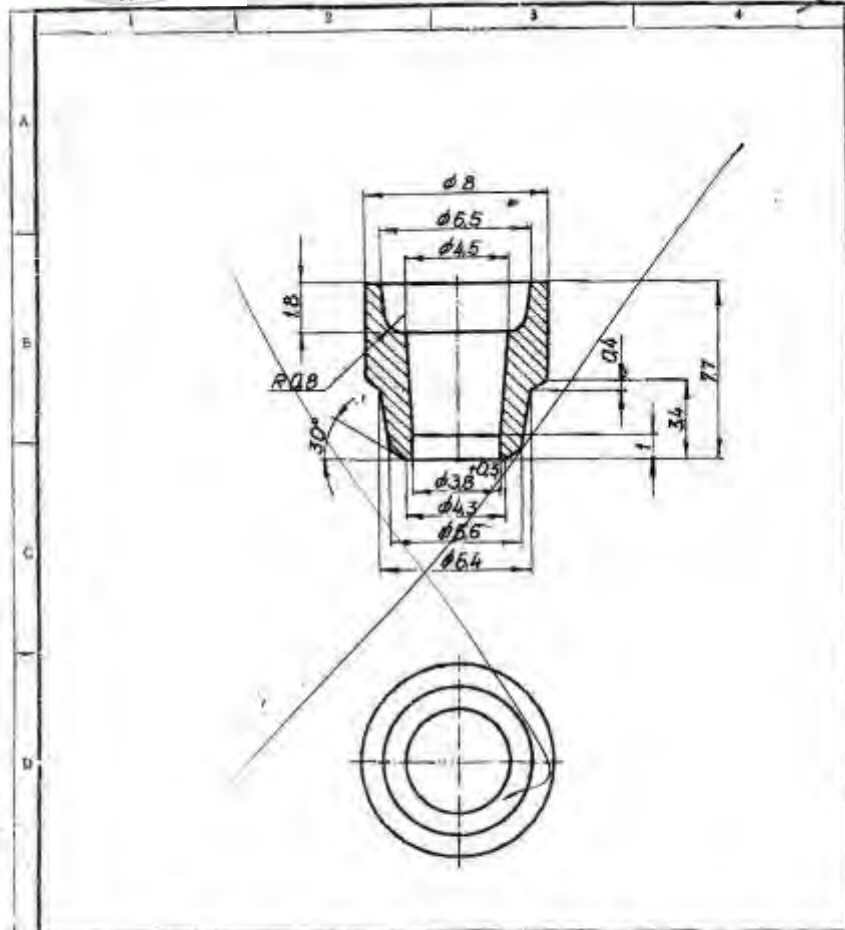

Kom.	Naziv dela			Poric.	Broj crtefa	Materijal	Priloga	Teles
	Crtef	Osnan	Prezime	Poljta	Umsufak b:		<b>Industrija Elektroporcelana ARANĐELOVAC</b>	
	Kontr.							
	Crtan	B.D. 07	V. Grujic	gus				
	Proverio							
	Odebric	PIJARIC	ING. R. R. R. R. R.					
	Materijal:	KER 227	Priloga:	BEZ - C	Telegrafija:	Do - 5	Izvozna dokumentacija:	
		steolit			JUS B. D. 030			
	Dimenzije	Naziv dela:			Zastupnik:		Zastupnik no:	
		5:1			PERLA		111023701.00	
					-pečen-		Zastupnik za: 11.10.237.01	
							Broj crtefa:	





# ELECTROLUX MACEDONIA

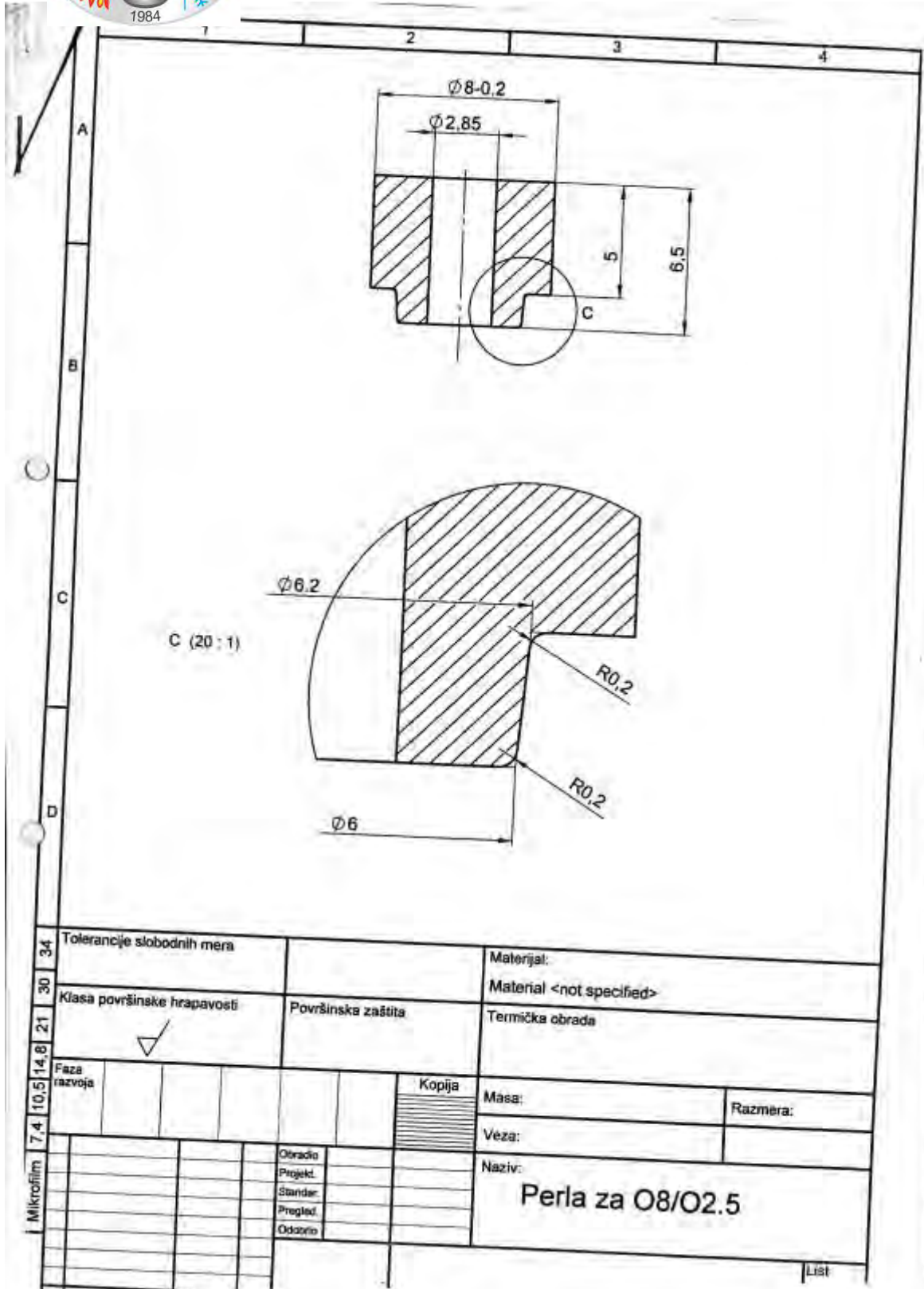

34	Tolerancije slobodnih mera		Materijal:	
30	Klasa površinske hrapavosti		Material <not specified>	
21	Površinska zaštita		Termička obrada	
14,8	Faza razvoja		Kopija	
10,5			Masa:	
7,4			Veza:	
Mikrofilm			Naziv:	
			Perla za O8/O2.5	
			List	



# ELECTROLUX MACEDONIA

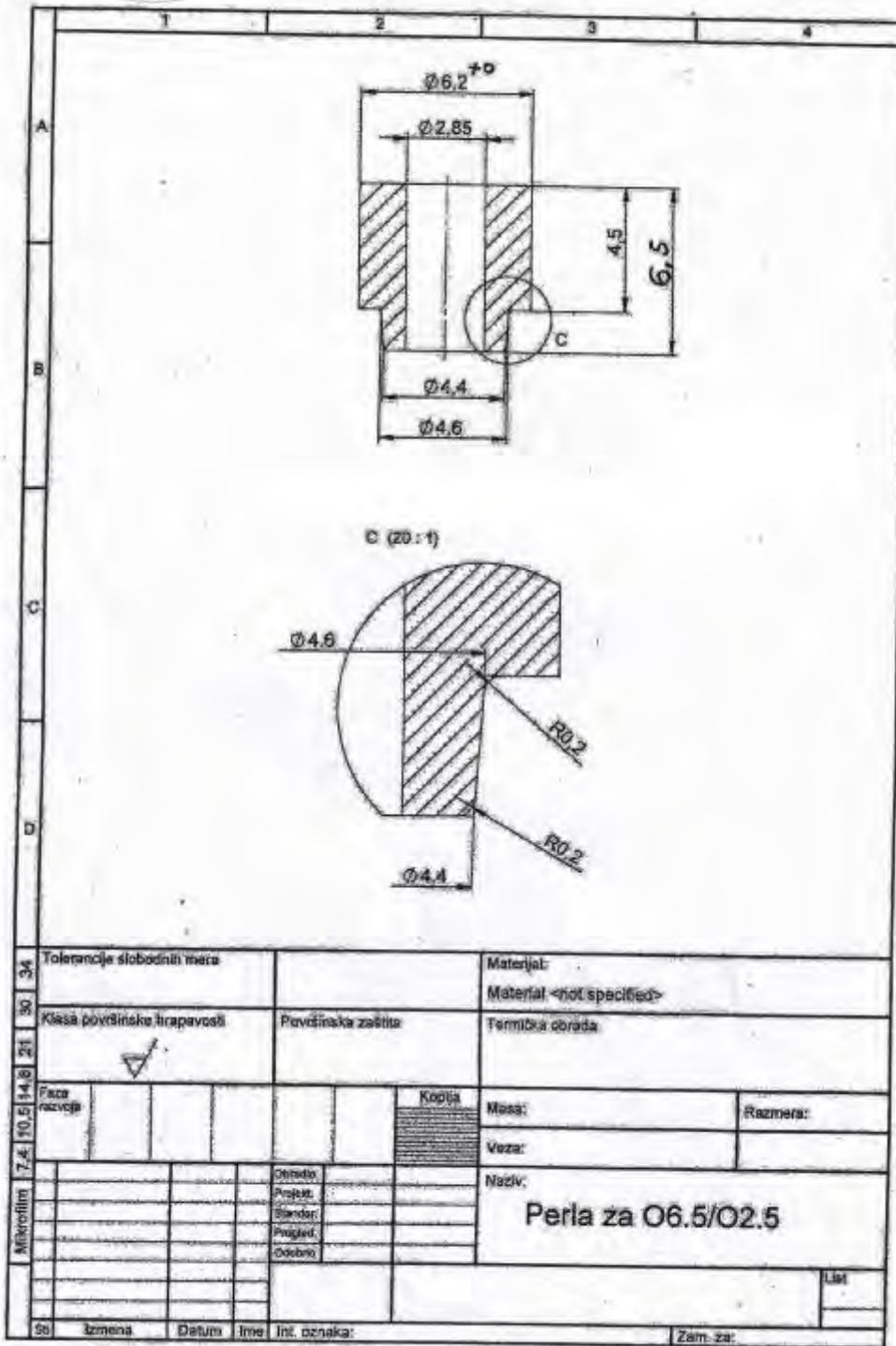



# ELECTROLUX MACEDONIA

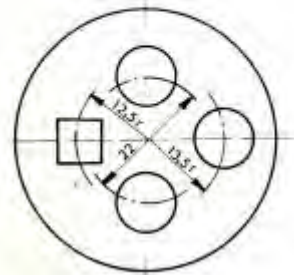
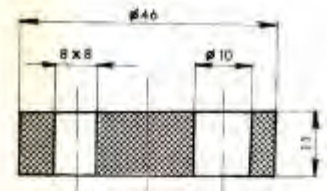
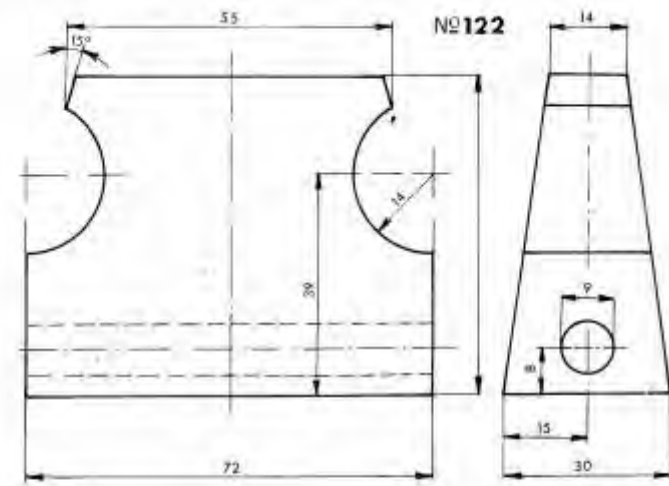
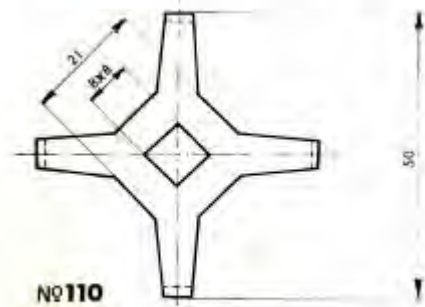
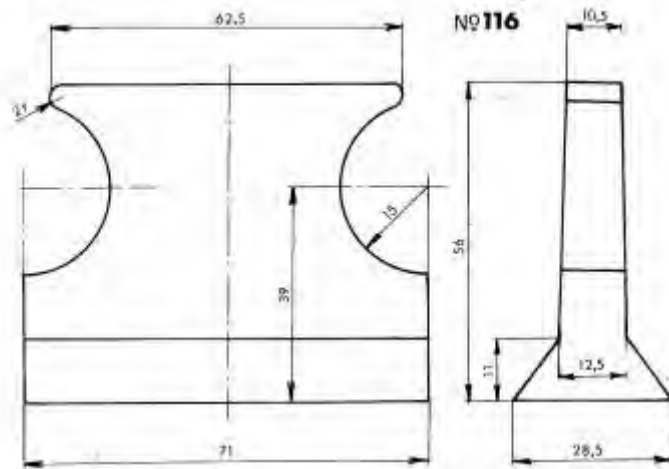
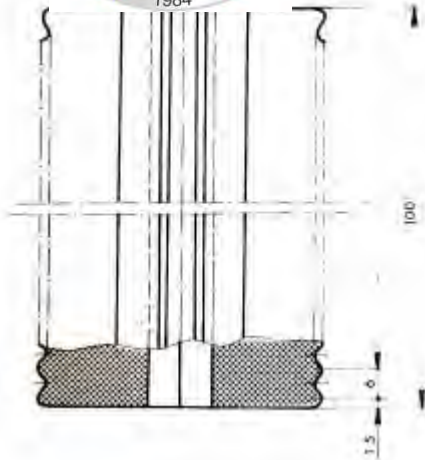

NOSAČI GREJAČA GRUPA RING IZRAĐENI SU OD MATERIJALA CERTERM 1 I CERTERM 2.

HEIZKÖRPERHALTER GRUPPE RING, AUSGEFERTIGT AUS MATERIAL CERTERM 1 UND CERTERM 2.

SUPPORTERS FOR HEATING ELEMENTS, GROUP RING, ARE MADE FROM CERTERM 1 AND CERTERM 2 MATERIALS.







# ELECTROLUX MACEDONIA

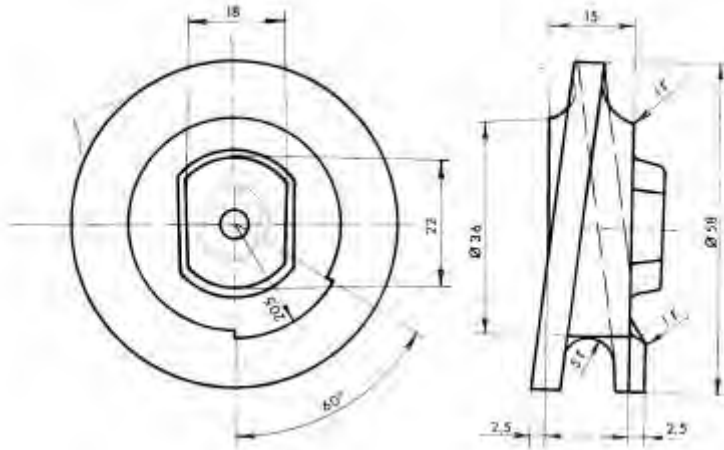

NOSAČ GREJAČA GRUPA SNG IZRA-  
DENI SU OD MATERIJALA CERTERM 2.

HEIZKÖRPERHALTER GRUPPE SNG,  
AUSGEFERTIGT AUS MATERIAL  
CERTERM 2.

SUPPORTERS FOR HEATING ELE-  
MENTS, GROUP SNG ARE MADE FROM  
CERTERM 2 MATERIAL.

7PA-10

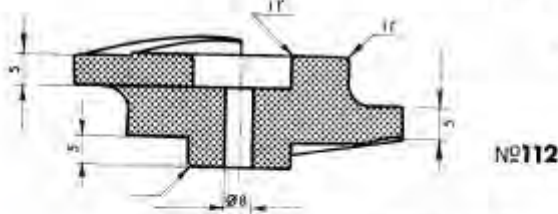

№112

PRESEK A-B  
DURCHSCHNITT  
CROSS SECTION

PRESEK C-D  
DURCHSCHNITT  
CROSS SECTION

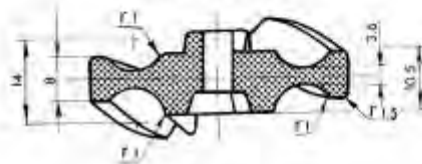

№113

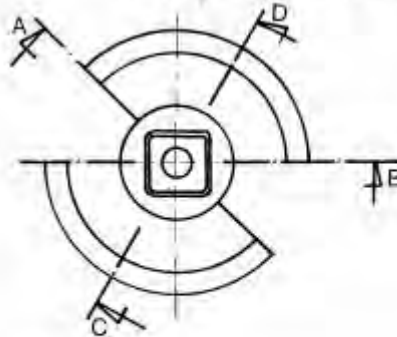
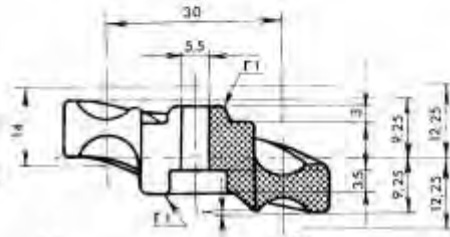

7PA-10



# ELECTROLUX MACEDONIA

NOSAČ GREJAČA, GRUPA SNG, IZRA-  
 DENI SU OD MATERIJALA CERTERM 2  
 HEIZKÖRPERHALTER, GRUPPE SNG,  
 AUSGEFERTIGT AUS MATERIAL  
 CERTERM 2  
 SUPPORTERS FOR HEATING ELE-  
 MENTS, GROUP SNG ARE MADE FROM  
 CERTERM 2 MATERIAL

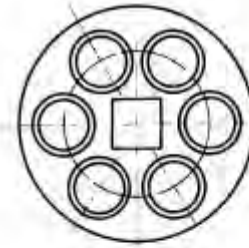
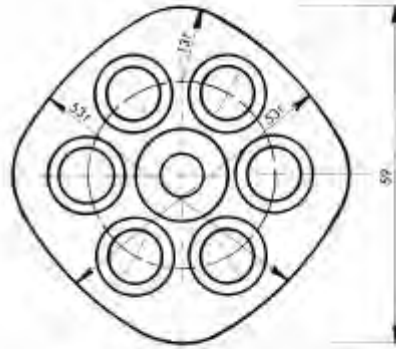
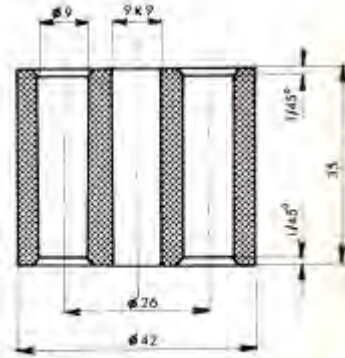
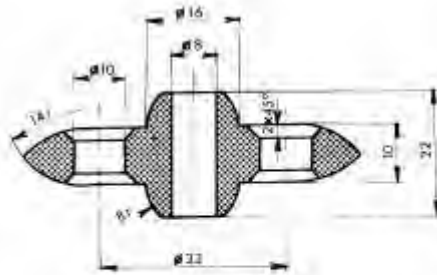

№ 117 TPA-10

№ 120

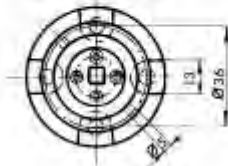
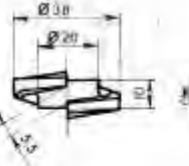
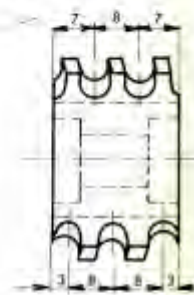
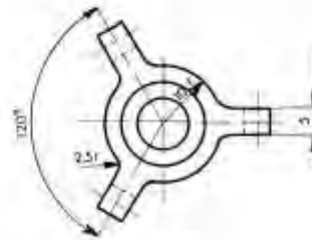
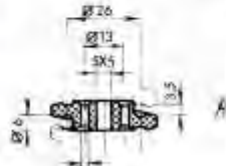
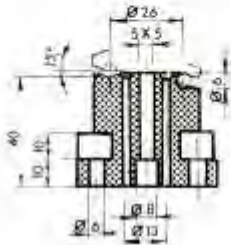

№ 124



№ 131

РУЧНА БРЗО КОДИРА





# ELECTROLUX MACEDONIA

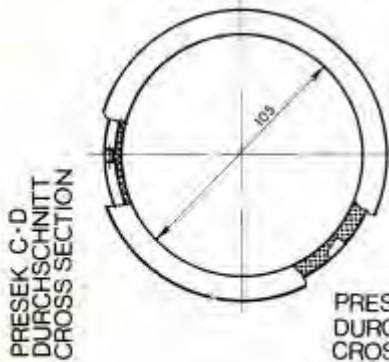
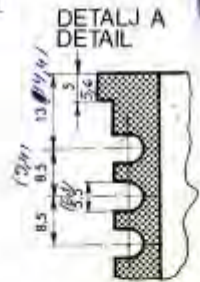
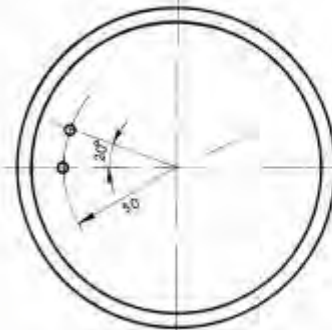
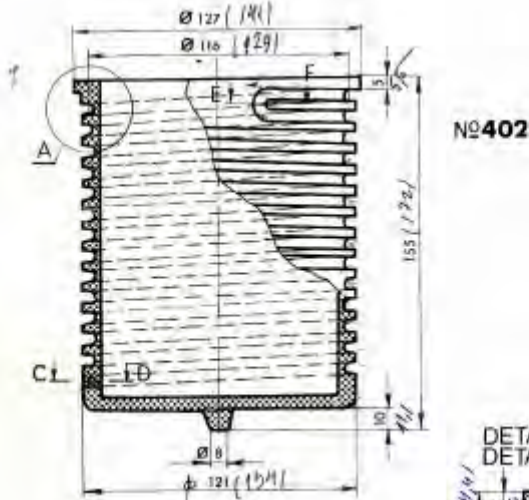
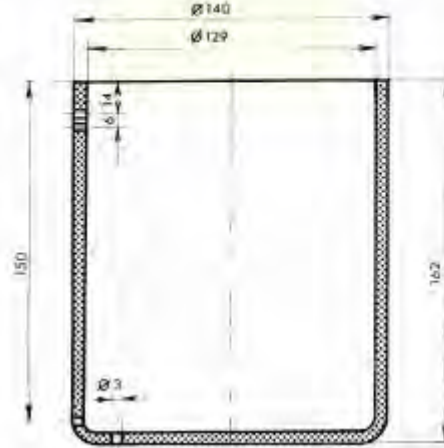
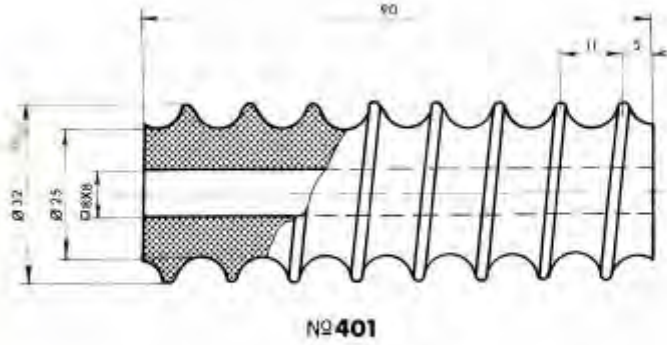

PRESEK E-F  
DURCHSCHNITT  
CROSS SECTION

ZAVOJNI NOSAČI GREJAČA, GRUPA ZNG. IZRADENI SU OD MATERIJALA CERTERM 1

GEWINDENFÖRMIGE HEIZKÖRPERHALTER, GRUPPE ZNG. AUSGEFERTIGT AUS MATERIAL CERTERM 1.

SCREWED SUPPORTERS FOR HEATING ELEMENTS. GROUP ZNG. ARE MADE FROM CERTERM 1 MATERIAL.



# ELECTROLUX MACEDONIA

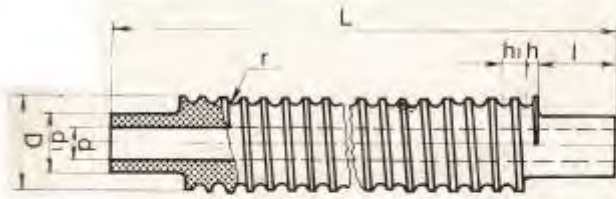

ZNG	D	d	d <sub>1</sub>	L	l	h	h <sub>1</sub>	r
404A	17	6	11	240	14	2,5	5	1,5
404B	25	7	18	295	12	4	6	2
404C	16	5,5	12	122	10	3	5	2

**№404**

*404D*

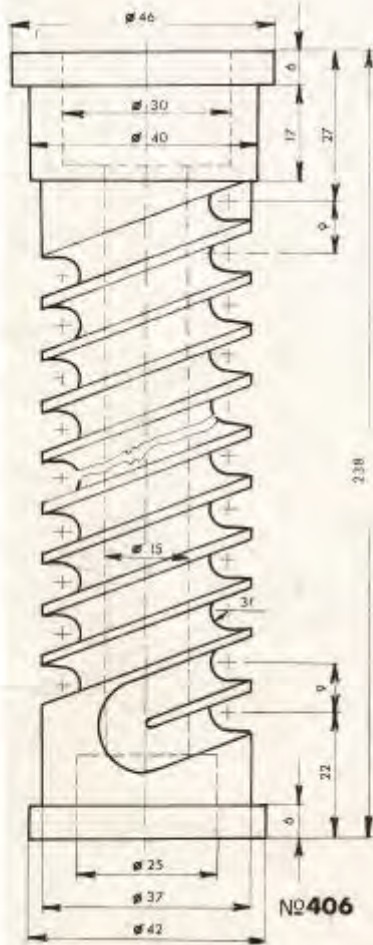

**№406**



*GEWINDENFORMIG*

*404D*



**№408**

ZAVOJNI NOSAČI GREJAČA, GRUPA ŽNG. IZRADENI SU OD MATERIJALA CERTERM 1

GEWINDENFÖRMIGE HEIZKÖRPERHALTER, GRUPPE ZNG. AUSGEFERTIGT AUS MATERIAL CERTHERM 1.

SCREWED SUPPORTERS FOR HEATING ELEMENTS. GROUP ZNG. ARE MADE FROM CERTERM 1 MATERIAL



# ELECTROLUX MACEDONIA

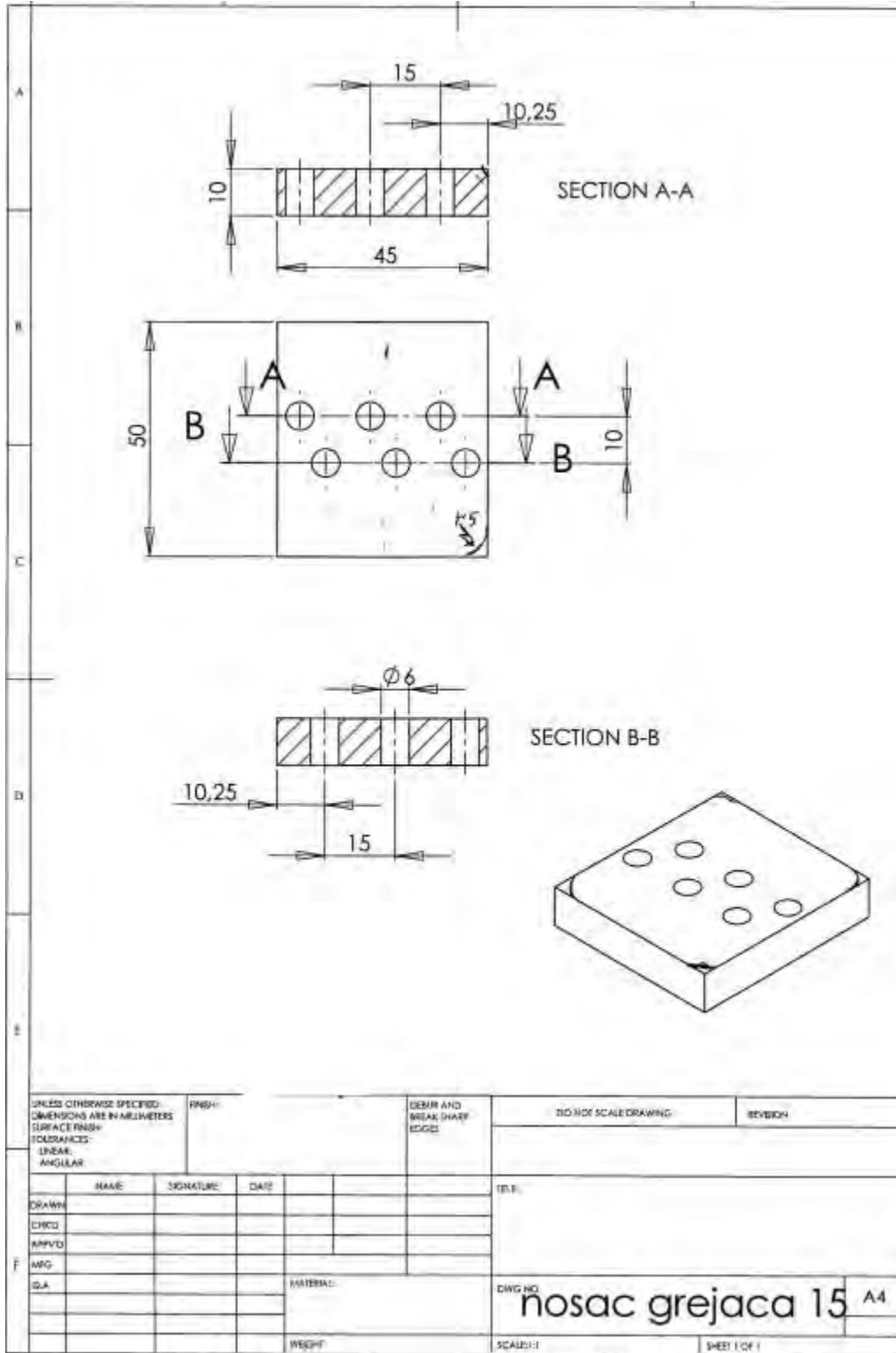







# ELECTROLUX MACEDONIA

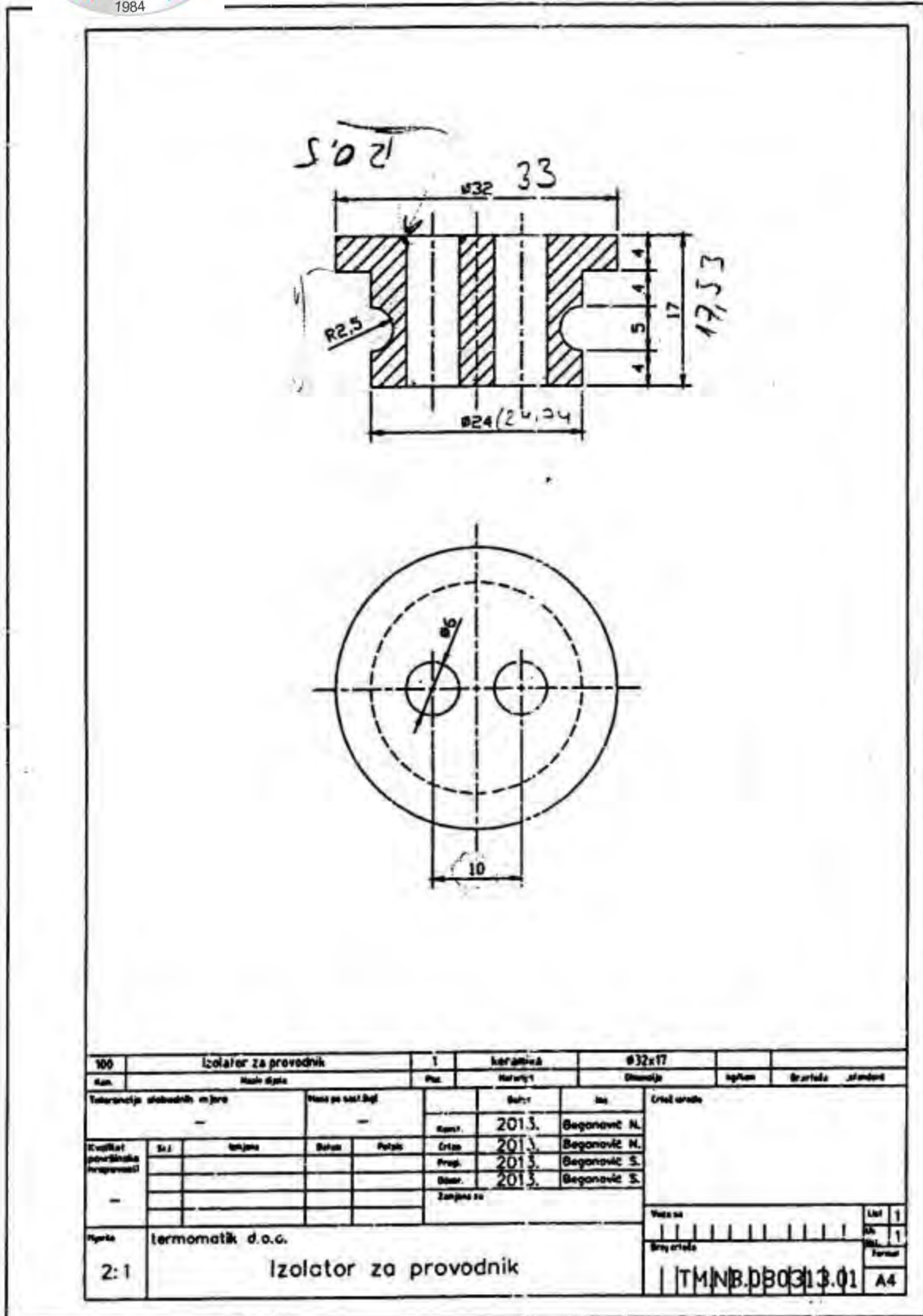



# ELECTROLUX MACEDONIA

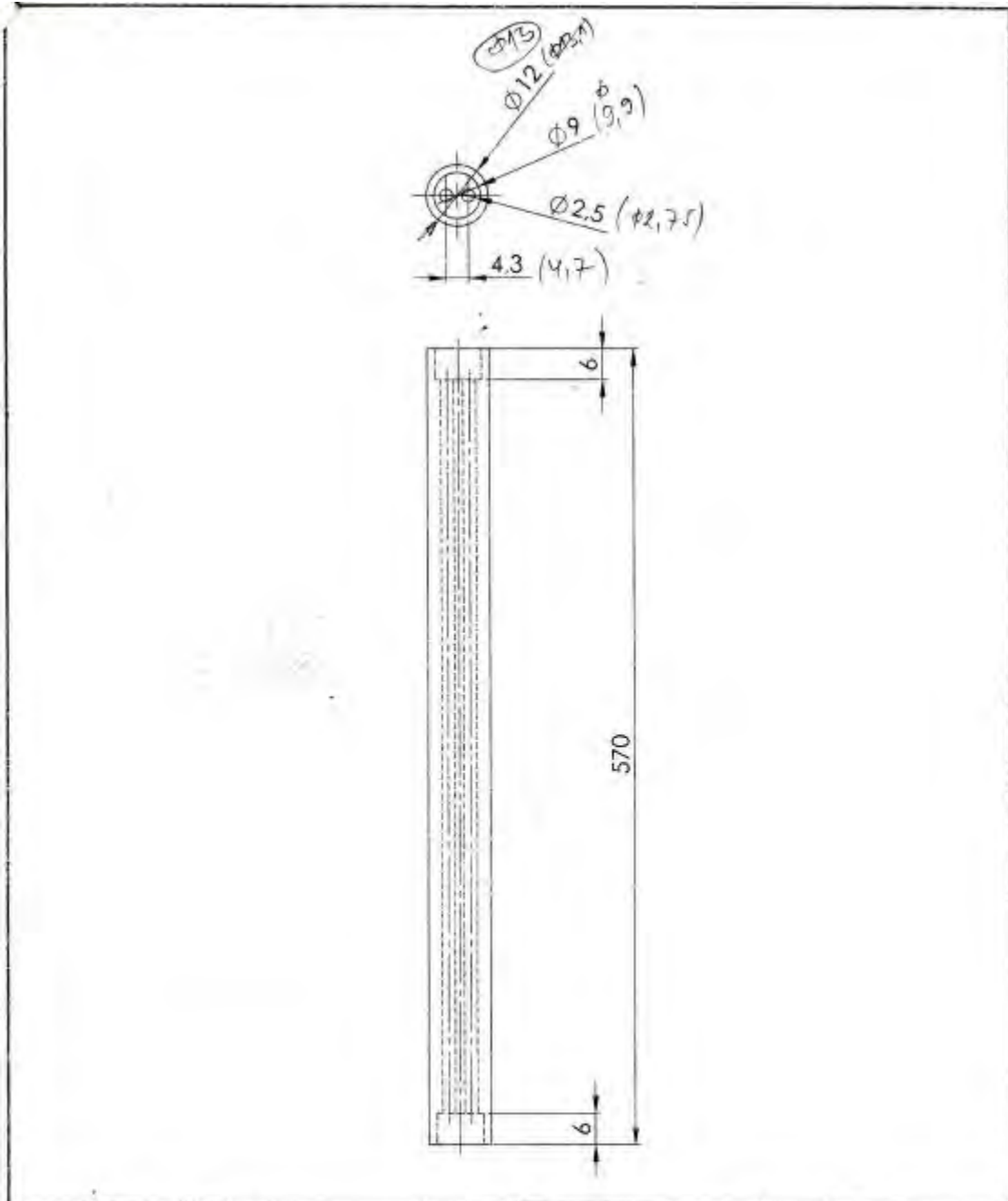

UNITS OTHERWISE SPECIFIED: DIMENSIONS ARE IN MILLIMETERS		FINISH:		DIMS AND IDEAL SHARP EDGES		DO NOT SCALE DRAWING		REVISION	
SURFACE FINISH:									
TOLERANCES:									
LINEAR:									
ANGULAR:									
DRAWN	NAME	SIGNATURE	DATE			TIT: NOSAČ GREJAČA			
CHECKED									
APPROVED									
MFG									
QA				MATERIAL:		DWS NO:		KER2	
								A4	
				WEDGE:		SCALE: 1:10		SHEET 1 OF 1	





# ELECTROLUX MACEDONIA

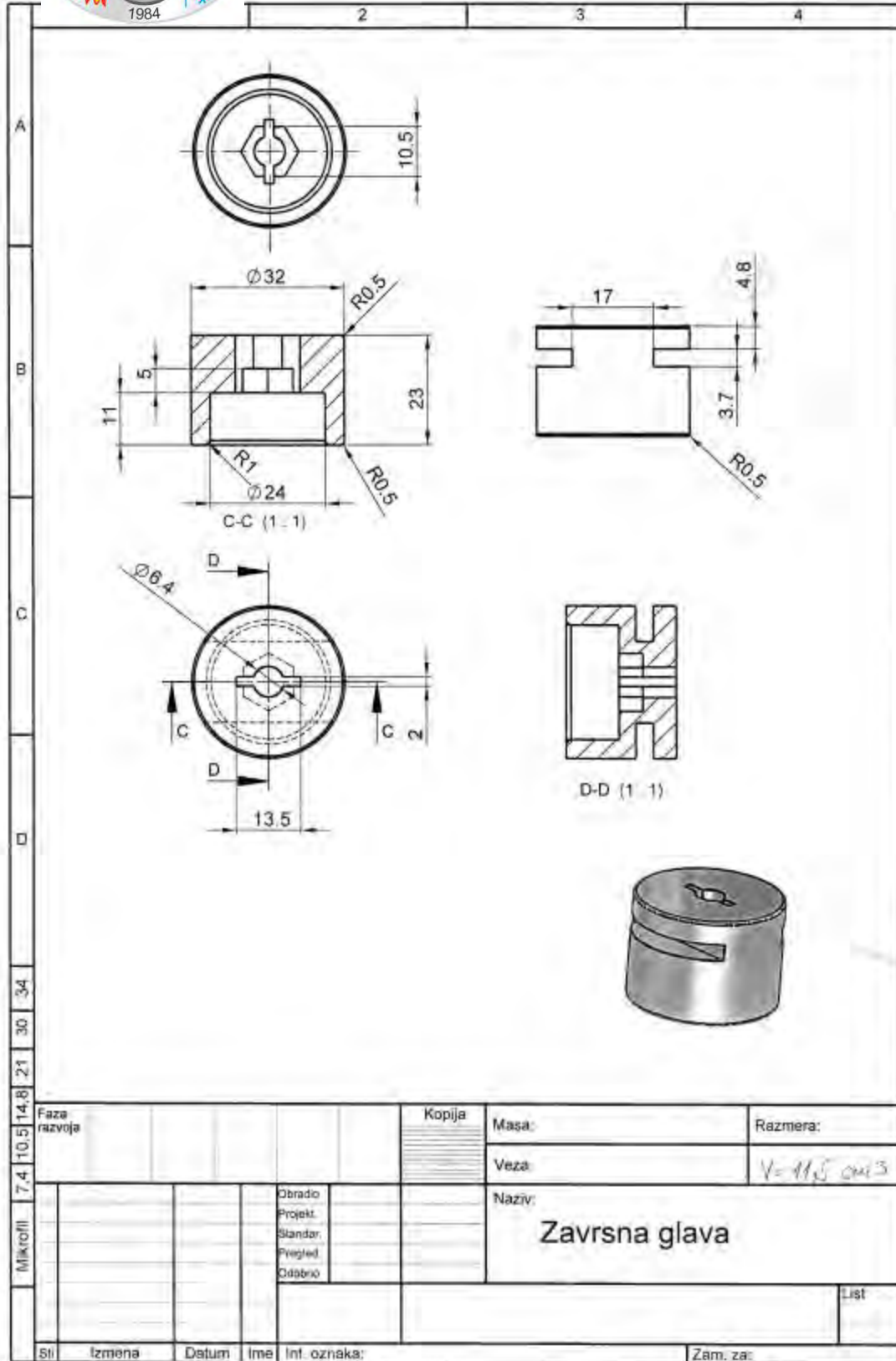





# ELECTROLUX MACEDONIA

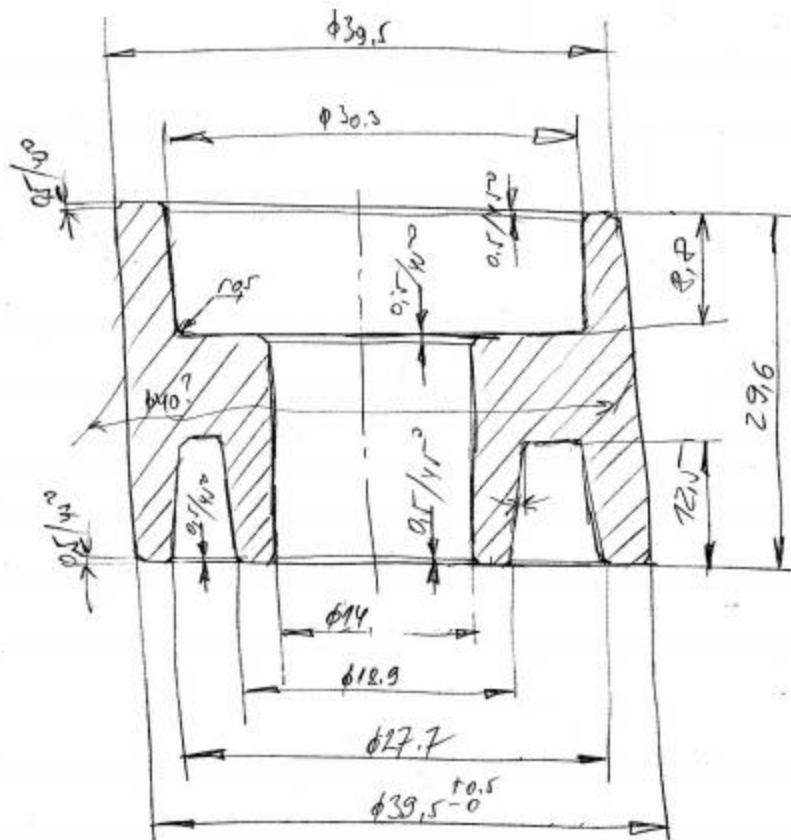

ZAVRŠNI NOSAČ GREJAČA

ŽENSKI DEO