



Solenoid Valves, T-GT Series Direct Operated; N.C and Pilot Operated N.C / N.O



Product code : T-GT 100.....T-GT103

Brand : TORK

Solenoid Valves, T-GT Series Direct Operated; N.C and Pilot Operated N.C / N.O

GENERAL PURPOSE SOLENOID VALVE
 2/2 WAY DIRECT ACTING
 1/8".... 1/2" direct acting
 3/8".....1" pilot operated

T-GT 100
T-GT 101
T-GTD 102
T-GTD 105

for; air, water, gas and inert gas

NORMALLY COLESED SOLENOID VALVE

APPLICATIONS



T-GT 100, 101 Direct Operated

Water

Air, pneumatic systems

Gas, LPG, CO, N2, CO2. etc

Hospital equipments



T-GT.102 - 103 Direct Operated

2/2 way N.C position

temperature

media temperature min: -10, max: 80°C

max. ambient temperature: +60 °C

Machinery for the food industry

Water treatment systems

Textile factories

Printing machines and systems

Non aggressive gases

COILS

Voltage: for AC , 220/230V, 110V, 48V, 24V, 12 V AC
for DC , 110 , 48V , 24V, 12V

Insulation class: H , (180 °C)

Ambient temperature: -10 °C ; +60 °C

Protection class: IP 65 (EN 60523)

Continuous duty: ED % 100

Special coil voltages: 12V AC.230V AC and 12V DC,
48V DC, 110V DC

Exproof class EEx md II T4 (on request)

GENERAL FEATURES

- * Air water, gas and non-aggressive media applications.
- * Direct acting solenoid valve works at the 0 bar.
- * 97/23 EC pressure equipment directive PED , 73/23EEC
- * Different voltage coils can be apply on same valves
- * Solenoid valve must be installed vertical and upright
- * Solenoid valve must be used with filtered fluid
- * Solenoid valves min working pressure 0 bar
- * Explosion proof solenoid valves are for (zone 2,3)

MATERIALS IN CONTACT WITH FLUID

- Body: brass (EN 1503-4)
- Internal parts: stainless steel
- Tube: brass
- Sealing: NBR (on request EPDM, FKM)
- Shading ring: copper
- Orifice seat : brass
- Springs: stainless steel
- On request: different orifice sizes



ELECTRICAL FEATURES

Protection class : IP65 (EN 60529)
 Electrical conn.: DIN46340.3 poles, socket DIN 43650
 Connector: ISO 4400
 Voltage: AC for, 220/230V, 110V, 48V, 24V, 12 V AC 50/60Hz
 DC for, 110 , 48V , 24V, 12V
 Voltage Tolerances: for AC: -15%: +10%, for DC: -5%: +10%

TECHNICAL FEATURES

Opening time: 5- 20 msec
 Closing time : 5- 20 msec
 Viscosity max.: 5 E0 (37 cSt or mm2/s)

CERTIFICATES

CE TUV, ISO9001:2000, TSEK, TS3380
 TSE Exproof, UKSEPRO, GOST, EN264

TORK T-GT100. 101 SERIES DIRECT OPERATED SOLENOID VALVE

Size	Type No:	Orifice	Kv	Pressure		Temperature		Body	Seal	Net Weight
				Min	Max	Min	Max			
G	T-GT Series	(mm)	(Lt/min)					Brass	---	(kg)
1/8"	T-GT100	1,8	1,6	0.....16		-10.....80		MS58	NBR	0,31
1/8"	T-GT100.2,5	2,5	3,2	0.....12		-10.....80		MS58	NBR	0,31
1/8"	T-GT100.3	3	4,6	0.....10		-10.....80		MS58	NBR	0,31
1/8"	T-GT100.4	4	6,4	0.....9		-10.....80		MS58	NBR	0,31
1/8"	T-GT100.4,5	4,5	7,5	0.....8		-10.....80		MS58	NBR	0,31
1/4"	T-GT101	1,8	1,6	0.....16		-10.....80		MS58	NBR	0,30
1/4"	T-GT101.2,5	2,5	3,2	0.....12		-10.....80		MS58	NBR	0,30
1/4"	T-GT101.3	3	4,6	0.....10		-10.....80		MS58	NBR	0,30
1/4"	T-GT101.4	4	6,4	0.....9		-10.....80		MS58	NBR	0,30
1/4"	T-GT101.4,5	4,5	7,5	0.....8		-10.....80		MS58	NBR	0,30

3/8" T-GT102.3	3	4,6	0.....10	-10.....80	MS58	NBR	0,40
3/8" T-GT102.4	4	6,4	0.....9	-10.....80	MS58	NBR	0,40
3/8" T-GT102.5	5	9,2	0.....7	-10.....80	MS58	NBR	0,40
1/2" T-GT103.3	3	4,6	0.....10	-10.....80	MS58	NBR	0,40
1/2" T-GT103.4	4	6,4	0.....9	-10.....80	MS58	NBR	0,40
1/2" T-GT103.5	5	9,2	0.....7	-10.....80	MS58	NBR	0,40



Pilot Controlled Solenoid Valve,
Normally Closed Position, N.C / N.O.
3/8".....1"

T-GTD103

T-GTD105

T-GTD Serie	Pilot Operated, Diaphragm Solenoid Valve, Minimum Diff. Pressure 0,35 bar max.16 bar.
application	air, water, gas
coil voltage	230, 220V, 110V, 24V, 12V AC, 24V, 12V DC (specify with order)
protection class	IP 65 plug
body	brass (EN 1503-4)
tube, internal parts	stainless steel

TORK T-GTD 102.105 SERIE PILOT OPERATED SOLENOID VALVES

N.C Normally Closed Solenoid Valves, Pilot Operated



Size	Type No:	Orifice	Kv	Pressure		Temperature		Body	Seal	Net Weight
				Min	Max	Min	Max			
G	T-GTD Series	(mm)	(Lt/min)	Min	Max	Min	Max	Brass	---	(kg)
3/8"	T-GTD102	12,5	45	0,5.....16		-10.....80		MS58	NBR	0,68
1/2"	T-GTD103	12,5	65	0,5.....16		-10.....80		MS58	NBR	0,64
3/4"	T-GTD104	15	70	0,5.....16		-10.....80		MS58	NBR	0,79
1"	T-GTD105	15	85	0,5.....16		-10.....80		MS58	NBR	0,96

N.O Normally Open Solenoid Valves, Pilot Operated

Size	Type No:	Orifice	Kv	Pressure		Temperature		Body	Seal	Net Weight
				Min	Max	Min	Max			
G	T-GTDN Series	(mm)	(Lt/min)	Min	Max	Min	Max	Brass	---	(kg)
3/8"	T-GTDN102	12,5	45	0,35.....12		-10..... 80		MS58	NBR	0,68
1/2"	T-GTDN103	12,5	65	0,35.....12		-10..... 80		MS58	NBR	0,66
3/4"	T-GTDN104	15	62	0,35.....12		-10..... 80		MS58	NBR	0,8
1"	T-GTDN105	15	75	0,35.....12		-10..... 80		MS58	NBR	0,97

spare parts coils 12 VA



spare parts coils 12 VA

T-SB10	AC, 50/ 60Hz
T-SB11	220/230 VAC
T-SB13	110V AC
T-SB14	24 V AC
	12 V AC

EL

News

Electrolux
Macedonia
Palenzo

T-SB15

24 V DC

T-SB16

12 V DC

H class thermoplastic insulation reinforced with %30
glassofibre and % 100 ED

for AC: (-15, +10 %V), for DC(-15, +10 %V),

voltage
tolerance

ED %100, H class 180 °C, IP 65 (EN60529)



Solenoid Valves, T-GD Series Block Body, N.C



Product code : T-GD.102,.....T-GD.103

Brand : TORK

Solenoid Valves, T-GD Series Block Body, N.C

T-GD 100
T-GD 101

TORK Direct Operated, Solenoid Valves;
Normally Closed Position

Application	:	air, gas, water, non-aggressive fluids
Coil voltage	:	230, 220V, 110V, 24V,12V AC, 24V, 12V DC
Protection class	:	IP 65 with plug
Connection	:	G(BSP) , on request NPT
Orifice	:	3mm.....9mm
Tube/core,spring	:	Complete stainless steel
On request	:	Different orrifice sizes and 1/4" connection size



Size	Order Type	Way	Orifice	Kv	Pressure (bar)	Temp. (°C)	Body	Seal	Net Weight
------	------------	-----	---------	----	----------------	------------	------	------	------------



G	T-GD Series	---	(mm)	(lt/min)	Min	Max	Min	Max	Brass	---	(kg)
3/8"	T-GD102.5	2/2	5	9,2	0.....7		-10.....80		MS58	NBR	0,48
3/8"	T-GD102.6	2/2	6	11	0.....6		-10.....80		MS58	NBR	0,48
3/8"	T-GD102.7	2/2	7	12,4	0.....5		-10.....80		MS58	NBR	0,48
3/8"	T-GD102.8	2/2	8	13,5	0.....3		-10.....80		MS58	NBR	0,48
3/8"	T-GD102.9	2/2	9	16	0.....2		-10.....80		MS58	NBR	0,48
3/8"	T-GD102.10	2/2	10	19	0.....1		-10.....80		MS58	NBR	0,48
1/2"	T-GD103.5	2/2	5	9,2	0.....7		-10.....80		MS58	NBR	0,47
1/2"	T-GD103.6	2/2	6	11	0.....6		-10.....80		MS58	NBR	0,47
1/2"	T-GD103.7	2/2	7	12,4	0.....5		-10.....80		MS58	NBR	0,47
1/2"	T-GD103.8	2/2	8	13,5	0.....3		-10.....80		MS58	NBR	0,47
1/2"	T-GD103.9	2/2	9	16	0.....2		-10.....80		MS58	NBR	0,47
1/2"	T-GD103.10	2/2	10	19	0.....1		-10.....80		MS58	NBR	0,47
1/2"	T-GDN103.5	2/2	2,5	3,2	0.....10		-10.....80		MS58	NBR	0,49



Direct Acting, T-GP Series Solenoid Valve. N.C



Product code : T-GP Serisi,T-GP100,T-GP101

Brand : TORC

Direct Acting, T-GP Series Solenoid Valve. N.C

GENERAL PURPOSE SOLENOID VALVE
 2/2 WAY DIRECT ACTING
 1/8" ... 1/4" direct acting types
 3/8" ... 2" pilot operated types

T-GP 100
T-GP 101

T-GP 102
T-GP 108

for; air, water, gas and inert gas

NORMALLY CLOSED SOLENOID VALVE

T-GP 100.. 101 Direct Operated



1/8" ... 1/4"

T-GP.102 ... 108 Pilot Operated

APPLICATIONS

- Water
- Air, pneumatic systems
- Gas, LPG, CO, N2, CO2. etc
- Hospital Equipments
- Machinery for food industry
- Water Treatment Systems
- Textile Factories
- Printing Machines and Systems
- Non-Aggressive Gases



3/8".....2"

2/2 way N.C position

COILS

Voltage: for AC , 220/230V, 110V, 48V, 24V, 12 V AC
for DC, 110, 48V, 24V, 12V

Insulation Class: H , (180 °C)

Ambient Temperature: -10 °C ; +60 °C

Protection Class: IP 65 (EN 60523)

Continuous Duty: ED % 100

Special Coil Voltages: 12V AC AC and 12V DC,
48V DC, 110V DC

Exproof Class EEx md II T4 (on request)

Temperature

Media Temperature Min: -10, max: 80°C

Max. Ambient Temperature: + 60 °C

GENERAL FEATURES

- * Air water, gas and none aggressive media applications.
- * Direct acting solenoid valve works at the 0 bar.
- * 97/23 EC pressure equipment directive PED ,73/23EEC
- * Different voltage coils can be apply on same valves
- * Solenoid valve must be installed vertical and upright
- * Solenoid valve must be used with filtered fluid
- * Solenoid valves direct opr. min working pressure 0 bar
- * Solenoid valves pilot opr. min working pressure 0,5 bar
- * Explosion proof solenoid valves are for (zone 2,3)

MATERIALS IN CONTACT WITH FLUID

Body: brass (EN 1503-4)
Internal parts: stainless steel
Tube: stainless steel
Sealing: NBR (on request EPDM, FKM)
Shading ring: copper
Orifice seat : brass
Springs: stainless steel
On request: different orifice sizes



ELECTRICAL FEATURES

Protection class: IP65 (EN 60529)

Electrical connector.: DIN46340.3 poles, DIN 43650

Connector: ISO 4400

Voltage: for AC , 220/230V,110V, 48V, 24V, 12 V AC 50/60Hz
for DC , 110 , 48V , 24V, 12V

Voltage tolerances: for AC : -15%: +10%, for DC: -15%: +10%

TECHNICAL FEATURES

Opening time: 5- 20 ms

Closing time : 5- 20 ms

Viscosity max.: 5 E0 (37 cSt or mm2/s)

CERTIFICATEC

E TUV, ISO901:2000, TSEK, TS3380

TSE Exproof, UKSEPRO, GOST, EN264

TORK T-GP100. 101 SERIE DIRECT OPERATED and PILOT OPERATED SOLENOID VALVES

Size	Type No	Orifice	Kv	Pressure (bar)		Temp.(°C)		Body	Seal	Net Weight
				Min	Max	Min	Max			
G	T-GP Series	(mm)	(lt/min)					Brass	---	(kg)
1/8"	T-GP.100	1,8	1,6	0.....16		-10.....80		MS58	NBR	0,36
1/8"	T-GP 100.2,5	2,5	3,2	0.....12		-10.....80		MS58	NBR	0,36
1/8"	T-GP.100.3	3	4,6	0.....10		-10.....80		MS58	NBR	0,36
1/8"	T-GP.100.4	4	6,4	0.....9		-10.....80		MS58	NBR	0,36
1/8"	T-GP.100.5	5	9,2	0.....7		-10.....80		MS58	NBR	0,36
1/8"	T-GP.100.6	6	11	0.....5		-10.....80		MS58	NBR	0,36
1/4"	T-GP.101	1,8	1,6	0.....16		-10.....80		MS58	NBR	0,35
1/4"	T-GP.101.2,5	2,5	3,2	0.....12		-10.....80		MS58	NBR	0,35

1/4"	T-GP.101.3	3	4,6	0.....10	-10.....80	MS58	NBR	0,35
1/4"	T-GP.101.4	4	6,4	0.....9	-10.....80	MS58	NBR	0,35
1/4"	T-GP.101.5	5	9,2	0.....7	-10.....80	MS58	NBR	0,35
1/4"	T-GP.101.6	6	11	0.....5	-10.....80	MS58	NBR	0,35
1/4"	T-GP.101.7	7	12,4	---	-10.....80	MS58	NBR	0,35

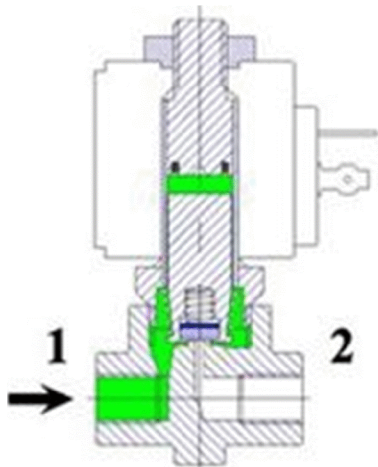

T-GP 101 Direct Operated Solenoid Valve
N.C. Normally Closed Position

Test Standards

EN12516-2, EN1266-1,
EN12516-3

PN10 bar (tested at 16 bar)

PN16 bar (tested at 25 bar)

PN25 bar (tested at 40 bar)

PN40 bar (tested at 60 bar)

DIN 2401

Spare parts: 12 VA coils



Spare parts: 12 VA coils

T-SB10

T-SB11

AC,50/60Hz

220/230 VAC

110V AC

EL

News

Electrolux
Macedonia
Palenzo

T-SB13 24 V AC

T-SB14 12 V AC

T-SB15 24 V DC

T-SB16 12 V DC

H class thermoplastic insulation reinforced
with 30% fiberglass and 100% ED

for AC: (-15,+10 %V), for DC (-5,+10 %V)

Voltage
Tolerances

ED 100, H class 180 °C, IP 65 (EN60529)



Pilot Operated Solenoid Valve (T-GP Series) N.C



Product code : T-G102.....T-G108

Brand : TORK

Pilot Operated Solenoid Valve (T-GP Series) N.C

GENERAL PURPOSE SOLENOID VALVE
2/2 WAY , PILOT OPERATED
3/8" , 3"

T-GP 102

.....
T-GP 112

air, water, gas applications

solenoid valves

GENERAL PURPOSE

- * Fluid: water, air, inertgas and non agresive media
- * Pilot operated require min. 0,5 bar differantial pressure
- * TORK solenoid valvessatisfy all relevant EC approval
- * Coils interchangeable without dismanting the valve
- * Solenoid valves must be used with filtred fluids
- * Solenoid valves must be mounted vertical & upright

MATERIALS IN CONTACT WITH FLUID

Body: brass (EN 1503-4)
Internal parts: stainless steell
Seal: NBR (on request EPDM, FKM)
Shading ring: cupper
Seat: brass
Springs: stainless steell

* Solenoid valves are used clean fluid

On Request Body And Internal Parts

* On request exproof exproof solenoid valve (zone 2,3)

Can be Stainless Steel

ELECTRICAL CHARACTERISTICS

TECNICAL FEATURES

Continuous Duty 100 % ED

Coil isolations Class: H (180 °C)

Ambient Temperature (H class) : -10 °C ; +80 °C

Protection Class : IP65 (EN 60529)

Response time: 5- 20 ms

Electrical Conn.: DIN46340.3pule connector DIN 43650

Max. viscosity: 5 E0 (37 cSt or mm²/s)

Connector Specifation: ISO 4400 (plug)

Voltage: for AC , 220/230V, 110V, 48V, 24V, 12 V AC

for DC ,110 , 48V , 24V, 12V

Voltage tolerance: forAC : -15%:+10%, forDC : -1%:+10%



Pilot Operated General Purpose TORK Solenoid Valve Serie

Size	Type No	Orifice	Kv	Pressure(bar)		Pressure(°C)		Body	Seal	Net Weight
				Min	Max	Min	Max			
G	T-GP Series	(mm)	(lt/min)					Brass	---	(kg)
3/8"	T-GP102	12,5	48	0,5.....16		-10.....80		MS58	NBR	0,68
1/2"	T-GP103	14,5	70	0,5.....16		-10.....80		MS58	NBR	0,71
3/4"	T-GP104	17	85	0,5.....16		-10.....80		MS58	NBR	0,80
1"	T-GP105	17	90	0,5.....16		-10.....80		MS58	NBR	0,97
1 1/4"	T-GP106	46	390	0,5.....12		-10.....80		MS58	NBR	2,65
1 1/2"	T-GP107	46	460	0,5.....12		-10.....80		MS58	NBR	2,55
2"	T-GP108	46	580	0,5.....12		-10.....80		MS58	NBR	2,98

spare parts coils 12 VA

spare parts coils 17 VA



type.....	voltage
T-SB10	220/230 V AC
T-SB11	110V AC
T-SB13	24 V AC
T-SB14	12 V AC
T-SB15	24 V DC
T-SB16	12 V DC



type.....	voltage
T-SB10.1	220/230 V AC



Solenoid Valve T-GR Series (Plate Mounting, Brass Body), N.C



Product code : T-GR100,.....T-GR101

Brand : TORK

Solenoid Valve T-GR Series (Plate Mounting, Brass Body), N.C

PLATE MOUNTING
 GENERAL PURPOSE SOLENOID VALVE
 2/2 WAY , 3/2 WAY DIRECT ACTING
 1/8" ... 1/4" direct acting

T-GR .100
T-GR.N100
T-GR.3W100

for; air, water, gas and inert gas

NORMALLY COLESED / NORMALLY OPEN SOLENOID VALVE



APPLICATIONS

Water

Air, Pneumatic Systems

Gas, LPG, CO, N2, CO2. etc

Hospital Equipments

Machinery for food Industry

T-GR 100, 101 Direct Operated N.C

T-GRN.100 - 101 Direct Operated N.O

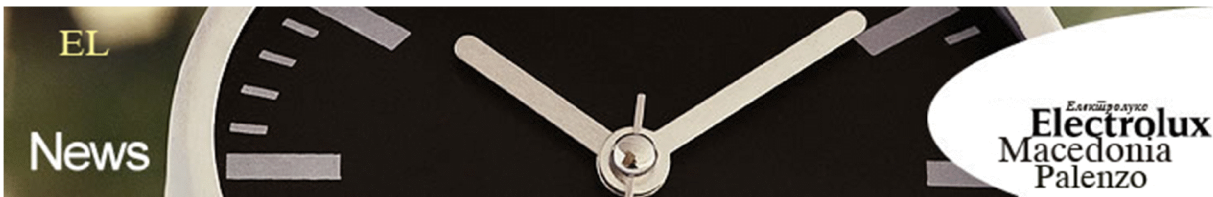

2/2 way N.C Position

Temperature

Media Temperature Min: -10, Max: 80°C

Max. Ambient Temperature: +60 °C

Water Treatment Systems

Textile Factories

Printing Machines and Systems

Non Agressive Gases

COILS

Voltage: for AC , 220/230V, 110V, 48V, 24V, 12 V AC
for DC , 110 , 48V , 24V, 12V

Insulation Class: H (180 °C)

Ambient Temperature: -10 °C ; +60 °C

Protection Class: IP 65 (EN 60523)

Continuous Duty: ED % 100

Specially Coil Voltage: 12V AC, 230V AC and 12V DC
48V DC, 110V DC

Exproof Class EEx md II T4 (on request)

GENERAL FEATURES

- * Air water, gas and none agressive media applications.
- * Direct acting solenoid valve works at the 0 bar.
- * 97/23 EC pressure equipment drective PED , 73/23EEC
- * Different voltage coils can be apply on same valves
- * Solenoid valve must be installed vertical and upright
- * Solenoid valve must be used with filtred fluid
- * On request manuel ovirride
- * Explosion proof solenoid valves are for (zone 2,3)

METERIALS IN CONTACT WITH FLUID

- Body: brass (EN 1503-4)
- Internal parts: stainless steel
- Tube: stainless steel
- Sealing: NBR (on request EPDM, FKM)
- Shading ring: copper
- Orifice seat : brass
- Springs: stainless steel
- On request: different orifice sizes



ELECTRICAL FEATURES

TECHNICAL FEATURES

Protection Class: IP65 (EN 60529)
 Electric Conn.: DIN46340.3 pole, socet DIN 43650
 Connector: ISO 4400 with socet
 Voltage: AC for, 220/230V, 110V, 48V, 24V, 12 V AC 50/60Hz
 DC for, 110 , 48V , 24V, 12V
 Voltage Tolerance: AC için: -15%: +10%, DC için:-5%: +10%

Opening Time: 5- 20 ms
 Closing Time : 5- 20 ms
 Viscosity Max.: 5 E0 (37 cSt or mm2/s)
CERTIFICATEC
 CE TUV, ISO901:2000, TSEK, TS3380
 TSE Exproof, UKSERPO, GOST, EN264

TORK T-GR100. 101 SERIE DIRECT OPERATED PLATE MOUNTING SOLENOID VALVE

NORMALLY CLOSED 2/2 WAY

size	Type No:	Orifice (mm)	Kv (Lt/min)	Pressure(bar)		Temp.(°C)		Body	Seal	Net Weight (kg)
				Min	Max	Min	Max			
1/8"	T-GR.100	3	4,6	0.....10		-10.....80		MS58	NBR	0,50
1/8"	T-GR.100.1	1	0,6	0.....100		-10.....80		MS58	NBR	0,50
1/8"	T-GR.100.1,8	1,8	1,6	0.....16		-10.....80		MS58	NBR	0,50
1/8"	T-GR.100.2,5	2,5	3,2	0.....12		-10.....80		MS58	NBR	0,50
1/8"	T-GR.100.4	4	6,4	0.....9		-10.....80		MS58	NBR	0,50
1/8"	T-GR.100.5	5	9,2	0.....7		-10.....80		MS58	NBR	0,50
1/4"	T-GR.101	3	4,6	0.....10		-10.....80		MS58	NBR	0,49
1/4"	T-GR.101.1	1	0,6	0.....100		-10.....80		MS58	NBR	0,49

1/4"	T-GR.101.1,8	1,8	1,6	0.....16	-10.....80	MS58	NBR	0,49
1/4"	T-GR.101.2,5	2,5	3,2	0.....12	-10.....80	MS58	NBR	0,49
1/4"	T-GR.101.4	4	6,4	0.....9	-10.....80	MS58	NBR	0,49
1/4"	T-GR.101.5	5	9,2	0.....7	-10.....80	MS58	NBR	0,49
1/4"	T-GR.101.6	6	11	0.....5	-10.....80	MS58	NBR	0,49
1/4"	T-GR.101.7	7	12,4	0.....4	-10.....80	MS58	NBR	0,49

NORMALLY OPEN 2/2 WAY

Size	Type No:	Orifice	Kv	Pressure (bar)		Temp (°C)		Body	Seal	Net Weight
				Min	Max	Min	Max			
G	T-GTR.N Series	(mm)	(lt/min)					Brass	---	(kg)
1/8"	T-GR.N100	1,8	1,6	0.....12		-10.....80		MS58	NBR	0,51
1/8"	T-GR.N100.2,5	2,5	3,2	0.....10		-10.....80		MS58	NBR	0,51
1/8"	T-GR.N100.3	3	4,6	0.....5		-10.....80		MS58	NBR	0,51
1/4"	T-GR.N101	1,8	1,6	0.....12		-10.....80		MS58	NBR	0,5
1/4"	T-GR.N101.2,5	2,5	3,2	0.....10		-10.....80		MS58	NBR	0,5
1/4"	T-GR.N101.3	3	4,6	0.....5		-10.....80		MS58	NBR	0,5

DIMENSIONS

Test Standarts

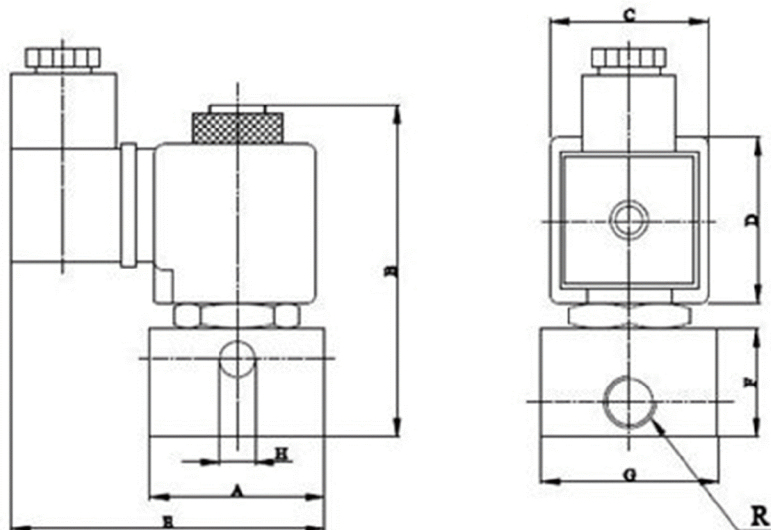

EN12516-2, EN1266-1,
EN12516-3

PN10 bar (test 16 bar)

PN16 bar (test 25 bar)

PN25 bar (test 40 bar)

PN40 bar (test 60 bar)

DIN 2401

R	A	B	C	D	E	F	G	H
1/8"	35	78.5	32	39	68	26.5	35	Ø6
1/4"	35	78.5	32	39	68	26.5	35	Ø6

spare parts coil 12 VA

spare parts coil 17 VA



...type no	voltage
T-SB10	220/230 V AC
T-SB11	110V AC
T-SB13	24 V AC
T-SB14	12 V AC
T-SB15	24 V DC
T-SB16	12 V DC

...type no	voltage
T- SB10.1	220/230 V AC
T-SB11.1	110V AC
T-SB13.1	24 V AC
T-SB14.1	12 V AC
T-SB15.1	24 V DC
T-SB16.1	12 V DC



T-GR.3W Series Plate Mount Way Solenoid Valve



Product code : T-GR.3W100..T-GR.3W100

Brand : TORK

T-GR.3W Series Plate Mount Way Solenoid Valve

TORK Brass Body, Direct Operated, 3/2 Way, Solenoid Valves

T-GR.3W Series	normally closed position
Application :	air, water, gas, valve controller
Coil voltage :	230, 220V, 110V, 24V, 12V AC, 24V, 12V DC
Coil protection class:	IP 65 with plug
Way :	3/2 way, normally closed
Seal :	PTFE, teflon, on request ; FKM, NBR, EPDM
Body of valve :	brass
Tube, internal parts :	stainless steel

Size	Type No:(N.C)	Orifice	Kv	Pressure		Temp		Body	Seal	Net Weight
				Min	Max	Min	Max			
G	T-GR.3W Series	(mm)	(lt/min)					Brass	---	(kg)
1/8"	T-GR.3W.100.1,8	1,8	1-2=1,35, 2-3=1,35	0.....12		-10.....80		MS58	NBR	0,50
1/8"	T-GR.3W.100.2,5	2,5	1-2=2,7, 2-3=1,35	0.....10		-10.....80		MS58	NBR	0,50
1/4"	T-GR.3W.101.	1,8	1-2=1,35, 2-3=1,35	0.....12		-10.....80		MS58	NBR	0,49
1/4"	T-GR.3W.101.2,5	2,5	1-2=2,7, 2-3=1,35	0.....10		-10.....80		MS58	NBR	0,49

Size	Type No:(N.O)	Orifice	Kv	Pressure	Temp	Body	Seal	Net Weight
------	---------------	---------	----	----------	------	------	------	------------

EL

News

Ελεγκόμενος
Electrolux
 Macedonia
 Palenzo

G	T-GR.3W Series	(mm)	(lt/min)	Min	Max	Min	Max	Brass	---	(kg)
1/8"	T-GR.3W.N100	1,8	1-2=1,35, 2-3=1,35	0.....12	-10.....80	MS58	NBR	0,51		
1/8"	T-GR.3W.N100.2,5	2,5	1-2=2,7, 2-3=1,35	0.....10	-10.....80	MS58	NBR	0,51		
1/4"	T-GR.3W.N101	1,8	1-2=1,35, 2-3=1,35	0.....12	-10.....80	MS58	NBR	0,50		
1/4"	T-GR.3W.N101.2,5	2,5	1-2=2,7, 2-3=1,35	0.....10	-10.....80	MS58	NBR	0,50		



Solenoid Valve, T-GY.3W Series 3/2 Way , Pneumatic Application N.C/ N.O



Product code : T-GY.3W.100, T-GY.3W.101

Brand : TORC

Solenoid Valve, T-GY.3W Series 3/2 Way , Pneumatic Application N.C/ N.O

TORC Direct Acting Solenoid Valves, Normally Closed and Normally Open Position

NORMALDE KAPALI ve NORMALDE AÇIK SOLENOİD VALF

T-GY.3W Series		3/2 way
Application	:	air, water, gas, pneumatic application, machines, oil
Coil voltage	:	230, 220V, 110V, 24V, 12V AC, 24V, 12V DC
Protection class	:	IP 65 with Plug
Way	:	3/2 Way, N.C and N.O
Tube, Internal Parts	:	complete stainless steel

Size	Type No:	Orifice (mm)	Kv (lt/min)	Pressure (bar)		Temp. (°C)		Body	Seal	Net Weight (kg)
				Min	Max	Min	Max			
1/8"	T-GY.3W.100	1,8	1,5	0.....	16	-10.....	160	MS58	VITON	0,44
1/8"	T-GY.3W.100.2,5	2,5	3	0.....	12	-10.....	160	MS58	VITON	0,44
1/8"	T-GY.3W.100.3,5	3,5	5	0.....	10	-10.....	160	MS58	VITON	0,44

1/4"	T-GY.3W.101	1,8	1,5	0.....16	-10.....160	MS58	VITON	0,43
1/4"	T-GY.3W.101.2,5	2,5	3	0.....12	-10.....160	MS58	VITON	0,43
1/4"	T-GY.3W.101.3,5	3,5	5	0.....10	-10.....160	MS58	VITON	0,43

spare parts coils 12 VA

spare parts coils 17 VA



tip no	voltaj
T-SB10	220/230 V AC
T-SB11	110V AC
T-SB13	24 V AC
T-SB14	12 V AC
T-SB15	24 V DC
T-SB16	12 V DC



tip no	voltaj
T-SB10.1	220/230 V AC



Solenoid Valve T-G.3W Direct Acting Solenoid Valves, 3/2 Way



Product code : T-G.3W 100, T-G.3W101

Brand : TORK

Solenoid Valve T-G.3W Direct Acting Solenoid Valves, 3/2 Way

[TORK Direct Acting , 3/2 Way Solenoid Valves, Normally Closed Position](#)

T-G.3W Series

Application : air, water, gas, compressor, pneumatic application, valves control

Coil Voltage : 230, 220V, 110V, 24V, 12V AC, 24V, 12V DC

Protection Class : IP 65 with plug

Position : N.C , on request: N.O.

Tube, Internal Parts : stainless steel

[TORK Direct Acting , 3/2 Way Solenoid Valves, Normally Closed Position](#)

Size	Type No:	Orifice (mm)	Kv (Lt/min)	Pressure		Temp.		Body	Seal	Weight (kg)
				Min	Max	Min	Max			
1/8"	T-G.3W.100	1,8	1-2=1,35, 2-3=1,35	0.....12		-10.....80		MS58	NBR	0,37
1/8"	T-G.3W.100.2,5	2,5	1-2=2,7, 2-3=1,35	0.....10		-10.....80		MS58	NBR	0,37
1/4"	T-G.3W.101.	1,8	1-2=1,35, 2-3=1,35	0.....12		-10.....80		MS58	NBR	0,36
1/4"	T-G.3W.101.2,5	2,5	1-2=2,7, 2-3=1,35	0.....10		-10.....80		MS58	NBR	0,36

TORK T-G.3W .N100 serie normally open 3/2 solenoid valve

size	type no	orifice	pressure	temperature	body	seal
G	T-G3W.N serie	mm	bar	°C	brass	--
1/8"	T-G.3W.N100	1,8	0..10	-10..80	MS58	NBR
1/8"	T-G.3W.N100	2,5	0..12	-10..80	MS58	
1/4"	T-G.3W.N101	1,8	0..12	-10..80	MS58	
1/4"	T-G.3W.N101	2,5	0..10	-10..80	MS58	

Coil T-SB1 serie 12 VA



....type no voltage

T-SB10 220/230 V AC

T-SB11 110V AC

T-SB13 24 V AC

T-SB14 12 V AC

T-SB15 24 V DC

T-SB16 12 V DC

Coil T-SB2 serie 17 VA



.....type no voltage

T-SB10.1 220/230 V AC

T-G.3W 100, 101 3/2 way, normally closed

T-G.3W N100, N101 3/2 way normally open

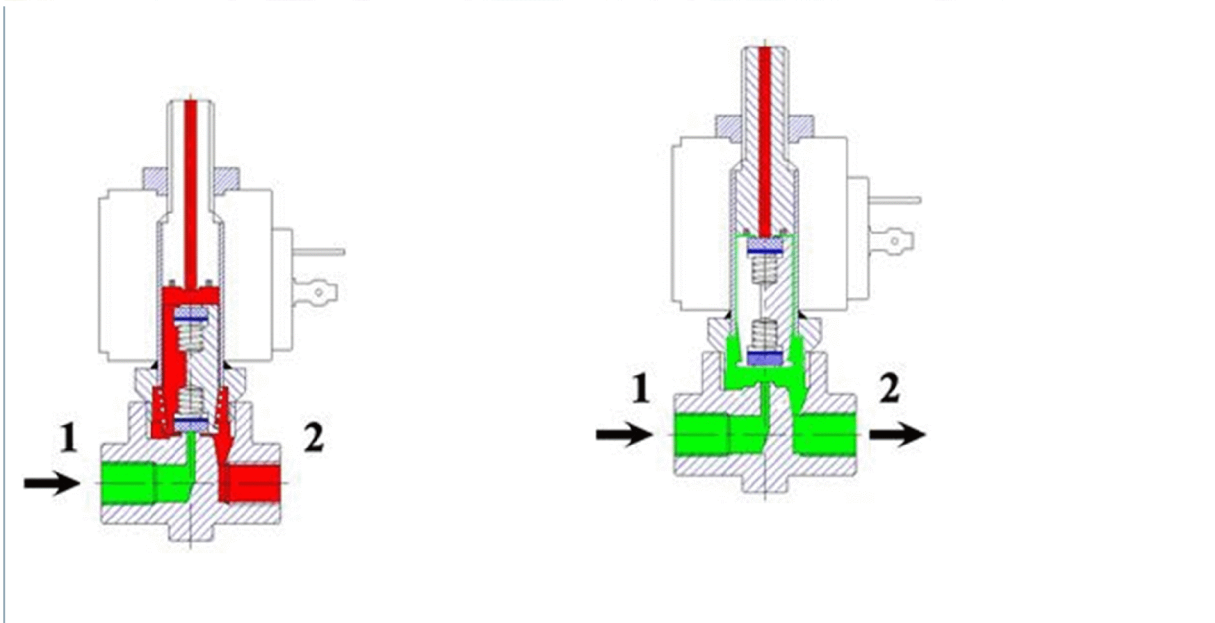



T-GL Series Full Orifice, Pilot Operated Solenoid Valves N.C / N.O.



Product code : T-GL102...108(N.K) ve T-GLN102...108(N.A)

Brand : TORK

T-GL Series Full Orifice, Pilot Operated Solenoid Valves N.C / N.O.

FULL ORIFICE,
 GENERAL PORPUSE SOLENOID VALVE
 2/2 WAY PILOT OPERATED
 3/8" , 3" (N.C / N.O)

T-GL 102

.....

T-GL 110

for; air, water, gas

TORK pilot operated solenoid valve(full orifice)

T-GL series normally closed

T-GLN series normally open

T-GL 102.....T-GL110 Series

Application	:	air, gas, water, non agresive fluid
Coil Voltage	:	230, 220V, 110V, 24V, 12V AC, 24V, 12V DC (specify on request)
Protection Class	:	IP 65 with plug
Seal	:	NBR , on request: EPDM, VITON
Way	:	2/2 two way
Tube, Internal Parts	:	stainless steel



T-GL Normally Closed Solenoid Valves:

Size	Type No	Orifice	Kv	Pressure (bar)		Temp.(°C)		Body	Seal	Net Weight
				Min	Max	Min	Max			
G	T-GL Series	(mm)	(lt/min)	Min	Max	Min	Max	Brass	---	(kg)
3/8"	T-GL 102	12,5	45	0,35.....16		-10.....80		MS58	NBR	0,66
1/2"	T-GL 103	12,5	65	0,35.....16		-10.....80		MS58	NBR	0,64
3/4"	T-GL 104	20	120	0,5.....16		-10.....80		MS58	NBR	0,66
1"	T-GL 105	25	170	0,5.....16		-10.....80		MS58	NBR	0,8
1 1/4"	T-GL 106	46	390	0,5.....12		-10.....80		MS58	NBR	2,65
1 1/2"	T-GL 107	46	460	0,5.....12		-10.....80		MS58	NBR	2,55
2"	T-GL 108	46	580	0,5.....12		-10.....80		MS58	NBR	2,98
2 1/2"	T-GL 109	72,8	1266	1.....6		-10.....80		---	NBR	5,9
3"	T-GL 110	85,4	2333	1.....6		-10.....80		---	NBR	10,15

T-GLN Normally Open Solenoid Valves:

Size	Type No	Orifice	Kv	Pressure (bar)		Temp.(°C)		Body	Seal	Net Weight
				Min	Max	Min	Max			
G	T-GLN Series	(mm)	(lt/min)	Min	Max	Min	Max	Brass	---	(kg)
3/8"	T-GLN102	12,5	45	0,35.....12		-10.....80		MS58	NBR	0,69
1/2"	T-GLN103	12,5	65	0,35.....12		-10.....80		MS58	NBR	0,66
3/4"	T-GLN104	20.	120	0,5.....12		-10.....80		MS58	NBR	0,67
1"	T-GLN105	25.	170	0,5.....12		-10.....80		MS58	NBR	0,81
1 1/4"	T-GLN106	46	390	0,5.....10		-10.....80		MS58	NBR	2,66
1 1/2"	T-GLN107	46	460	0,5.....10		-10.....80		MS58	NBR	2,56
2"	T-GLN108	46	580	0,5.....10		-10.....80		MS58	NBR	2,99
2 1/2"	T-GLN109	65	...	0,3.....16		-10.....80		MS58	NBR	---

EL
News

Electrolux
Macedonia
Palenzo

3" T-GLN110 80 ... 0,3.....16 -10.....80 MS58 NBR ---



T-GLF Series Flanged Solenoid Valve



Product code : T-GLF
 Brand : TORK

T-GLF Series Flanged Solenoid Valve

flanged connection, pilot operated solenoid valve
 T-GLF series normally closed
 T-GLNF series normally open

Application : air, gas, water, non agressive fluid
 Coil Voltage : 230, 220V, 110V, 24V, 12V AC, 24V, 12V DC (specify on request)
 Protection Class : IP 65 with plug
 Seal : NBR , on request: EPDM, VITON
 Way : 2/2 two way
 Tube, Internal Parts : stainless steel

normally closed position solenoid valve

Size	Type No (N.C)	Orifice	Kv	Pressure(bar)	Temperature(°C)	Body	Seal	Net Weight
G	T-GLF Series	(mm)	(lt/min)	Min Max	Min Max	Brass	---	(kg)
NW32	T-GLF 106	46	390	0,5.....12	-10.....80	MS58	NBR	6,65
NW40	T-GLF 107	46	460	0,5.....12	-10.....80	MS58	NBR	6,9
NW50	T-GLF 108	46	580	0,5.....12	-10.....80	MS58	NBR	8,6
G	Type No(N.C)	orifice	(lt/min)	min max	temperature(°C)	body	seal	net weigh
NW65	T-GLF 109	65	1.....6	-10.....80	cast iron	NBR		

NW80	T-GLF 110	80	1.....6	-10.....80	cast iron	NBR
NW65	T-GLHF 109	65	0,5.....16	-10.....80	cast iron	NBR
NW80	T-GLHF 110	80	0,5.....16	-10.....80	cast iron	NBR
T-GLF109 / T-GLF 110			T-GLF106 / 107 / 108 brass body			



normally open position solenoid valve

Size	Type No (N.O)	Orifice	Kv	Pressure(bar)		Temperature(°C)		Body	Seal	Net Weight
				Min	Max	Min	Max			
G	T-GLNF Series	(mm)	(lt/min)	Min	Max	Min	Max	Brass	---	(kg)
NW32	T-GLNF 106	46	390	0,5.....12		-10.....80		MS58	NBR	6,65
NW40	T-GLNF 107	46	460	0,5.....12		-10.....80		MS58	NBR	6,9
NW50	T-GLNF 108	46	580	0,5.....12		-10.....80		MS58	NBR	8,6



T-GN Series Direct Acting Solenoid Valves N.O



Product code : T-GN100, T-GN101

Brand : TORK

T-GN Series Direct Acting Solenoid Valves N.O

TORK Direct Acting Solenoid Valves

T-GN Series **Normally Open Position**

Application : air, water, gas, non agresiv media

Body : brass

Coil Voltage : 230, 220V, 110V, 24V, 12V AC, 24V, 12V DC (specify on order)

Protection Class : IP 65 soketli

Tube, Internal Parts : stainless steel

Size	Type No:	Orifice	Kv	Pressure (bar)		Temp. (°C)		Body	Seal	Net Weight
				Min	Max	Min	Max			
G	T-GN Series	(mm)	(lt/min)					Brass	---	(kg)
1/8"	T-GN.100	1.8	1,6	0.....12		-10.....80		MS58	NBR	0,38
1/8"	T-GN.100.2,5	2,5	3,2	0.....10		-10.....80		MS58	NBR	0,38
1/8"	T-GN.100.3	3	4,6	0.....5		-10.....80		MS58	NBR	0,38
1/4"	T-GN.101	1,8	1,6	0.....12		-10.....80		MS58	NBR	0,37
1/4"	T-GN.101.2,5	2,5	3,2	0.....10		-10.....80		MS58	NBR	0,37
1/4"	T-GN.101.3	3	4,6	0.....5		-10.....80		MS58	NBR	0,37



T-GN Series, Pilot Operated Solenoid Valves. N.O



Product code : T-GN103...T-GN108

Brand : TORK

T-GN Series, Pilot Operated Solenoid Valves. N.O

TORK Pilot Operated Solenoid Valves, Internal Control, Without Copper Pipe, Normally Open Position

T-GN Series

Application	:	air, water, gas, non aggressive media
Coil voltage	:	230, 220V, 110V, 24V, 12V AC, 24V, 12V DC
Position	:	Normally Open
Protection class	:	IP 65 with plug
Diaphragm	:	NBR , on request EPDM, VITON
Tube, Internal parts	:	stainless steel

Size	Type No:	Orifice (mm)	Kv (lt/min)	Pressure (bar)		Temp. (°C)		Body	Seal	Net Weight (kg)
				Min	Max	Min	Max			
3/8"	T-GN102	12,5	48	0,5.....12		-10.....80		MS58	NBR	0,69
1/2"	T-GN103	14,5	70	0,5.....12		-10.....80		MS58	NBR	0,72
3/4"	T-GN104	17	85	0,5.....12		-10.....80		MS58	NBR	0,81
1"	T-GN105	17	90	0,5.....12		-10.....80		MS58	NBR	0,98
1 1/4"	T-GN106	46	390	0,5.....10		-10.....80		MS58	NBR	2,66
1 1/2"	T-GN107	46	460	0,5.....10		-10.....80		MS58	NBR	2,56



EL
News

Electrolux
Macedonia
Palenzo

2" T-GN108 46 580 0,5.....10 -10.....80 MS58 NBR 2,99



T-GPA Series Pilot Operated Solenoid Valves N.O



Product code : T-GPA102.....T-GPA107

Brand : TORK

T-GPA Series Pilot Operated Solenoid Valves N.O

TORK Pilot Operated Solenoid Valves, Normally Open Position

T-GPA Series	:	Normally Open Position
Application	:	air, water, gas, non agrasiv media, oil
Coil voltage	:	230, 220V, 110V, 24V, 12V AC, 24V, 12V DC(specify coil voltage on order)
Protection class	:	IP 65 with plug
Diaphragm	:	NBR , onrequest EPDM, VITON
Way	:	2/2 way, normally open position
Tube, Internal Parts	:	stainless steel

Size	Type No:	Orifice (mm)	Kv (lt/min)	Pressure (bar)		Temp. (°C)		Body	Seal	Net Weight (kg)
				Min	Max	Min	Max			
3/8"	T-GPA102	12,5	48	0,5.....16	-10.....80	MS58	NBR	0,70		
1/2"	T-GPA103	14,5	70	0,5.....16	-10.....80	MS58	NBR	0,73		
3/4"	T-GPA104	17	85	0,5.....16	-10.....80	MS58	NBR	0,81		
1"	T-GPA105	17	90	0,5.....16	-10.....80	MS58	NBR	0,99		
1 1/4"	T-GPA106	46	390	0,5.....12	-10.....80	MS58	NBR	2,72		
1 1/2"	T-GPA107	46	460	0,5.....12	-10.....80	MS58	NBR	2,60		

EL
News

Electrolux
Macedonia
Palenzo

2" T-GPA108 46 ... 0,5.....16 -10.....80 MS58 NBR 3,04



T-GZ Series Solenoid Valves Zero Differential Pressure, (3/8" ..1") N.C.



Product code : T-GZ103.....T-GZ105

Brand : TORK

T-GZ Series Solenoid Valves Zero Differential Pressure, (3/8" ..1") N.C.

[TORK, No Need Differential Pressure for Valve Operation \(0 bar inlet\)](#)

T-GZ Series : pilot operated, no need differential pressure, N.C

Application : air, water, gas, oil...

Coil voltage : 230, 220V, 110V, 24V, 12V AC, 24V, 12V DC

Protection class : IP 65 with plug

Seal : NBR , on request EPDM, VITON

Way : 2/2 way, normally closed, solenoid valve

Tube, Internal parts : stainless steel

Size	Type No:	Orifice (mm)	Kv (lt/min)	Pressure(bar)		Temp. (°C)		Body	Seal	Net Weight (kg)
				Min	Max	Min	Max			
3/8"	T-GZ102	12,5	38	0.....16	-10.....80	MS58	NBR	0,69		
1/2"	T-GZ103	14,5	62	0.....16	-10.....80	MS58	NBR	0,72		
3/4"	T-GZ104	17	85	0.....16	-10.....80	MS58	NBR	0,80		
1"	T-GZ105	17	100	0.....16	-10.....80	MS58	NBR	0,98		



T-GZN Series Solenoid Valve Zero Differential Pressure, N.O



Product code : T-GZ.N103.....T-GZ.N105

Brand : TORK

T-GZN Series Solenoid Valve Zero Differential Pressure, N.O

[TORK, for Valve Operation \(0 bar inlet\) Pilot Operated Solenoid Valves, Normally OPEN Position](#)

T-GZ Series		NO DIFFERENTIAL PRESSURE REQUEST, N.O
Application	:	air, water, gas, oil...
Coil voltage	:	230, 220V, 110V, 24V 12V AC, 24V, 12V DC
Protection class	:	IP 65 with plug
Seal	:	NBR , on request EPDM, VITON
Way	:	2/2 way, normally open, solenoid valve
Tube, Internal Parts	:	stainless steel

Size	Type No:	Orifice	Kv	Pressure (bar)		Temp. (°C)		Body	Seal	Net Weight
				Min	Max	Min	Max			
G	T-GZN Series	(mm)	(lt/min)	Min	Max	Min	Max	Brass	---	(kg)
3/8"	T-GZN102	12,5	38	0.....12		-10.....80		MS58	NBR	0,70
1/2"	T-GZN103	14,5	62	0.....12		-10.....80		MS58	NBR	0,73
3/4"	T-GZN104	17	85	0.....12		-10.....80		MS58	NBR	0,81
1"	T-GZN105	17	100	0.....12		-10.....80		MS58	NBR	0,99



T-GSL Series Solenoid Valve, Large Orifice, Small Size, High Pressure



Product code : T-GSL100,..... T-GSL101

Brand : TORK

T-GSL Series Solenoid Valve, Large Orifice, Small Size, High Pressure

TORK Small Size (1/8", 1/4") Pilot Operated, Large Orifice (12mm) , Solenoid Valves, Normally Closed Position or Normally Open Position Solenoid Valve

T-GSL Series: N.C/ N.O

Application : air, water, gas.oil

Coil voltage : 230, 220V, 110V, 24V, 12V AC, 24V, 12V DC

Protection class : IP 65 with plug

Seal : NBR , on request EPDM, VITON

Way : 2/2 way, normally closed, normally open solenoid valve

Tube, Internal Parts : stainless steel

Size	Type No:	Orifice	Kv	Pressure (bar)	Temp. (°C)	Body	Seal	Net Weight
G	T-GSL Series (N.C)	(mm)	(lt/min)	Min Max	Min Max	Brass	---	(kg)
1/8"	T-GSL100	12	18	0,5.....16	-10.....80	MS58	NBR	0,74
1/4"	T-GSL101	12	25	0,5.....16	-10.....80	MS58	NBR	0,72

Size	Type No:	Orifice	Kv	Pressure (bar)	Temp. (°C)	Body	Seal	Net Weight
G	T-GSLN Series (N.O)	(mm)	(lt/min)	Min Max	Min Max	Brass	---	(kg)
1/8"	T-GSLN 100	12,5	18	0,5.....16	-10.....80	MS58	NBR	0,75



EL
News

Electrolux
Macedonia
Palenzo

1/4" T-GSLN 101 12,5 25 0,5.....16 10.....80 MS58 NBR 0,73



T-GH Series High Pressure Solenoid Valve Normally Closed



Product code : T-GH 100.....105 (N.K)

Brand : TORK

T-GH Series High Pressure Solenoid Valve Normally Closed

[TORK, High Pressure Proses Lines, Pilot Operated Solenoid Valve](#)

[T-GH Series](#) normally closed position

Application : water, air, gas

Coil voltage : 230, 220V, 110V, 24V, 12V AC, 24V, 12V DC

Protection class : IP 65 soketli

Seal : NBR , on request EPDM, VITON

Way : 2/2 way normally closed position, solenoid valve

Tube, Internal Parts : stainless steel

[TORK, T-GH Series High Pressure Proses Lines, Pilot Operated Solenoid Valves](#)

Size	Type No:	Orifice	Kv	Pressure (bar)	Temp. (°C)	Body	Seal	Net Weight
G	T-GH Series	(mm)	(lt/min)	Min Max	Min Max	Brass	---	(kg)
3/8"	T-GH102	12,5	48	0,5.....40	-10.....160	MS58	PTFE+VITON	0,69
1/2"	T-GH103	14,5	70	0,5.....40	-10.....160	MS58	PTFE+VITON	0,73
3/4"	T-GH104	17	85	0,5.....40	-10.....160	MS58	PTFE+VITON	0,81



1" T-GH105 17 90 0,5.....40 -10.....160 MS58 PTFE+VITON 0,98

TORK T-GH Direct Acting Series Solenoid Valves

Size	Type No:	Orifice	Kv	Pressure (bar)		Temp. (°C)		Body	Seal	Net Weight
				Min	Max	Min	Max			
G	T-GH Series	(mm)	(Lt/min)					Brass	---	(kg)
1/8"	T-GH100.1	1	0,6	0.....100		-10.....160		MS58	VITON	0,36
1/8"	T-GH100.1,8	1,8	1,6	0.....50		-10.....160		MS58	VITON	0,36
1/8"	T-GH100.2,5	2,5	3,2	0.....20		-10.....160		MS58	VITON	0,36
1/4"	T-GH101.1	1	0,6	0.....100		-10.....160		MS58	VITON	0,35
1/4"	T-GH101.1,8	1,8	1,6	0.....50		-10.....160		MS58	VITON	0,35
1/4"	T-GH101.2,5	2,5	3,2	0.....20		-10.....160		MS58	VITON	0,35



T-GHA High Pressure Solenoid Valve , Normally Open



Product code : T-GHA 3/8".....1"

Brand : TORK

T-GHA High Pressure Solenoid Valve , Normally Open

TORK, High Pressure Proses Lines, Pilot Operated Solenoid Valve

T-GHA Series normally closed position , high pressure

Application : water, air, gas

Coil Voltage : 230, 220V, 110V, 24V, 12V AC, 24V, 12V DC

Protection Class : IP 65 soketli

Seal : NBR , on request EPDM, VITON

Way : 2/2 way normally closed position, solenoid valve

Tube, Internal Parts : stainless steel

Size	Type No:	Orifice (mm)	Kv (Lt/min)	Pressure(bar)		Temp. (°C)		Body	Seal	Net Weight (kg)
				Min	Max	Min	Max			
3/8"	T-GHA102	12,5	48	0,5.....	40	-10.....	160	MS58	PTFE+VITON	0,71
1/2"	T-GHA103	14,5	70	0,5.....	40	-10.....	160	MS58	PTFE+VITON	0,74
3/4"	T-GHA104	17	85	0,5.....	40	-10.....	160	MS58	PTFE+VITON	0,82
1"	T-GHA105	17	90	0,5.....	40	-10.....	160	MS58	PTFE+VITON	0,99



T-MI Series Low Power Coil Solenoid Valves 5 Watt Coil



Product code : T-MI.100.....T-MI.105

Brand : TORC

T-MI Series Low Power Coil Solenoid Valves 5 Watt Coil

TORC, Low Power Coil (5watt) , Pilot Operated Solenoid Valves

T-MI Series normally closed position

Application : air, water, gas, kompressor machines, oil, CNC machines, automation systems

Coil Voltage : 230, 220V, 110V, 24V, 12V AC, 24V, 12V DC, (5 WATT coil power)

Protection Class : IP 65 with plug

Diaphragm : NBR , on request EPDM, VITON, FKM

Normally Open : it is made on request and used only air and inert gas

Way : 2/2 two way normally closed solenoid valve

Valve Body : brass MS 58

Tube, Internal Parts : stainless steel

Normally Closed Type

Size	Type no	Orifice (mm)	Kv (lt/min)	Pressure		Temperature		Body	Seal	Net Weight (kg)
				Min	Max	Min	Max			
1/8"	T-MI.100	1,8	1,6	0.....16	-10.....160	MS58	VITON	0,20		
1/8"	T-MI.100.2,5	2,5	3,2	0.....10	-10.....160	MS58	VITON	0,20		
1/8"	T-MI.100.3	3	4,6	0.....6	-10.....160	MS58	VITON	0,20		

EL

News

ΕΛΛΗΝΙΚΗ
Electrolux
 Macedonia
 Palenzo

1/8"	T-MI.100.4	4	6,4	0.....2,5	-10.....160	MS58	VITON	0,20
1/4"	T-MI.101	1,8	1,6	0.....16	-10.....160	MS58	VITON	0,19
1/4"	T-MI.101.2,5	2,5	3,2	0.....10	-10.....160	MS58	VITON	0,19
1/4"	T-MI.101.3	3	4,6	0.....6	-10.....160	MS58	VITON	0,19
1/4"	T-MI.101.4	4	6,4	0.....2,5	-10.....160	MS58	VITON	0,19
1/4"	T-MIÖ.101	1,8	1,6	0.....16	-10.....160	MS58	VITON	0,21
1/4"	T-MI.3W 101	1,8	1-2=1,35 , 2-3=0,5	0.....12	-10.....160	MS58	VITON	0,19
3/8"	T-MI.102	12	40	0,35.....12	-10.....80	MS58	VITON	0,42
1/2"	T-MI.103	12	58	0,35.....12	-10.....80	MS58	NBR	0,40
3/4"	T-MI.104	15	75	0,35.....12	-10.....80	MS58	NBR	0,60
1"	T-MI.105	15	90	0,35.....12	-10.....80	MS58	NBR	0,80



T-GMW Series Hose Connection Solenoid Valve



Product code : T-GMW 101 ,6mm hortum bağlantılı

Brand : TORK

T-GMW Series Hose Connection Solenoid Valve

TORK Hose Connection, Direct Operated, Solenoid Valves, Normally Closed Position

T-GMW Series N.C. hose connection solenoid valve

Application	:	water, air, gas
Coil voltage	:	230, 220V, 110V, 24V, 12V AC, 24V, 12V DC
Protection class	:	IP 65 with plug
Seal	:	NBR , on request EPDM, VITON
Way	:	2/2 way normally closed position, solenoid valve
Valve body	:	brass, MS58
Tube, Internal Parts	:	stainless steel

Size	Type No	Orifice (mm)	Pressure (bar)		Temp.(°C)		Body	Seal
			Min	Max	Min	Max		
1/8"	T-GMW.100.8		MS58	NBR
1/8"	T-GMW.100.5	5	0.....	7	-10.....	80	MS58	NBR
1/8"	T-GMW.100.7	7	0.....	5	-10.....	80	MS58	NBR

T-IZ Series Insulation Solenoid Valve



Product code : T-IZ101.....T-IZ103

Brand : TORQ

T-IZ Series Insulation Solenoid Valve

TORQ Direct Acting Isolation Solenoid Valve, Normally Closed Position,
fluid does not touch to metal part of solenoid valve

application : aggressive fluid, water, acid

coil voltage : 230, 220V, 110V, 24V, 12V AC, 24V, 12V DC

protection class : IP 65 with plug

tube and internal parts: stainless steel

Size	Type No	Way	Kv
G	T-IZ Series	--	(Lt/min)
1/8"	T-IZ100	2/2	1,6
1/8"	T-IZ100.2,5	2/2	3,2
1/8"	T-IZ100.4	2/2	6,4
1/4"	T-IZ101	2/2	1,6
1/4"	T-IZ100.2,5	2/2	3,2
1/4"	T-IZ101.4	2/2	6,4
1/4"	T-IZ101.5	2/2	9,2
1/4"	T-IZ101.6	2/2	11

EL

News

Electrolux
Macedonia
Palenzo

1/4"	T-IZ101.7	2/2	12,4
3/8"	T-IZ102.5	2/2	9,2
3/8"	T-IZ102.6	2/2	11
3/8"	T-IZ102.7	2/2	12,4
1/2"	T-IZ103.5	2/2	9,2
1/2"	T-IZ103.6	2/2	11
1/2"	T-IZ103.7	2/2	12,4

Electrolux Macedonia
Bitola/Europe
+389(0)47 203 330

www.electrolux.mk www.elektroluks.mk www.elektroluks.eu
electrolux@t-home.mk elektroluks@t-home.mk



T-GRS Series Pleyt Mounting 2/2 Way Solenoid Valve NC / NO



Product code : T-GRS 100.....T-GRS101

Brand : TORC

T-GRS Series Pleyt Mounting 2/2 Way Solenoid Valve NC / NO

TORC Stainless Steel Body Direct Operated 2/2 Way Solenoid Valves

T-GRS Series	normally closed position, stainless steel body
Application :	aggressive fluid, air, water, gas, valve controller
Coil Voltage :	230, 220V, 110V, 24V, 12V AC, 24V, 12V DC
Coil Protection Class:	IP 65 with plug
Way :	2/2 way, normally closed (on request N.O position)
Seal :	PTFE, teflon, on request ; FKM, NBR, EPDM
Tube, Internal Parts :	stainless steel

Size	Type No	Orifice (mm)	Kv (Lt/min)	Pressure		Temp.		Body	Seal	Net Weight (kg)
				Min	Max	Min	Max			
1/8"	T-GRS.100	3	4,6	0.....10	-10.....160	stainless steel	TEFLON	0,47		
1/8"	T-GRS.100.1	1	0,6	0.....100	-10.....160	stainless steel	TEFLON	0,47		
1/8"	T-GRS.100.1,8	1,8	1,6	0.....16	-10.....160	stainless steel	TEFLON	0,47		
1/8"	T-GRS.100.2,5	2,5	3,2	0.....12	-10.....160	stainless steel	TEFLON	0,47		
1/8"	T-GRS.100.4	4	6,4	0.....9	-10.....160	stainless steel	TEFLON	0,47		
1/8"	T-GRS.100.5	5	9,2	0.....7	-10.....160	stainless steel	TEFLON	0,47		

EL

News

Electrolux
Macedonia
Palenzo

1/4" T-GRS.101	3	4,6	0.....10	-10.....160	stainless steel	TEFLON	0,46
1/4" T-GRS.101.1	1,8	0,6	0.....100	-10.....160	stainless steel	TEFLON	0,46
1/4" T-GRS.101.1,8	1,8	1,6	0.....16	-10.....160	stainless steel	TEFLON	0,46
1/4" T-GRS.101.2,5	2,5	3,2	0.....12	-10.....160	stainless steel	TEFLON	0,46
1/4" T-GRS.101.4	4	6,4	0.....9	-10.....160	stainless steel	TEFLON	0,46
1/4" T-GRS.101.5	5	9,2	0.....7	-10.....160	stainless steel	TEFLON	0,46
1/4" T-GRS.101.6	6	11	0.....5	-10.....160	stainless steel	TEFLON	0,46
1/4" T-GRS.101.7	7	12,4	0.....4	-10.....160	stainless steel	TEFLON	0,46

Size	Type No	Orifice	Kv	Pressure		Temp.		Body	Seal	Net Weight
G	T-GRS Series	(mm)	(Lt/min)	Min	Max	Min	Max	Brass	---	(kg)
1/8"	T-GRS.N100	1,8	1,6	0.....12	-10.....160	stainless steel	TEFLON	0,48		
1/8"	T-GRS.N100.2,5	2,5	3,2	0.....10	-10.....160	stainless steel	TEFLON	0,48		
1/8"	T-GRS.N100.3	3	4,6	0.....5	-10.....160	stainless steel	TEFLON	0,48		
1/4"	T-GRS.N101	1,8	1,6	0.....12	-10.....160	stainless steel	TEFLON	0,47		
1/4"	T-GRS.N101.2,5	2,5	3,2	0.....10	-10.....160	stainless steel	TEFLON	0,47		
1/4"	T-GRS.N101.3	3	4,6	0.....5	-10.....160	stainless steel	TEFLON	0,47		



T-GRS.3W Pleyt Mounting 3/2 Way Solenoid Valve



Product code : T-GRS.3W ,üç yollu pleyt montajlı

Brand : TORK

T-GRS.3W Pleyt Mounting 3/2 Way Solenoid Valve

[TORK Stainless Steel Body, Direct Operated 3/2 Way Solenoid Valves](#)

[T-GRS.3W Series](#) , normally closed position

Application : aggressive fluid, air, water, gas, valve controller

Coil Voltage : 230, 220V, 110V, 24V, 12V AC, 24V, 12V DC

Coil Protection Class : IP 65 with plug

Way : 3/2 way, normally closed

Seal : PTFE, teflon, on request ; FKM, NBR , EPDM

Body of Valve : stainless steel 304 aisi / 316 AISI

Tube, Internal Part : stainless steel

Size	Type No (N.C)	Orifice	Kv	Pressure	Temp.	Body	Seal	Net Weight		
G	T-GRS Series	(mm)	(Lt/min)	Min	Max	Min	Max	Brass	---	(kg)
1/8"	T-GRS.3W.100	1,8	1-2=1,35, 2-3=1,35	0.....12	-10.....160	stainless	TEFLON	0,47		
1/8"	T-GRS.3W.100.2,5	2,5	1-2=2,7, 2-3=1,35	0.....10	-10.....160	stainless	TEFLON	0,47		
1/4"	T-GRS.3W.101	1,8	1-2=1,35, 2-3=1,35	0.....12	-10.....160	stainless	TEFLON	0,46		
1/4"	T-GRS.3W.101.2,5	2,5	1-2=2,7, 2-3=1,35	0.....10	-10.....160	stainless	TEFLON	0,46		



Size	Type No (N.O)	Orifice	Kv	Pressure	Temp.	Seal	Net Weight		
G	T-GRSN.3W Series	(mm)	(Lt/min)	Min	Max	Min	Max	---	(kg)
1/8"	T-GRSN.3W.100	1,8	1-2=1,35, 2-3=1,35	0.....12	-10.....160	TEFLON	0,48		
1/8"	T-GRSN.3W.100.2,5	2,5	1-2=2,7, 2-3=1,35	0.....10	-10.....160	TEFLON	0,48		
1/4"	T-GRSN.3W.101	1,8	1-2=1,35, 2-3=1,35	0.....12	-10.....160	TEFLON	0,47		
1/4"	T-GRSN.3W.101.2,5	2,5	1-2=2,7, 2-3=1,35	0.....10	-10.....160	TEFLON	0,47		



T-GF Series Brass Body, Direct Operated Group Solenoid Valve



Product code : T-GF 100,T-GF101

Brand : TORK

T-GF Series Brass Body, Direct Operated Group Solenoid Valve

TORK Brass Body Direct Operated, 2/2 Way Solenoid Valves

T-GF Series	normally closed position
Application :	air, water, gas
Coil Voltage :	230, 220V, 110V, 24V, 12V AC, 24V, 12V DC
Coil Protection :	IP 65 with plug
Way :	2/2 way. N.C, 3 solenoid valve group
Seal :	on-request; NBR, EPDM
Internal Part :	stainless steell

Size	Type No	explication	Orifice	Kv	Pressure (bar)	Temp.(°C)	Body	Seal	Weight
G	T-GF Series (N.C)	input/output	(mm)	(Lt/min)	Min Max	Min Max	Brass	---	(kg)
1/8"	T-GF.100-1-2	1g-2g	1,8	1,45	0.....16	-10.....80	piring	NBR	1,05
1/8"	T-GF.100-1-3	1g-3ç	1,8	1,45	0.....16	-10.....80	piring	NBR	1,55
1/8"	T-GF.100-1-4	1g-4ç	1,8	1,45	0.....16	-10.....80	piring	NBR	2,05
1/8"	T-GF.100-2-1	2g-1ç	1,8	1,45	0.....16	-10.....80	piring	NBR	0,87

EL

News

Електролюкс
Macedonia
Palenzo

1/8"	T-GF.100-3-1	3g-1ç	1,8	1,45	0.....16	-10.....80	pirinç NBR	1,25
1/8"	T-GF.100-4-1	4g-1ç	1,8	1,45	0.....16	-10.....80	pirinç NBR	1,48
1/4"	T-GF.101-1-2	1g-2ç	1,8	1,45	0.....16	-10.....80	pirinç NBR	0,95
1/4"	T-GF.101-1-3	1g-3ç	1,8	1,45	0.....16	-10.....80	pirinç NBR	1,45
1/4"	T-GF.101-1-4	1g-4ç	1,8	1,45	0.....16	-10.....80	pirinç NBR	1,95
1/4"	T-GF.101-2-1	2g-1ç	1,8	1,45	0.....16	-10.....80	pirinç NBR	0,77
1/4"	T-GF.101-3-1	3g-1ç	1,8	1,45	0.....16	-10.....80	pirinç NBR	1,15
1/4"	T-GF.101-4-1	4g-1ç	1,8	1,45	0.....16	-10.....80	pirinç NBR	1,38
1/8"	T-GF.100.2,5-1-2	1g-2ç	2,5	2,8	0.....12	-10.....80	pirinç NBR	1,05
1/8"	T-GF.100.2,5-1-3	1g-3ç	2,5	2,8	0.....12	-10.....80	pirinç NBR	1,55
1/8"	T-GF.100.2,5-1-4	1g-4ç	2,5	2,8	0.....12	-10.....80	pirinç NBR	2,05
1/8"	T-GF.100.2,5-2-1	2g-1ç	2,5	2,8	0.....12	-10.....80	pirinç NBR	0,87
1/8"	T-GF.100.2,5-3-1	3g-1ç	2,5	2,8	0.....12	-10.....80	pirinç NBR	1,25
1/8"	T-GF.100.2,5-4-1	4g-1ç	2,5	2,8	0.....12	-10.....80	pirinç NBR	1,48
1/4"	T-GF.101.2,5-1-2	1g-2ç	2,5	2,8	0.....12	-10.....80	pirinç NBR	0,95
1/4"	T-GF.101.2,5-1-3	1g-3ç	2,5	2,8	0.....12	-10.....80	pirinç NBR	1,45
1/4"	T-GF.101.2,5-1-4	1g-4ç	2,5	2,8	0.....12	-10.....80	pirinç NBR	1,95
1/4"	T-GF.101.2,5-2-1	2g-1ç	2,5	2,8	0.....12	-10.....80	pirinç NBR	0,77
1/4"	T-GF.101.2,5-3-1	3g-1ç	2,5	2,8	0.....12	-10.....80	pirinç NBR	1,15
1/4"	T-GF.101.2,5-4-1	4g-1ç	2,5	2,8	0.....12	-10.....80	pirinç NBR	1,38
1/8"	T-GF.100.3-1-2	1g-2ç	3	4	0.....10	-10.....80	pirinç NBR	1,05
1/8"	T-GF.100.3-1-3	1g-3ç	3	4	0.....10	-10.....80	pirinç NBR	1,55
1/8"	T-GF.100.3-1-4	1g-4ç	3	4	0.....10	-10.....80	pirinç NBR	2,05
1/8"	T-GF.100.3-2-1	2g-1ç	3	4	0.....10	-10.....80	pirinç NBR	0,87

EL

News

Електролюкс
Macedonia
Palenzo

1/8"	T-GF.100.3-3-1	3g-1ç	3	4	0.....10	-10.....80	pirinç	NBR	1,25
1/8"	T-GF.100.3-4-1	4g-1ç	3	4	0.....10	-10.....80	pirinç	NBR	1,48
1/4"	T-GF.101.3-1-2	1g-2ç	3	4	0.....10	-10.....80	pirinç	NBR	0,95
1/4"	T-GF.101.3-1-3	1g-3ç	3	4	0.....10	-10.....80	pirinç	NBR	1,45
1/4"	T-GF.101.3-1-4	1g-4ç	3	4	0.....10	-10.....80	pirinç	NBR	1,95
1/4"	T-GF.101.3-2-1	2g-1ç	3	4	0.....10	-10.....80	pirinç	NBR	0,77
1/4"	T-GF.101.3-3-1	3g-1ç	3	4	0.....10	-10.....80	pirinç	NBR	1,15
1/4"	T-GF.101.3-4-1	4g-1ç	3	4	0.....10	-10.....80	pirinç	NBR	1,38
1/8"	T-GF.100.4-1-2	1g-2ç	4	5,8	0.....9	-10.....80	pirinç	NBR	1,05
1/8"	T-GF.100.4-1-3	1g-3ç	4	5,8	0.....9	-10.....80	pirinç	NBR	1,55
1/8"	T-GF.100.4-1-4	1g-4ç	4	5,8	0.....9	-10.....80	pirinç	NBR	2,05
1/8"	T-GF.100.4-2-1	2g-1ç	4	5,8	0.....9	-10.....80	pirinç	NBR	0,87
1/8"	T-GF.100.4-3-1	3g-1ç	4	5,8	0.....9	-10.....80	pirinç	NBR	1,25
1/8"	T-GF.100.4-4-1	4g-1ç	4	5,8	0.....9	-10.....80	pirinç	NBR	1,48
1/4"	T-GF.101.4-1-2	1g-2ç	4	5,8	0.....9	-10.....80	pirinç	NBR	0,95
1/4"	T-GF.101.4-1-3	1g-3ç	4	5,8	0.....9	-10.....80	pirinç	NBR	1,45
1/4"	T-GF.101.4-1-4	1g-4ç	4	5,8	0.....9	-10.....80	pirinç	NBR	1,95
1/4"	T-GF.101.4-2-1	2g-1ç	4	5,8	0.....9	-10.....80	pirinç	NBR	0,77
1/4"	T-GF.101.4-3-1	3g-1ç	4	5,8	0.....9	-10.....80	pirinç	NBR	1,15
1/4"	T-GF.101.4-4-1	4g-1ç	4	5,8	0.....9	-10.....80	pirinç	NBR	1,38

Size	Type No	explication	Orifice	Kv	Pressure(bar)	Temp.(°C)	Body	Seal	Weight
G	T-GFN Series (N.O)	input/output	(mm)	(Lt/min)	Min Max	Min Max	Brass	---	(kg)
1/8"	T-GFN 100-1-2	1g-2ç	1,8	1,45	0.....12	-10.....80	pirinç	NBR	1,25



1/8"	T-GFN 100-1-3	1g-3ç	1,8	1,45	0.....12	-10.....80	piring	NBR	1,75
1/8"	T-GFN 100-1-4	1g-4ç	1,8	1,45	0.....12	-10.....80	piring	NBR	2,25
1/8"	T-GFN 100-2-1	2g-1ç	1,8	1,45	0.....12	-10.....80	piring	NBR	1,07
1/8"	T-GFN 100-3-1	3g-1ç	1,8	1,45	0.....12	-10.....80	piring	NBR	1,45
1/8"	T-GFN 100-4-1	4g-1ç	1,8	1,45	0.....12	-10.....80	piring	NBR	1,68
1/4"	T-GFN 101-1-2	1g-2ç	1,8	1,45	0.....12	-10.....80	piring	NBR	1,15
1/4"	T-GFN 101-1-3	1g-3ç	1,8	1,45	0.....12	-10.....80	piring	NBR	1,65
1/4"	T-GFN 101-1-4	1g-4ç	1,8	1,45	0.....12	-10.....80	piring	NBR	2,15
1/4"	T-GFN 101-2-1	2g-1ç	1,8	1,45	0.....12	-10.....80	piring	NBR	0,97
1/4"	T-GFN 101-3-1	3g-1ç	1,8	1,45	0.....12	-10.....80	piring	NBR	1,35
1/4"	T-GFN 101-4-1	4g-1ç	1,8	1,45	0.....12	-10.....80	piring	NBR	1,58
1/8"	T-GFN 100.2,5-1-2	1g-2ç	2,5	2,8	0.....10	-10.....80	piring	NBR	1,25
1/8"	T-GFN 100.2,5-1-3	1g-3ç	2,5	2,8	0.....10	-10.....80	piring	NBR	1,75
1/8"	T-GFN 100.2,5-1-4	1g-4ç	2,5	2,8	0.....10	-10.....80	piring	NBR	2,25
1/8"	T-GFN 100.2,5-2-1	2g-1ç	2,5	2,8	0.....10	-10.....80	piring	NBR	1,07
1/8"	T-GFN 100.2,5-3-1	3g-1ç	2,5	2,8	0.....10	-10.....80	piring	NBR	1,45
1/8"	T-GFN 100.2,5-4-1	4g-1ç	2,5	12,8	0.....10	-10.....80	piring	NBR	1,68
1/4"	T-GFN 101.2,5-1-2	1g-2ç	2,5	2,8	0.....10	-10.....80	piring	NBR	1,15
1/4"	T-GFN 101.2,5-1-3	1g-3ç	2,5	2,8	0.....10	-10.....80	piring	NBR	1,65
1/4"	T-GFN 101.2,5-1-4	1g-4ç	2,5	2,8	0.....10	-10.....80	piring	NBR	2,15
1/4"	T-GFN 101.2,5-2-1	2g-1ç	2,5	2,8	0.....10	-10.....80	piring	NBR	0,97
1/4"	T-GFN 101.2,5-3-1	3g-1ç	2,5	2,8	0.....10	-10.....80	piring	NBR	1,35
1/4"	T-GFN 101.2,5-4-1	4g-1ç	2,5	2,8	0.....10	-10.....80	piring	NBR	1,58
1/8"	T-GFN 100.3-1-2	1g-2ç	3	4	0.....5	-10.....80	piring	NBR	1,25

EL

News

ΕΛΛΗΝΙΚΗ
Electrolux
 Macedonia
 Palenzo

1/8"	T-GFN 100.3-1-3	1g-3ç	3	4	0.....5	-10.....80	piring	NBR	1,75
1/8"	T-GFN 100.3-1-4	1g-4ç	3	4	0.....5	-10.....80	piring	NBR	2,25
1/8"	T-GFN 100.3-2-1	2g-1ç	3	4	0.....5	-10.....80	piring	NBR	1,07
1/8"	T-GFN 100.3-3-1	3g-1ç	3	4	0.....5	-10.....80	piring	NBR	1,45
1/8"	T-GFN 100.3-4-1	4g-1ç	3	4	0.....5	-10.....80	piring	NBR	1,68
1/4"	T-GFN 101.3-1-2	1g-2ç	3	4	0.....5	-10.....80	piring	NBR	1,15
1/4"	T-GFN 101.3-1-3	1g-3ç	3	4	0.....5	-10.....80	piring	NBR	1,65
1/4"	T-GFN 101.3-1-4	1g-4ç	3	4	0.....5	-10.....80	piring	NBR	2,15
1/4"	T-GFN 101.3-2-1	2g-1ç	3	4	0.....5	-10.....80	piring	NBR	0,97
1/4"	T-GFN 101.3-3-1	3g-1ç	3	4	0.....5	-10.....80	piring	NBR	1,35
1/4"	T-GFN 101.3-4-1	4g-1ç	3	4	0.....5	-10.....80	piring	NBR	1,58

Electrolux Macedonia
 Bitola/Europe
 +389(0)47 203 330

www.electrolux.mk www.elektroluks.mk www.elektroluks.eu
 electrolux@t-home.mk elektroluks@t-home.mk



T-GFP Series PVC Body, Direct Operated , Group Solenoid Valves



Product code : T-GFP100.....T-GFP101

Brand : TORK

T-GFP Series PVC Body, Direct Operated , Group Solenoid Valves

[TORK PVC Body, Direct Operated 2/2 Way Solenoid Valves, Group Solenoid Valves](#)

[T-GFP Series](#)

normally closed position

Application :	air, water, gas, valve controller
Coil Voltage :	230, 220V, 110V, 24V, 12V AC, 24V, 12V DC
Coil Protection Class :	IP 65 with plug
Way :	2/2 way, normally closed
Seal :	FKM, teflon, on request ; PTFE, NBR, EPDM
Valve Pcs :	3 piece , on request 4 piece solenoid valve
Body of Valve :	PVC
Tube, Internal Part :	stainless steel

Size	Type No	Explication	Orifice (mm)	Kv (Lt/min)	Pressure(bar) Min Max	Temp. (°C) Min Max	Body	Seal
G	T-GFP Series	Input/Output	(mm)	(Lt/min)	Min Max	Min Max	Brass	---
1/8"	T-GFP 100-1-2	1g-2ç	1,8	1,45	0.....16	-10.....80	pvc	NBR
1/8"	T-GFP 100-1-3	1g-3ç	1,8	1,45	0.....16	-10.....80	pvc	NBR
1/8"	T-GFP 100-1-4	1g-4ç	1,8	1,45	0.....16	-10.....80	pvc	NBR
1/8"	T-GFP 100-2-1	2g-1ç	1,8	1,45	0.....16	-10.....80	pvc	NBR

EL

News

Ελεγκόμενος
Electrolux
Macedonia
Palenzo

1/8"	T-GFP 100-3-1	3g-1ç	1,8	1,45	0.....16	-10.....80	pvc	NBR
1/8"	T-GFP 100-4-1	4g-1ç	1,8	1,45	0.....16	-10.....80	pvc	NBR
1/4"	T-GFP 101-1-2	1g-2ç	1,8	1,45	0.....16	-10.....80	pvc	NBR
1/4"	T-GFP 101-1-3	1g-3ç	1,8	1,45	0.....16	-10.....80	pvc	NBR
1/4"	T-GFP 101-1-4	1g-4ç	1,8	1,45	0.....16	-10.....80	pvc	NBR
1/4"	T-GFP 101-2-1	2g-1ç	1,8	1,45	0.....16	-10.....80	pvc	NBR
1/4"	T-GFP 101-3-1	3g-1ç	1,8	1,45	0.....16	-10.....80	pvc	NBR
1/4"	T-GFP 101-4-1	4g-1ç	1,8	1,45	0.....16	-10.....80	pvc	NBR



T-GFE.3W Series 3/2 Way Group Solenoid Valve, Brass Body



Product code : T-GFE.3W 100, T-GFE.3W 101

Brand : TORK

T-GFE.3W Series 3/2 Way Group Solenoid Valve, Brass Body

T-GFE.3W Series Group Valve, TORK Brass Body, Direct Acting 3/2 Way Solenoid Valve, Closed / Normally Open Positions.

Application	:	air, compressor, valve control, water, gas, pneumatic applications
Coil voltage	:	230, 220V, 110V, 24V, 12V AC, 24V, 12V DC
Protection class	:	IP 65 with plug
Body	:	brass
Way	:	3/2 way, normally closed, normally open
Position	:	N.C and N.O.
Seal	:	on request; NBR, EPDM
On request	:	manuel control unit
Tube, Internal Parts	:	stainless steel

Size	Type No	explication	Orifice (mm)	Kv (Lt/min)	Pressure		Temp.(°C)		Seal
					Min	Max	Min	Max	
G	T-GFE Series (N.C)	input/output							--
1/8"	T-GFE.3W.100-1-2	1g-2ç	1,8	1-2=1,45 , 2-3=1,35	0.....12		-10.....80		NBR
1/8"	T-GFE.3W.100-1-3	1g-3ç	1,8	1-2=1,45 , 2-3=1,35	0.....12		-10.....80		NBR



1/8"	T-GFE.3W.100-1-4	1g-4ç	1,8	1-2=1,45 , 2-3=1,35	0.....12	-10.....80	NBR
1/8"	T-GFE.3W.100-2-1	2g-1ç	1,8	1-2=1,45 , 2-3=1,35	0.....12	-10.....80	NBR
1/8"	T-GFE.3W.100-3-1	3g-1ç	1,8	1-2=1,45 , 2-3=1,35	0.....12	-10.....80	NBR
1/8"	T-GFE.3W.100-4-1	4g-1ç	1,8	1-2=1,45 , 2-3=1,35	0.....12	-10.....80	NBR
1/4"	T-GFE.3W.101-1-2	1g-2ç	1,8	1-2=1,45 , 2-3=1,35	0.....12	-10.....80	NBR
1/4"	T-GFE.3W.101-1-3	1 g-3ç	1,8	1-2=1,45 , 2-3=1,35	0.....12	-10.....80	NBR
1/4"	T-GFE.3W.101-1-4	1g-4ç	1,8	1-2=1,45 , 2-3=1,35	0.....12	-10.....80	NBR
1/4"	T-GFE.3W.101-2-1	2g-1ç	1,8	1-2=1,45 , 2-3=1,35	0.....12	-10.....80	NBR
1/4"	T-GFE.3W.101-3-1	3g-1ç	1,8	1-2=1,45 , 2-3=1,35	0.....12	-10.....80	NBR
1/4"	T-GFE.3W.101-4-1	4g-1ç	1,8	1-2=1,45 , 2-3=1,35	0.....12	-10.....80	NBR
1/8"	T-GFE.3W.100.2,5-1-2	1g-2ç	2,5	1-2=2,8 , 2-3=1,35	0.....10	-10.....80	NBR
1/8"	T-GFE.3W.100.2,5-1-3	1g-3ç	2,5	1-2=2,8 , 2-3=1,35	0.....10	-10.....80	NBR
1/8"	T-GFE.3W.100.2,5-1-4	1g-4ç	2,5	1-2=2,8 , 2-3=1,35	0.....10	-10.....80	NBR
1/8"	T-GFE.3W.100.2,5-2-1	2g-1ç	2,5	1-2=2,8 , 2-3=1,35	0.....10	-10.....80	NBR
1/8"	T-GFE.3W.100.2,5-3-1	3g-1ç	2,5	1-2=2,8 , 2-3=1,35	0.....10	-10.....80	NBR
1/8"	T-GFE.3W.100.2,5-4-1	4g-1ç	2,5	1-2=2,8 , 2-3=1,35	0.....10	-10.....80	NBR
1/4"	T-GFE.3W.101.2,5-1-2	1g-2ç	2,5	1-2=2,8 , 2-3=1,35	0.....10	-10.....80	NBR
1/4"	T-GFE.3W.101.2,5-1-3	1g-3ç	2,5	1-2=2,8 , 2-3=1,35	0.....10	-10.....80	NBR
1/4"	T-GFE.3W.101.2,5-1-4	1g-4ç	2,5	1-2=2,8 , 2-3=1,35	0.....10	-10.....80	NBR
1/4"	T-GFE.3W.101.2,5-2-1	2g-1ç	2,5	1-2=2,8 , 2-3=1,35	0.....10	-10.....80	NBR
1/4"	T-GFE.3W.101.2,5-3-1	3g-1ç	2,5	1-2=2,8 , 2-3=1,35	0.....10	-10.....80	NBR
1/4"	T-GFE.3W.101.2,5-4-1	4g-1ç	2,5	1-2=2,8 , 2-3=1,35	0.....10	-10.....80	NBR

Size	Type No	explication	Orifice	Kv	Pressure	Temp.(°C)	Seal
------	---------	-------------	---------	----	----------	-----------	------



G	T-GFEN.3W Series (N.O)	input/output	(mm)	(Lt/min)	Min	Max	Min	Max	---
1/8"	T-GFEN.3W.100-1-2	1g-2ç	1,8	1-2=1,45 , 2-3=1,35	0.....12	-10.....80			NBR
1/8"	T-GFEN.3W.100-1-3	1g-3ç	1,8	1-2=1,45 , 2-3=1,35	0.....12	-10.....80			NBR
1/8"	T-GFEN.3W.100-1-4	1g-4ç	1,8	1-2=1,45 , 2-3=1,35	0.....12	-10.....80			NBR
1/8"	T-GFEN.3W.100-2-1	2g-1ç	1,8	1-2=1,45 , 2-3=1,35	0.....12	-10.....80			NBR
1/8"	T-GFEN.3W.100-3-1	3g-1ç	1,8	1-2=1,45 , 2-3=1,35	0.....12	-10.....80			NBR
1/8"	T-GFEN.3W.100-4-1	4g-1ç	1,8	1-2=1,45 , 2-3=1,35	0.....12	-10.....80			NBR
1/4"	T-GFEN.3W.101-1-2	1g-2ç	1,8	1-2=1,45 , 2-3=1,35	0.....12	-10.....80			NBR
1/4"	T-GFEN.3W.101-1-3	1g-3ç	1,8	1-2=1,45 , 2-3=1,35	0.....12	-10.....80			NBR
1/4"	T-GFEN.3W.101-1-4	1g-4ç	1,8	1-2=1,45 , 2-3=1,35	0.....12	-10.....80			NBR
1/4"	T-GFEN.3W.101-2-1	2g-1ç	1,8	1-2=1,45 , 2-3=1,35	0.....12	-10.....80			NBR
1/4"	T-GFEN.3W.101-3-1	3g-1ç	1,8	1-2=1,45 , 2-3=1,35	0.....12	-10.....80			NBR
1/4"	T-GFEN.3W.101-4-1	4g-1ç	1,8	1-2=1,45 , 2-3=1,35	0.....12	-10.....80			NBR
1/8"	T-GFEN.3W.100.2,5-1-2	1g-2ç	2,5	1-2=2,8 , 2-3=1,35	0.....10	-10.....80			NBR
1/8"	T-GFEN.3W.100.2,5-1-3	1g-3ç	2,5	1-2=2,8 , 2-3=1,35	0.....10	-10.....80			NBR
1/8"	T-GFEN.3W.100.2,5-1-4	1g-4ç	2,5	1-2=2,8 , 2-3=1,35	0.....10	-10.....80			NBR
1/8"	T-GFEN.3W.100.2,5-2-1	2g-1ç	2,5	1-2=2,8 , 2-3=1,35	0.....10	-10.....80			NBR
1/8"	T-GFEN.3W.100.2,5-3-1	3g-1ç	2,5	1-2=2,8 , 2-3=1,35	0.....10	-10.....80			NBR
1/8"	T-GFEN.3W.100.2,5-4-2	4g-2ç	2,5	1-2=2,8 , 2-3=1,35	0.....10	-10.....80			NBR
1/4"	T-GFEN.3W.101.2,5-1-2	1g-2ç	2,5	1-2=2,8 , 2-3=1,35	0.....10	-10.....80			NBR
1/4"	T-GFEN.3W.101.2,5-1-3	1g-3ç	2,5	1-2=2,8 , 2-3=1,35	0.....10	-10.....80			NBR
1/4"	T-GFEN.3W.101.2,5-1-4	1g-4ç	2,5	1-2=2,8 , 2-3=1,35	0.....10	-10.....80			NBR
1/4"	T-GFEN.3W.101.2,5-2-1	2g-1ç	2,5	1-2=2,8 , 2-3=1,35	0.....10	-10.....80			NBR
1/4"	T-GFEN.3W.101.2,5-3-1	3g-1ç	2,5	1-2=2,8 , 2-3=1,35	0.....10	-10.....80			NBR



EL
News

Ελεγκτήρας
Electrolux
Macedonia
Palenzo

1/4" T-GFEN.3W.101.2,5-4-1 4g-1ç 2,5 1-2=2,8 , 2-3=1,35 0.....10 -10.....80 NBR